



TO LET



The Manse High Street, Castle Camps, Cambs, CB21 4SN

£1,550 PCM

**Balmforth**

Estate Agents, Valuers & Letting Agents

- 4 Bedroom Detached
- Recently redecorated
- Garage
- Village location
- Recently refurbished kitchen
- Off road parking

## THE PROPERTY

A well presented, recently redecorated family home is available in a village location. Downstairs, there are 3 reception rooms, recently refurbished kitchen and cloakroom. 4 double bedrooms and family bathroom are upstairs. Good size rear garden, garage and off road parking for multiple vehicles. Available now

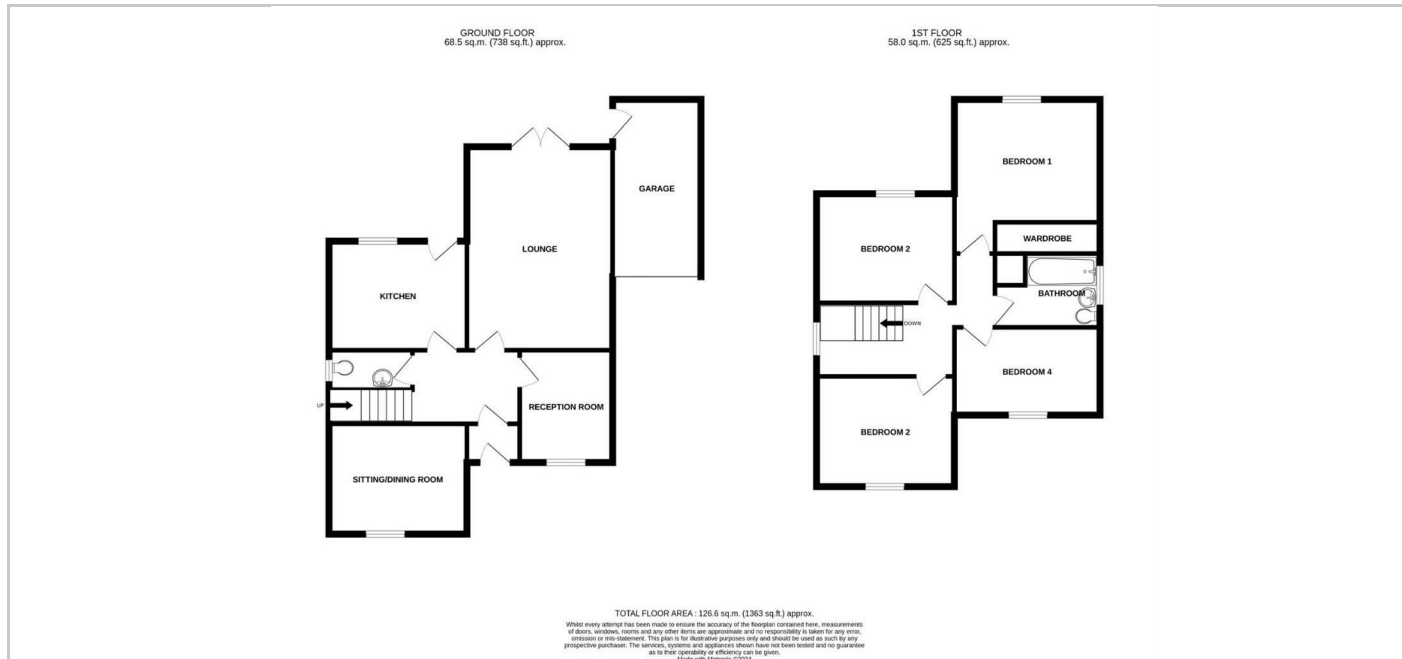

## SITUATION

## Directions