

TO LET

54 Fleming Way, Haverhill, Suffolk, CB9 7SQ

£1,295 PCM

Balmforth

Estate Agents, Valuers & Letting Agents

- THREE BEDROOMS
- ARBORETUM DEVELOPMNENT
- KITCHEN/BREAKFAST ROOM
- OFF ROAD PARKING
- AVAILABLE NOW
- END OF TERRACE FAMILY HOME
- LOUNGE/DINER
- EN-SUITE TO MAIN BEDROOM + CLOAKROOM + FAMILY BATHROOM
- ENCLOSED GARDEN TO REAR
- EPC 'B' COUNCIL TAX BAND 'C'

THE PROPERTY

Balmforth are delighted to offer to rent this well presented three bedroom end of terrace family home with accommodation comprising entrance hallway, kitchen/diner, lounge and cloakroom to the ground floor. There are three bedrooms to the first floor, en-suite to main bedroom and family bathroom. Externally there is off road parking and enclosed rear garden. Available now.

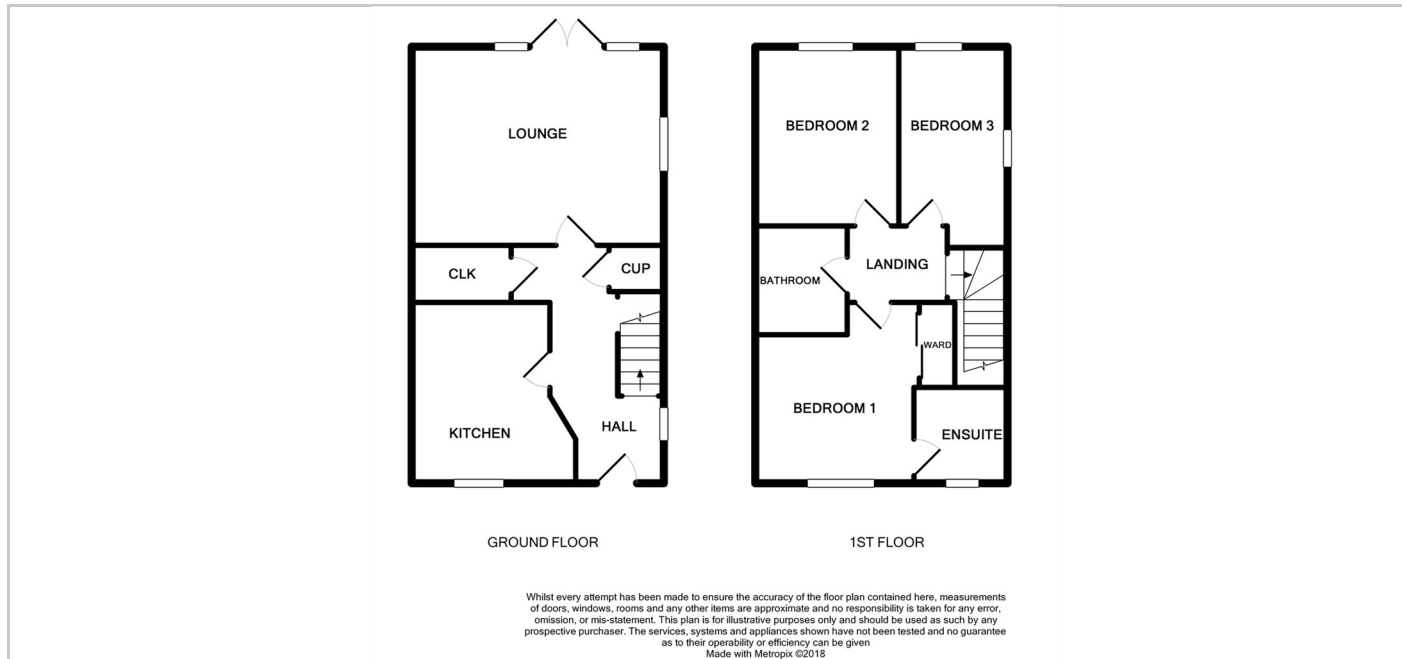

SITUATION

Directions