

balmforth

Estate & Letting Agents



7a Queen Street

Suffolk, CB9 9DZ

Price £130,000



7a Queen Street

Suffolk, CB9 9DZ

Price £130,000



ENTRANCE HALL

Carpet flooring. With doors to :-

OPEN PLAN LOUNGE/KITCHEN/DINER

20' 5" x 12' 11"

Large window over looking un disturbed views market square of Haverhill. Carpet flooring. Wood effect flooring laid in kitchen facilities. Fitted work benches with space for appliances.

BEDROOM

11' 10" x 8' 6"

Carpet flooring. Double bedroom. Window. Radiator.

SHOWER ROOM

7' 5" x 5' 7"

Matching white w/c and sink unit. Shower cubicle. Storage cupboard. Window. Extractor fan.

LEASE DETAILS

125 years from 29 April 2005

SERVICE CHARGE

Service charge + Ground rent £650.00 as of 2022/23

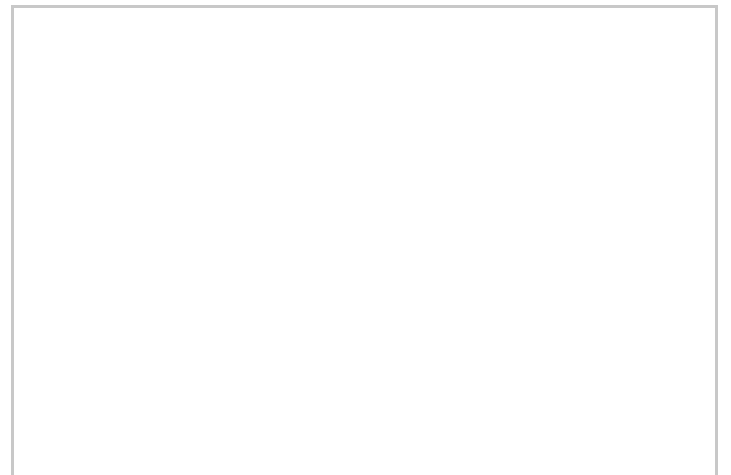
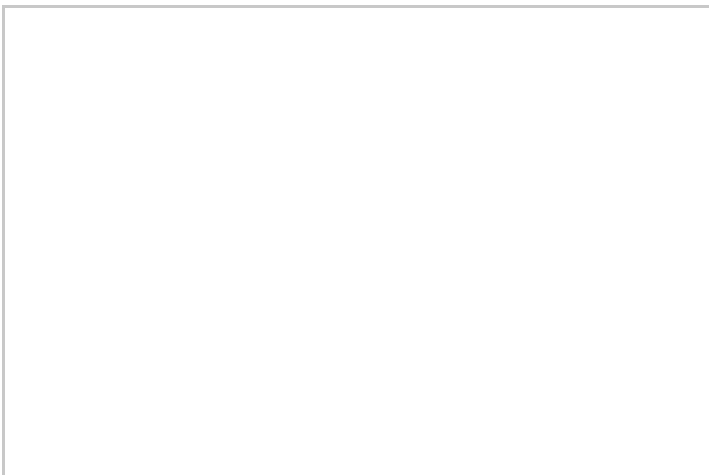
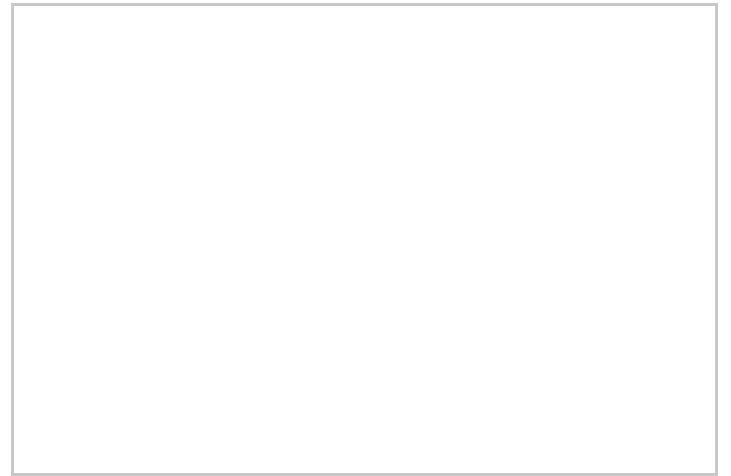
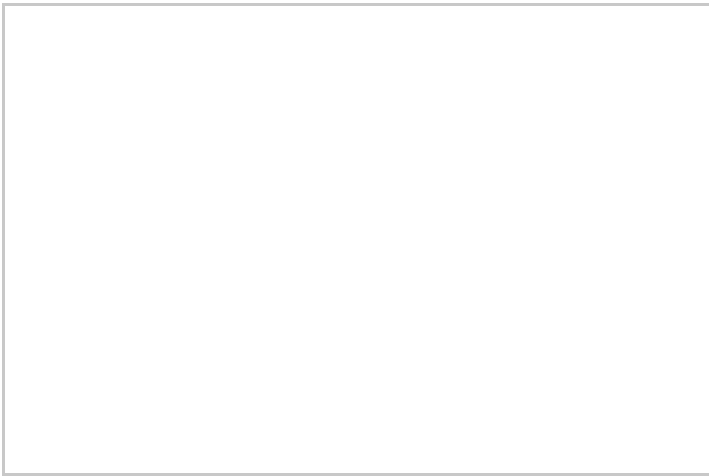
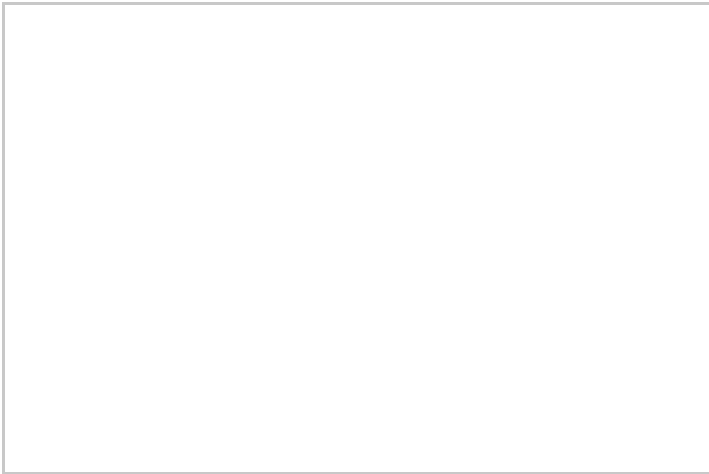
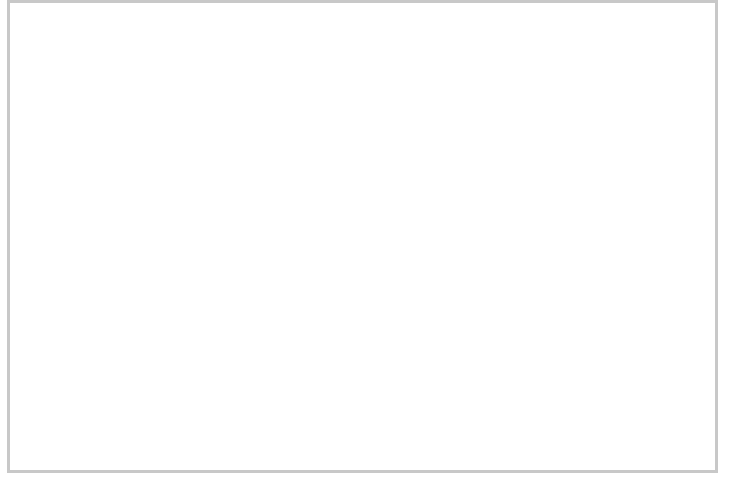
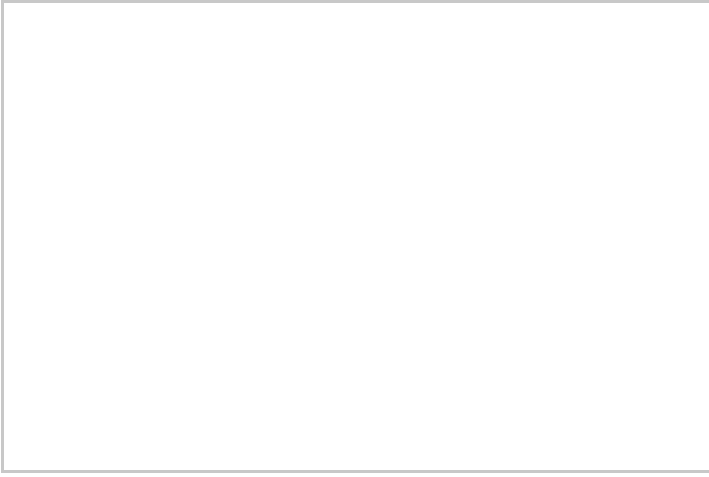

Road Map



Hybrid Map



Terrain Map



Floor Plan

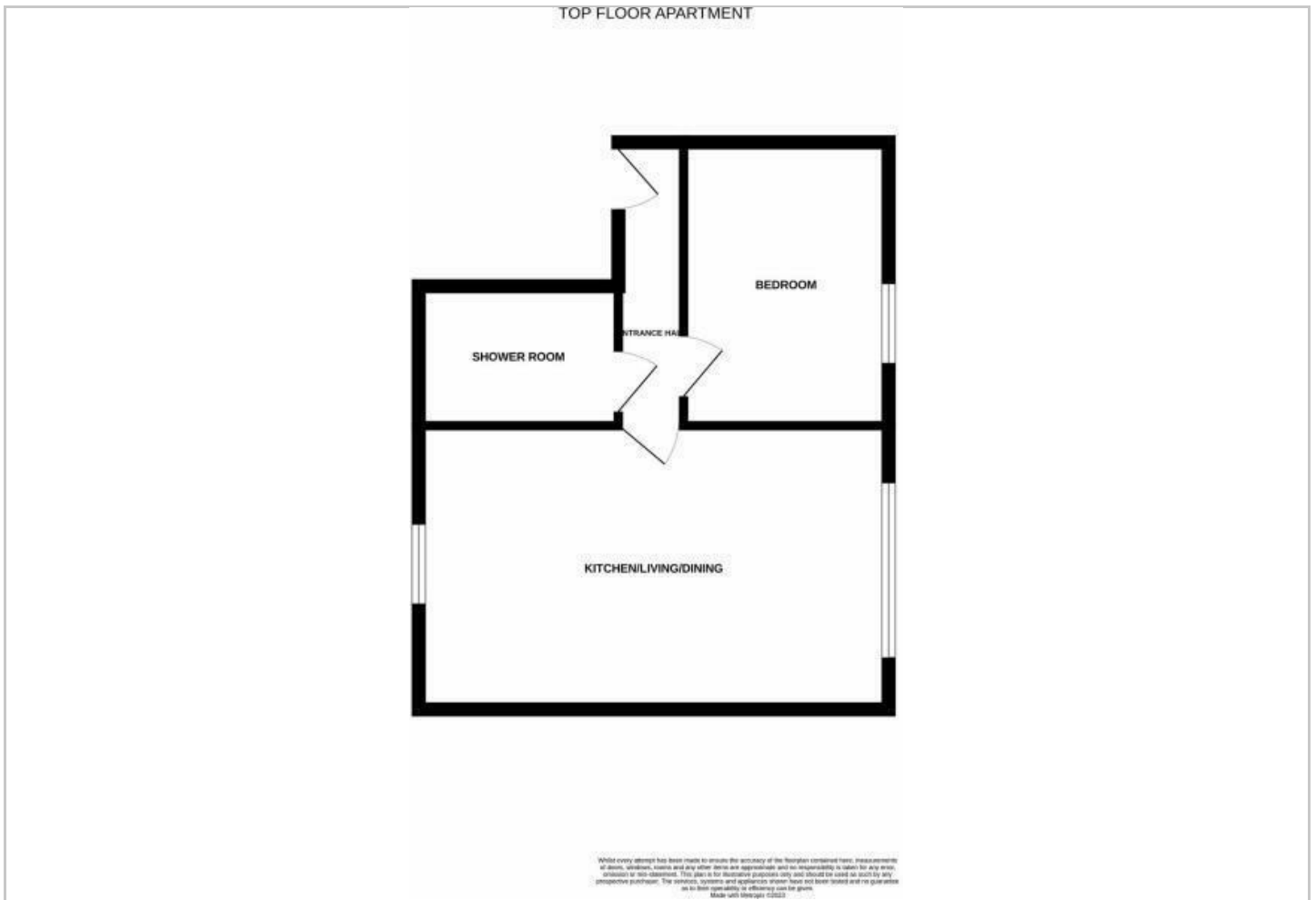

Viewing

Please contact our office on 01440 707976 if you wish to arrange a viewing appointment for this property or require further information.

Energy Efficiency Graph

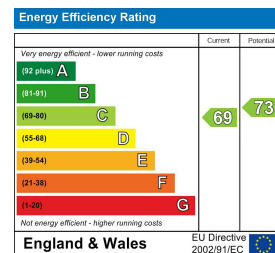

These particulars, whilst believed to be accurate are set out as a general outline only for guidance and do not constitute any part of an offer or contract. Intending purchasers should not rely on them as statements of representation of fact, but must satisfy themselves by inspection or otherwise as to their accuracy. No person in this firm's employment has the authority to make or give any representation or warranty in respect of the property.