

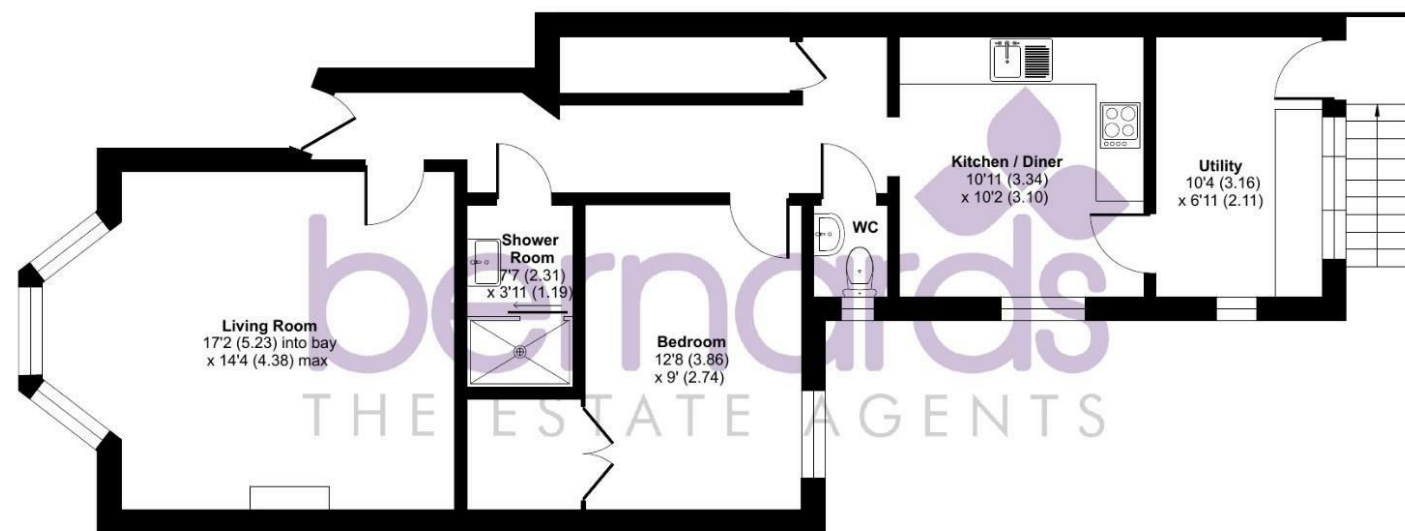

## St. Ronans Road, Southsea, PO4

Approximate Area = 742 sq ft / 68.9 sq m  
For identification only - Not to scale



GROUND FLOOR

Floor plan produced in accordance with RICS Property Measurement 2nd Edition, Incorporating International Property Measurement Standards (IPMS2 Residential). © nichicom 2025. Produced for Bernard's Estate and Letting Agents Ltd. REF: 1385456

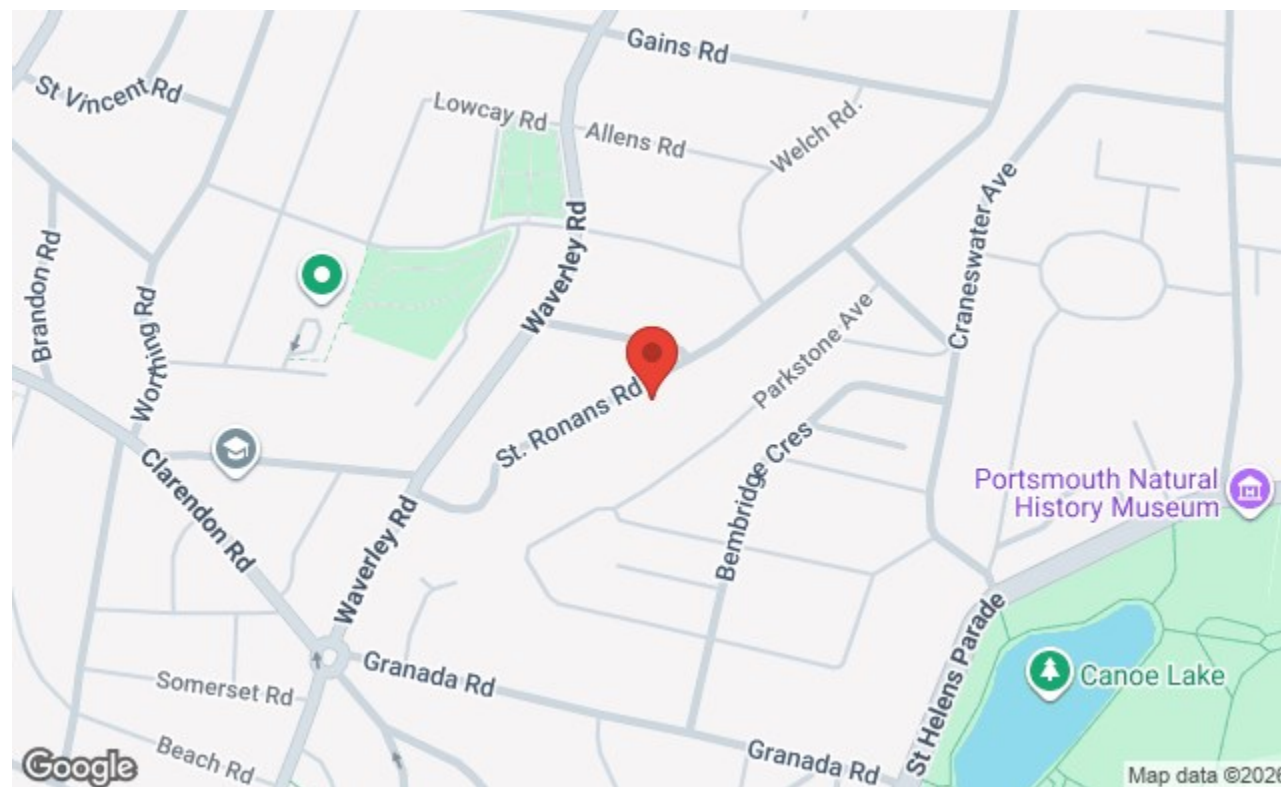

8 Clarendon Road, Southsea, Hampshire, PO5 2EE  
t: 02392 864 974



FOR SALE

£210,000

St. Ronans Road, Southsea PO4 OPT

bernard's  
THE ESTATE AGENTS



## HIGHLIGHTS

- ❖ ONE DOUBLE BEDROOM
- ❖ GARDEN FLAT
- ❖ SHARE OF FREEHOLD
- ❖ BEAUTIFULLY PRESENTED
- ❖ IDEAL FIRST TIME BUY
- ❖ SOUTHSEA LOCATION
- ❖ HALL FLOOR
- ❖ STUNNING THROUGHOUT
- ❖ SOUGHT AFTER LOCATION
- ❖ LARGE APARTMENT

**\*\* GARDEN FLAT WITH SHARE OF THE FREEHOLD \*\***

We are pleased to present this deceptively spacious, one bedroom garden flat located in the heart of Southsea with easy access to the Seafront, local shops & restaurants.

Beautifully presented throughout, the property consists of a bright and airy bay-fronted lounge, a tasteful bedroom with built in wardrobe space, a modern shower-room with separate WC, large kitchen/diner and a handy

utility/office space to the rear. Moving outside you'll find a very generously sized private garden wrapping around the property.

Offered with a share of the freehold, this home presents a wonderful opportunity as a first time buy, investment, or anyone looking for a stunning flat in central Southsea.

Call today to arrange a viewing

02392 864 974

[www.bernardsestates.co.uk](http://www.bernardsestates.co.uk)





# PROPERTY INFORMATION

**LOUNGE**  
17'1" x 14'4" (5.23 x 4.38)

**BEDROOM**  
12'7" x 8'11" (3.86 x 2.74)

**KITCHEN / DINER**  
10'11" x 10'2" (3.34 x 3.10)

**UTILITY**  
10'4" x 6'11" (3.16 x 2.11)

**SHOWER ROOM**  
7'6" x 3'10" (2.31 x 1.19)

## ANTI-MONEY LAUNDERING (AML)

Bernards Estate agents have a legal obligation to complete anti-money laundering checks. The AML check should be completed in branch. Please call the office to book an AML check if you would like to make an offer on this property. Please note the AML check includes taking a copy of the two forms of identification for each purchaser. A proof of address and proof of name document is required. Please note we cannot put forward an offer without the AML check being completed

## BERNARDS MORTGAGE & PROTECTION

We have a team of advisors covering all our offices, offering a comprehensive range of mortgages from across the market and various protection products from a panel of lending insurers. Our fee is competitively priced, and we can help advise and arrange mortgages and protection for anyone, regardless of who they are buying and selling through.

If you're looking for advice on borrowing power, what interest rates you are eligible for, submitting an agreement in principle, placing the full mortgage application, and ways to protect your health, home, and income, look no further!

## COUNCIL TAX BAND A

Portsmouth City Council: BAND A

**LEASEHOLD INFORMATION**  
Lease Length: 88 Years Ground Rent: £0.00 Service Charge: £600.00  
Please note that Bernard's Estate Agents have not checked or verified the lease terms or the service

charge/ground rent costs. The information provided above has been provided to us from the Seller. Your solicitor will check all of the above during the conveyancing process and you should only rely on information provided by them when making the final decision as to whether to buy any leasehold property.

**OFFER CHECK PROCEDURE -**  
If you are considering making an offer for this or any other property we are marketing, please make early contact with your local office to enable us to verify your buying position. Our Sellers expect us to report on a Buyer's proceedability whenever we submit an offer. Thank you.

## PROPERTY TENURE

Leasehold - Share of Freehold

**REMOVAL QUOTES**  
As part of our drive to assist clients with all aspects of the moving process, we have sourced a reputable removal company. Please ask a member of our sales team for further details and a quotation.

**SOLICITOR**  
Choosing the right conveyancing solicitor is extremely important to ensure that you obtain an effective yet cost-efficient solution. The lure of supposedly cheaper on-line "conveyancing warehouse" style services can be very difficult to ignore but this is a route fraught with problems that we strongly urge you to avoid. A local, established and experienced conveyancer will safeguard your interests and get the job done in a timely manner. Bernards can recommend several local firms of solicitors who have the necessary local knowledge and will provide a personable service. Please ask a member of our sales team for further details.



Energy Efficiency Rating		
	Current	Potential
Very energy efficient - lower running costs		
(92 plus) A		
(81-91) B		
(69-80) C		
(55-68) D		
(39-54) E		
(21-38) F		
(1-20) G		
Not energy efficient - higher running costs		
EU Directive 2002/91/EC		
England & Wales		



Call today to arrange a viewing  
02392 864 974  
www.bernardsestates.co.uk

