

TO
LET

£1,450 PCM

Isambard Brunel Road, Portsmouth, PO
2RX



HIGHLIGHTS

- ❖ TWO BEDROOMS
- ❖ MODERN THROUGHOUT
- ❖ GOOD SIZE LOUNGE/ KITCHEN AREA
- ❖ MODERN LIVING
- ❖ CLOSE TO TRAIN STATION
- ❖ CLOSE TO PORTSMOUTH CITY CENTRE
- ❖ AVAILABLE JULY 2025
- ❖ SUITABLE FOR STUDENTS
- ❖ FIFTH FLOOR
- FURNISHED

TWO BEDROOM APARTMENT WITH BILLS INCLUDED

We are delighted to welcome to the market this modern two bedroom flat in the sought after location of Central Portsmouth. Enterprise House is a development of apartments which boast a high quality modern finish throughout, with high gloss kitchens and contemporary bathrooms.

The location is a stones throw from Portsmouth's main train station and is in walking distance to the University of Portsmouth, city centre and the popular Guildhall Walk strip of bars and restaurants.

Please note that the floorplan indicates the example layout, actual layout may vary

Situated perfectly for students or professionals

 2  1  1

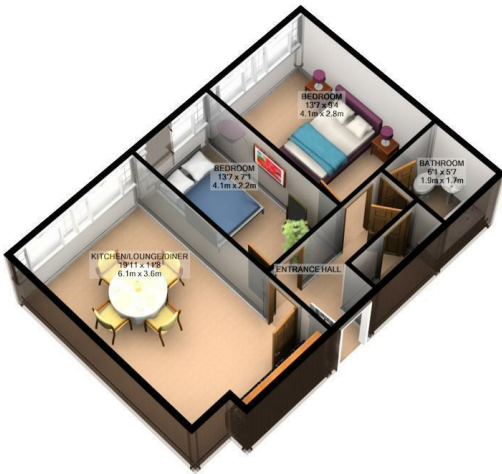

TOTAL APPROX. FLOOR AREA 551 SQ.FT. (51.1 SQ.M.)

For illustrative purposes only. Decorative finishes, fixtures, fittings and furnishings do not represent the current state of the property. Measurements are approximate. Not to scale
Made with Metropix ©2018

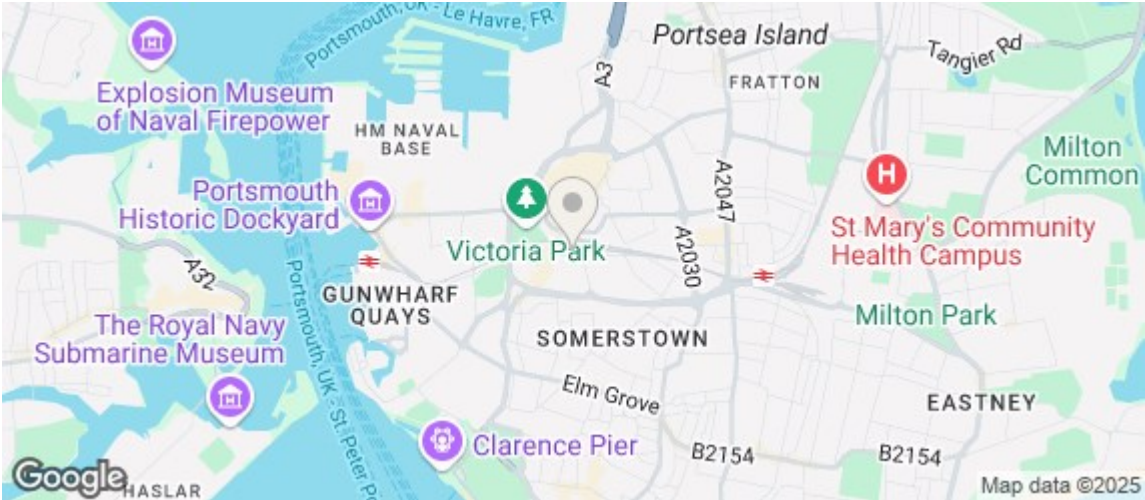

Energy Efficiency Rating		
	Current	Potential
Very energy efficient - lower running costs		
(92 plus) A		
(81-91) B		
(69-80) C		
(55-68) D	67	67
(39-54) E		
(21-38) F		
(1-20) G		
Not energy efficient - higher running costs		
England & Wales		
EU Directive 2002/91/EC		

