

£900 Per Calendar Month

Isambard Brunel Road, Portsmouth  
PO1 2RX

**bernards**  
THE ESTATE AGENTS



## HIGHLIGHTS

- ❖ ONE BEDROOM APARTMENT
- ❖ CITY CENTER
- ❖ CLOSE TO TRAIN STATION FOR COMMUTE
- ❖ CLOSE TO UNIVERSITY
- ❖ COMMUNAL WIFI
- ❖ AVAILABLE LATE SEPTEMBER
- ❖ FURNISHED
- ❖ IDEAL FOR STUDENT OR PROFESSIONAL

**\*\*ONE BEDROOM APARTMENT IN CITY CENTER\*\***

We are delighted to welcome to the market this one bedroom flat in the sought after location of Central Portsmouth. Enterprise House is a development of apartments which boast a high quality modern finish throughout, with high gloss kitchens and contemporary bathrooms.

The location is a stones throw from

Portsmouth's main train station and is in walking distance to the University of Portsmouth, city centre and the popular Guildhall Walk strip of bars and restaurants.

Available from late September.

**\*PLEASE NOTE, PHOTOS SHOWN ARE NOT OF THE EXACT FLAT BUT OF ONE SIMILAR & A SIMILAR LAYOUT\***

Call today to arrange a viewing  
02392 864 974

[www.bernardsestates.co.uk](http://www.bernardsestates.co.uk)





Call today to arrange a viewing  
02392 864 974  
[www.bernardsestates.co.uk](http://www.bernardsestates.co.uk)



# PROPERTY INFORMATION

## Tenant Fees Act 2019

As well as paying the rent, you may also be required to make the following permitted payments.

For properties in England, the Tenant Fees Act 2019 means that in addition to rent, lettings agents can only charge tenants (or anyone acting on the tenant's behalf) the following permitted payments:

- Holding deposits (a maximum of 1 week's rent);
- Deposits (a maximum deposit of 5 weeks' rent for annual rent below £50,000, or 6 weeks' rent for annual rental of £50,000 and above);
- Payments to change a tenancy agreement eg. change of sharer (capped at £50 or, if higher, any reasonable costs);
- Payments associated with early termination of a tenancy (capped at the landlord's loss or the agent's reasonably incurred costs);
- Where required, utilities (electricity, gas or other fuel, water, sewerage), communication services (telephone, internet, cable/satellite television), TV licence;
- Council tax (payable to the billing authority);

· Interest payments for the late payment of rent (up to 3% above Bank of England's annual percentage rate);

- Reasonable costs for replacement of lost keys or other security devices;
- Contractual damages in the event of the tenant's default of a tenancy agreement; and
- Any other permitted payments under the Tenant Fees Act 2019 and regulations applicable at the relevant time.

## Right to Rent

Each applicant will be subject to the right to rent checks. This is a government requirement since February 2016. We are required to check and take a copy of the original version of acceptable documentation in order to adhere to the Right to rent checks. This will be carried out at referencing stage. Please speak to a member of staff for acceptable Identification.

## Removal Quotes

As part of our drive to assist clients with all aspects of the moving process, we have sourced a reputable removal company. Please ask a member of our sales team for further details and a quotation.

## Council Tax Band A

Energy Efficiency Rating		Current	Potential
Very energy efficient - lower running costs			
(92 plus) A			
(81-91) B			
(69-80) C			
(55-68) D			
(39-54) E			
(21-38) F			
(1-20) G			
Not energy efficient - higher running costs			
England & Wales		EU Directive 2002/91/EC	



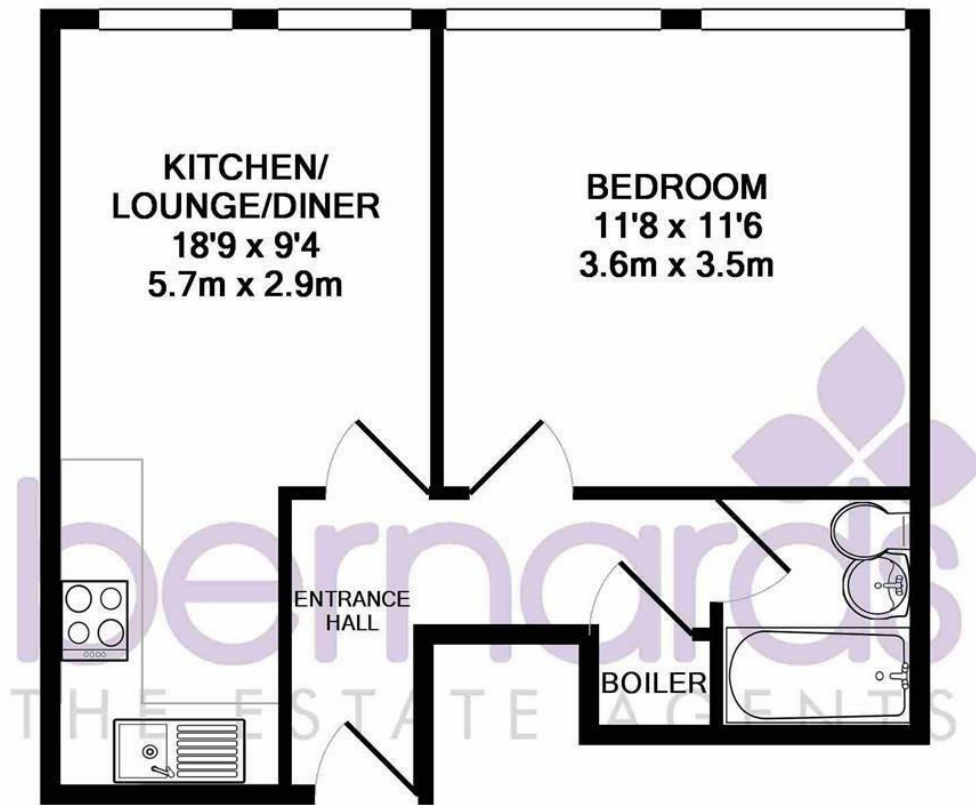

TOTAL APPROX. FLOOR AREA 367 SQ.FT. (34.1 SQ.M.)

Whilst every attempt has been made to ensure the accuracy of the floor plan contained here, measurements of doors, windows, rooms and any other items are approximate and no responsibility is taken for any error, omission, or mis-statement. This plan is for illustrative purposes only and should be used as such by any prospective purchaser. The services, systems and appliances shown have not been tested and no guarantee as to their operability or efficiency can be given

Made with Metropix ©2017

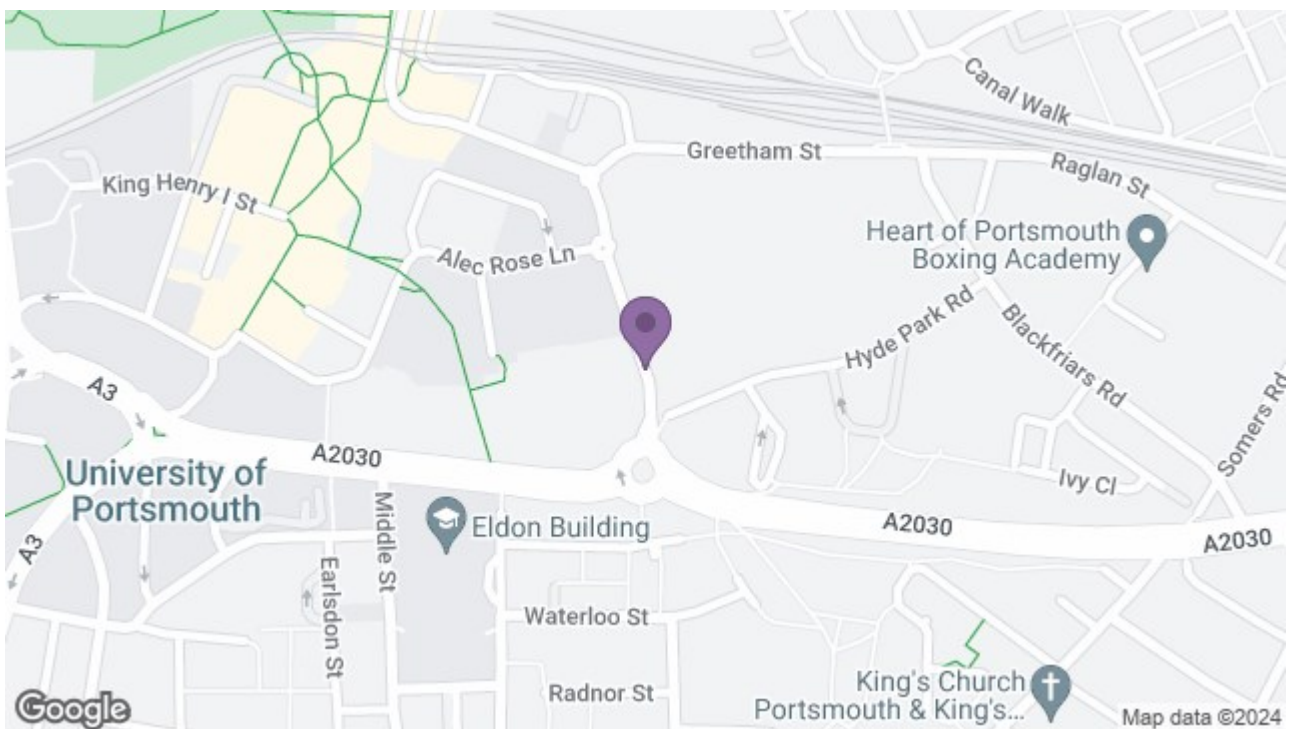

8 Clarendon Road, Southsea, Hampshire, PO5 2EE

t: 02392 864 974

