



175 Regent Street, Kettering NN16 8QH
£165,000

A wonderful two bedroom Victorian town house located in a popular area offered for sale with NO UPWARD CHAIN. The property is very well presented and benefits from a modern fitted kitchen with built in appliance, a modern shower room/wc, gas central heating, double glazed, recently redecorated and new carpets fitted and accommodation comprising of porch, hall, dining room, lounge with log burner, kitchen, landing, two bedrooms and shower room/wc. There is a large rear garden with very useful outside wc and good size store/workshop. Located for ease of access to many facilities to include schools, shops and open park land. Viewing essential

Tenure: Freehold
Energy Rating: D
Council Tax Band: A

LUCAS
SALES & LETTINGS

GROUND FLOOR

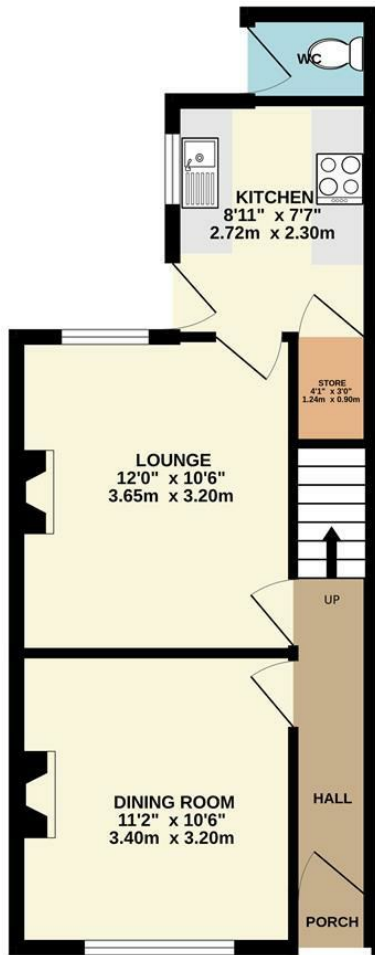

1ST FLOOR

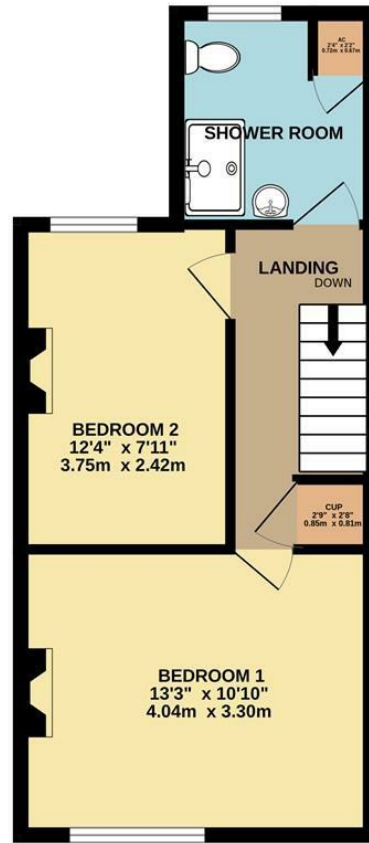

Whilst every attempt has been made to ensure the accuracy of the floorplan contained here, measurements of doors, windows, rooms and any other items are approximate and no responsibility is taken for any error, omission or mis-statement. This plan is for illustrative purposes only and should be used as such by any prospective purchaser. The services, systems and appliances shown have not been tested and no guarantee as to their operability or efficiency can be given.
Made with Metroplan ©2024

- No Upward Chain
- Two Double Bedrooms
- Large Garden
- Double Glazed
- Gas Central Heating
- Modern Fitted Kitchen and Shower Room
- Well Presented Throughout
- Great Location

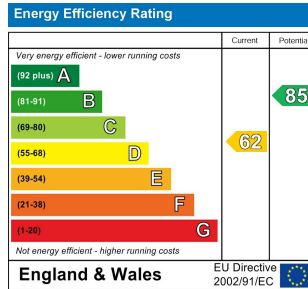

2 Silver Street, Kettering,
Northamptonshire, NN16 0BN
Tel: 01536 312 600

sales@lucasestateagents.co.uk

Important: We would like to inform prospective purchasers that these sales particulars have been prepared in good faith as a general guide only. A survey has not been carried out, nor the services, appliances and fittings tested. All measurements are approximate; sizes should not be relied upon for furnishing, or any other purposes. Floor plans are for guidance and illustration purposes only and are not to scale. Photos are taken with a wide angle lens. Items shown in the photographs are expressly excluded unless agreed otherwise in writing. If there are any matters likely to affect your decision to buy, please contact us before viewing the property and clarify all matters prior to offer. L786

LUCAS
SALES & LETTINGS