



Winfarthing Court, Ship Lane, Ely

+44 (0) 1223 508050

lettings@cookecurtis.co.uk

www.cookecurtis.co.uk

A two bedroom, second floor apartment located within walking distance of the centre of Ely. Set in the ever popular Winfarthing Court development, the property is only a short walk to the railway station, making it a great choice for commuters.

£995 pcm

Ship Lane, Ely  
CB7 4EZ



Ideally situated near the serene riverbanks and the bustling city centre, this two bedroom, top floor apartment comes part-furnished and is well suited for a single professional or couple.

The building is accessed via secure communal door with stairs leading to the apartment. The property comprises of entrance hall with kitchen immediately to your left. The kitchen is spacious and has integrated appliances, such as oven and hob, fridge / freezer, dishwasher and washing machine. There is also plenty of cupboard and worktop space.



Opposite the kitchen is the family bathroom, with three piece suite and shower over the bath. There are two bedrooms, one double and one single, plus a spacious living room.

Externally, the property has off road parking for residents of the development.

Available 1st October 2024 for a single professional or couple.





55 sqm / 592 sqft

---

2 bed, 1 bath, 1 recep

---

Council tax band - A

---

EPC - D / 68

---

Electric heating

---

Off road parking

---

Part furnished

---

Available October 2024

---



## Top Floor

Approx. 52.5 sq. metres (565.6 sq. feet)

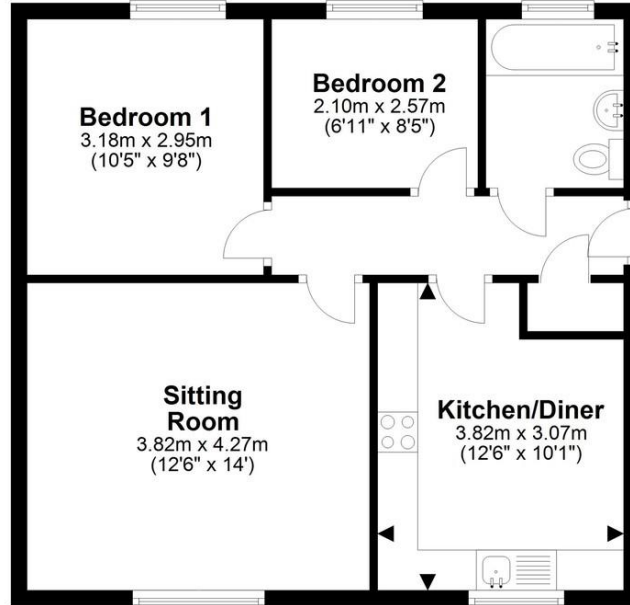

Total area: approx. 52.5 sq. metres (565.6 sq. feet)

Drawings are for guidance only.  
Plan produced using PlanUp.

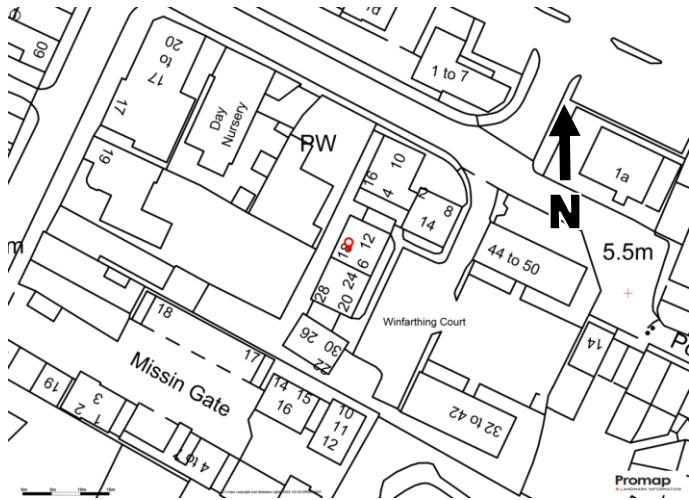

Ely is a small, beautiful and historic city nestled in the Fenland landscape and enjoys glorious waterfronts along the River Ouse and a well renowned traditional market. It has the advantages of a city but has the feel of a community-spirited village. Famous for its cathedral, 'The Ship of The Fens', although small, it is well served with major supermarkets, shops including many of which are independent, modern social and sporting facilities, traditional pubs restaurants as well as those more contemporary. There are many great schooling options including the well-regarded King's School. An excellent mainline train station and close proximity to major road networks makes Ely a great choice for commuters to Cambridge, surrounding areas and even to London.

COOKE  
CURTIS  
& CO