



The Belvedere, Homerton Street

+44 (0) 1223 508050

lettings@cookecurtis.co.uk

www.cookecurtis.co.uk

A rare and sought after three bedroomed second floor apartment with city views in a secure gated prestigious development. With concierge service, onsite gym, swimming pool and spa facilities along with allocated parking and convenient location for Cambridge train station, city centre, Addenbrookes and the Biomedical Campus.

£2,400 pcm

Homerton Street,
Cambridge, CB2 0NT



Situated on the second floor of the iconic tower at The Belvedere, this spacious three bedroomed apartment offers exceptional luxury accommodation in the heart of Cambridge city centre. Built in 2006 the development has landscaped communal gardens with water features and concierge service along with a resident only leisure suite comprising of an Ozone treated swimming pool, steam room, fully equipped gym and a residents' lounge which can be booked for private meetings, parties etc.

The apartment has been well maintained, is double glazed and has underfloor heating throughout. There is a welcoming entrance hall with bookcases leading into the open planned living space with ample room for relaxing and dining, with the added feature of a balcony with cityscape views. There is a contemporary kitchen with high gloss units and designer block polished granite worktop, there is an integrated fridge freezer, microwave, oven and hob, washer dryer, dishwasher and striking Kuppertsbusch extractor fan over.



There is a family bathroom with white modern suite including a bath with over shower, glass shelving and long storage cupboard, and three large double bedrooms, all with large built-in lit wardrobes, one with an attractive ensuite shower room.

Entrance to the development and leisure suite is by resident's fob only and there is a manned reception at the Homerton Street entrance making it very secure and peaceful. There is lift access to the apartment and down to the secure gated undercroft parking with allocated parking for one car and resident bicycle and refuse stores.

Available now. Sorry, no pets permitted in the development. No students.





1330sqft / 123sqm

3 bed, 2 bath, 1 recep

EPC - B / 86

Council tax band - G

Gas central heating

Allocated parking

Swimming pool & gym

Available now



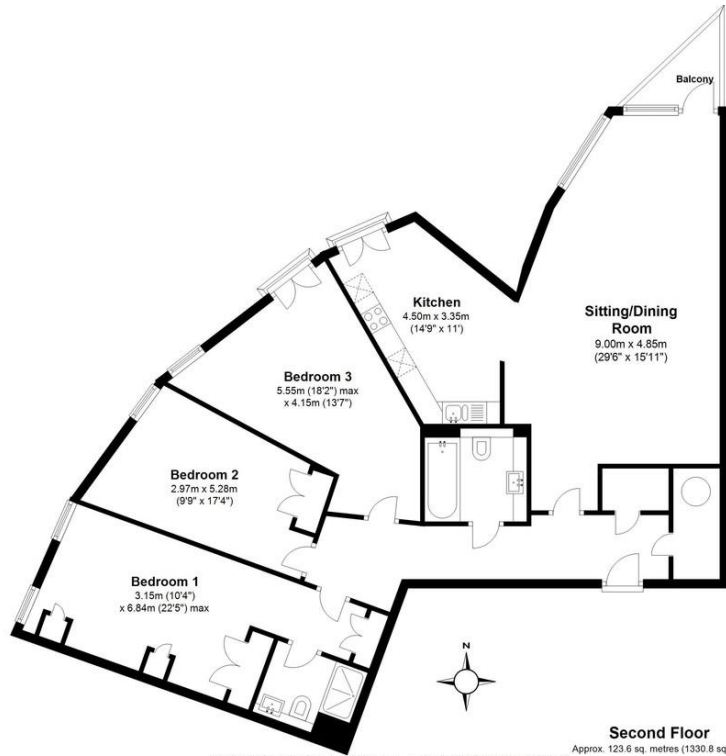

Total area: approx. 123.6 sq. metres (1330.8 sq. feet)

Approx. 123.6 sq. metres (1330.8 sq. feet)

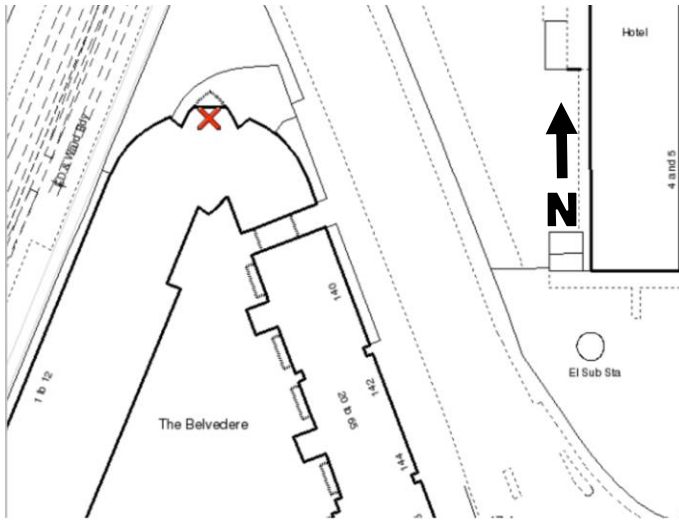

The Belvedere is a prestigious building located on Homerton Street in the southern edge of the city centre. Convenient for commuters as it sits only 0.5 miles from Cambridge Train Station with regular trains to London taking under an hour to reach the capital. Addenbrooke's Hospital and the Biomedical Campus is 1 mile away and there is access out to junction 11 of the M11 approx. 3 miles away. There is an excellent range of facilities in the locality, including banks, lunch time eateries, a post office and small supermarkets along with the cinema and leisure complex adjacent to the building. There are also several public houses and restaurants on the near by Hills Road.

COOKE
CURTIS
& CO