

linkagency



Carlton Apartments, Goole, DN14 6DG  
£525 PCM



# Carlton Apartments

## DN14 6DG, Goole

- Brand new development
- Great transport links
- Intercom
- Close to all amenities
- Ideal for a single professional

This one bedroom flat is located within Carlton Apartments, Goole's newest development and the first substantial new build in the town centre for 15 years. The site is close to all amenities, tenants can reach the M62 in five minutes and are a short walk away from Goole railway station.

The property comprises;

Entrance hall leading to an open plan living kitchen with integrated oven, electric hob and extractor hood, space for washing machine and fridge freezer. One double bedroom and modern bathroom with walk-in shower enclosure, wash basin and WC.

The apartment comes with intercom.

Twelve month initial tenancy preferred.

EPC rating and council tax band TBC.

A holding deposit of £121.00 is payable on application.



### Location and EPC Graph



### Energy Efficiency Rating

	Current	Potential
Very energy efficient - lower running costs		
(92 plus) <b>A</b>		
(81-91) <b>B</b>	<b>84</b>	<b>84</b>
(69-80) <b>C</b>		
(55-68) <b>D</b>		
(39-54) <b>E</b>		
(21-38) <b>F</b>		
(1-20) <b>G</b>		
Not energy efficient - higher running costs		
<b>England &amp; Wales</b>	EU Directive 2002/91/EC 	

Extra Info

Council tax band: New Build TBC

To arrange a viewing please register your interest on our website via the tenancy application.

For additional information please contact our office on 01405 768401 or email: [enquiries@linkagency.co.uk](mailto:enquiries@linkagency.co.uk)



Floorplan

linkagency

Approximate Gross Internal Floor Area = 29.0 sq m / 312 sq ft

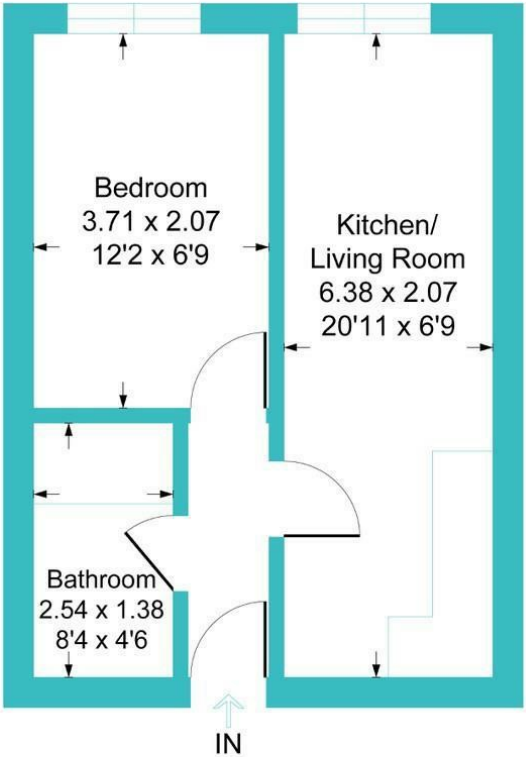

Illustration for identification purposes only, measurements are approximate, not to scale.