

linkagency



Buttfield Road, Howden, East Yorkshire  
£2,250 PCM



# 3 Buttfield Road

DN14 7DW, East Yorkshire

- Hot tub & snooker room
- Three reception rooms with wood burning stoves
- Short walk to Howden centre
- Over 4,000sqft of living space
- Ensuite to two bedrooms
- Truly unique home

Nestled in the heart of Howden is this stunning four bedroom detached family home. This property exudes style and charm and is unique in every sense of the word. Tenants will be a ten minute walk away from Howden's amenities, which include independent cafes, bars and restaurants. Howden Junior & Secondary schools are also within walking distance. Those looking to commute for work can reach the M62 in less than five minutes.

## Location and EPC Graph

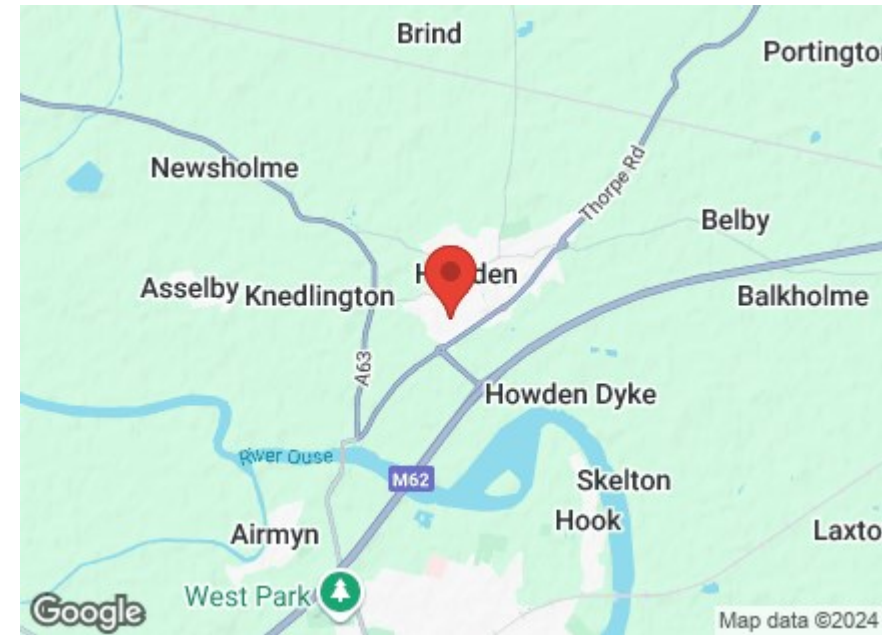

### Energy Efficiency Rating

	Current	Potential
Very energy efficient - lower running costs		
(92 plus) <b>A</b>		
(81-91) <b>B</b>		
(69-80) <b>C</b>		
(55-68) <b>D</b>		
(39-54) <b>E</b>		
(21-38) <b>F</b>		
(1-20) <b>G</b>		
Not energy efficient - higher running costs		
	66	77
<b>England &amp; Wales</b>	EU Directive 2002/91/EC 	



# Extra Info

Council tax band: G

To arrange a viewing please register your interest on our website via the tenancy application.

For additional information please contact our office on 01405 768401 or email: [enquiries@linkagency.co.uk](mailto:enquiries@linkagency.co.uk)



## Floorplan

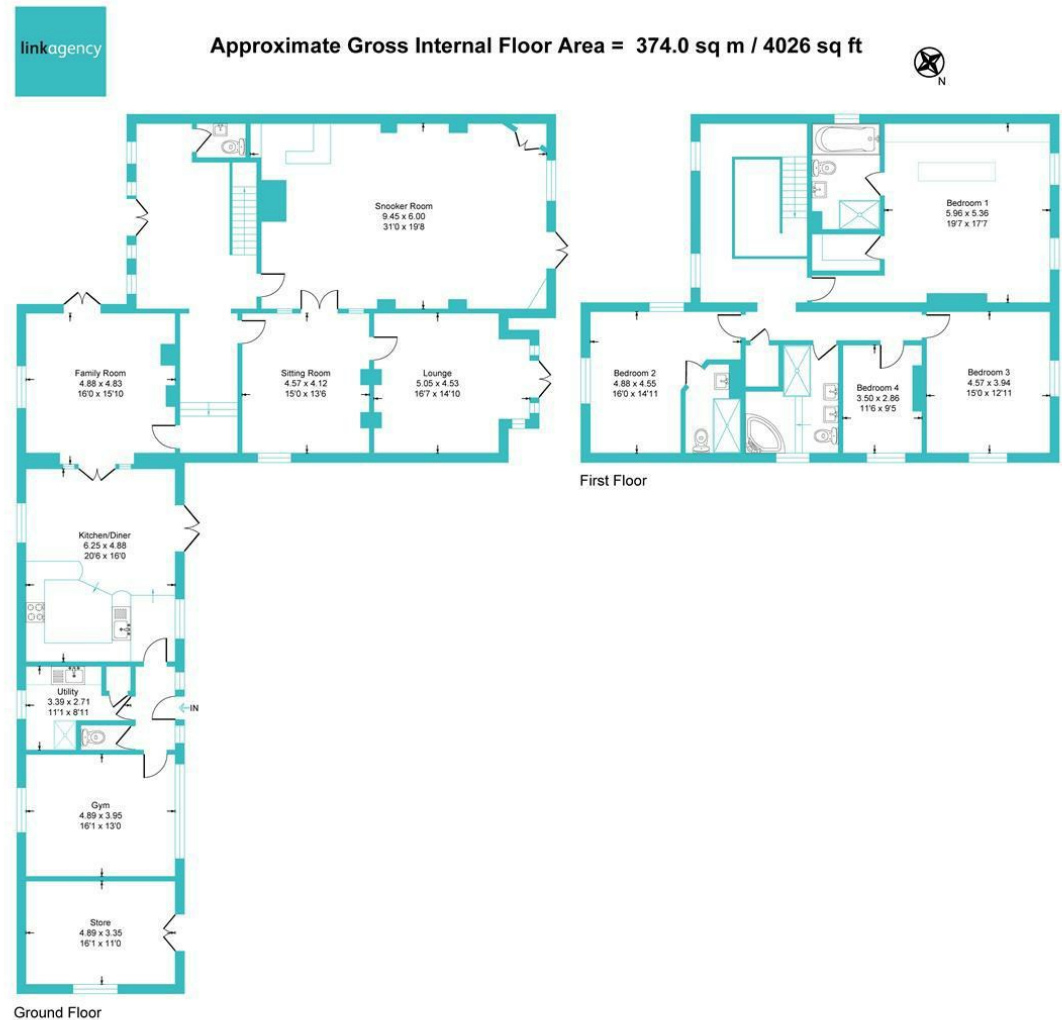

Illustration for identification purposes only, measurements are approximate, not to scale.