

linkagency

3 Bedroom House - Semi-Detached for Sale

£875 PCM

30 Westbourne Grove, Goole, DN14 6NB



KEY FEATURES

- GREAT FAMILY HOME
- SUPERB REAR GARDEN
- KITCHEN WITH INTEGRATED APPLIANCES
- TWO RECEPTION ROOMS
- LOTS OF STORAGE SPACE







linkagency

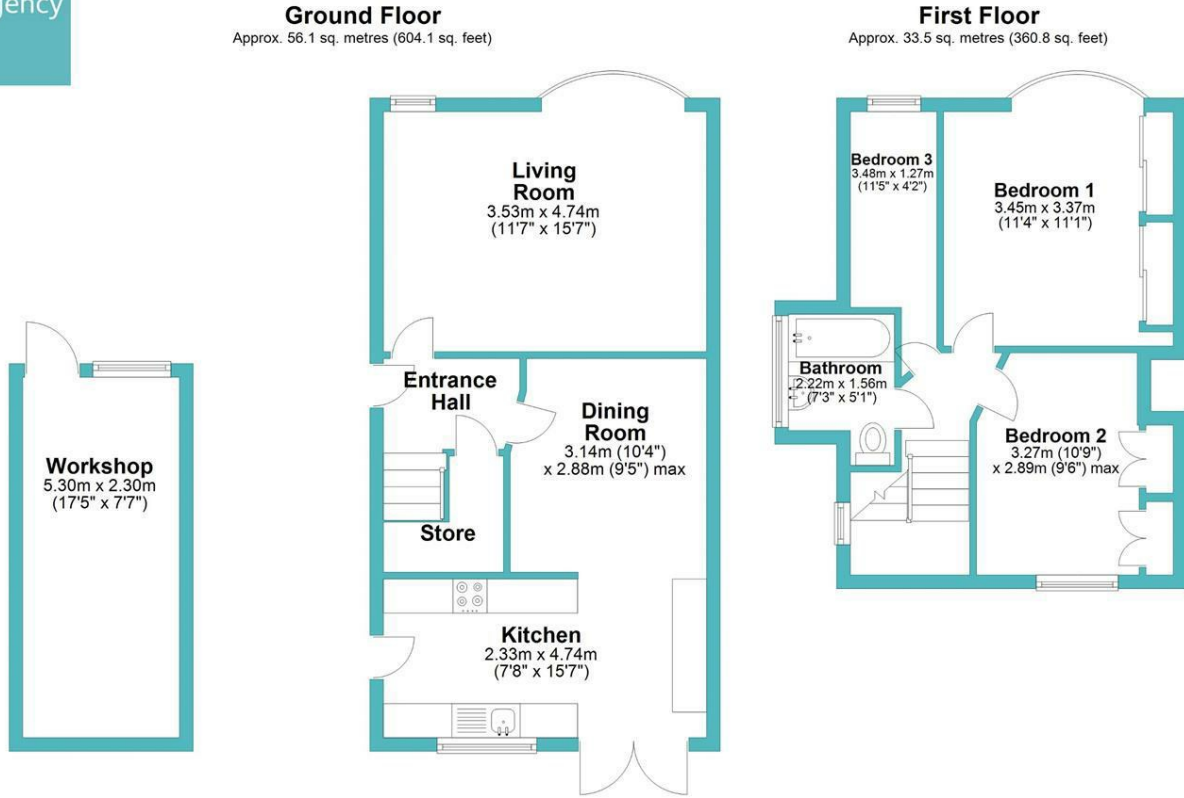

Total area: approx. 89.6 sq. metres (964.9 sq. feet)

Energy Efficiency Rating		
	Current	Potential
Very energy efficient - lower running costs		
(92 plus) A		
(81-91) B		
(69-80) C		
(55-68) D	64	80
(39-54) E		
(21-38) F		
(1-20) G		
Not energy efficient - higher running costs		
England & Wales	EU Directive 2002/91/EC	

Disclaimer

These particulars are produced in good faith. They are set out as a general guide only and do not constitute, any part of an offer or a contract. None of the statements contained in these particulars as to this property are to be relied on as statements or representations of fact. Any intending purchaser should satisfy him/herself by inspection of the property or otherwise as to the correctness of each of the statements prior to making an offer. No person in the employment of, or association with, Link Agency, has any authority to make or give any representation or warranty whatsoever in relation to this property.