

# linkagency

3 Bedroom House - Semi-Detached for Sale

Asking Price £265,000

2 Landing Lane, Hemingbrough, Selby, YO8 6RA



## KEY FEATURES

- LARGE GARDEN
- MODERN KITCHEN
- ENERGY EFFICIENT
- WILL MAKE LOVELY FAMILY HOME
- IDEAL FOR FIRST TIME BUYER
- NEW CARPETS
- ACCESSIBLE FOR M62 AT HOWDEN AND A19 TO YORK











linkagency

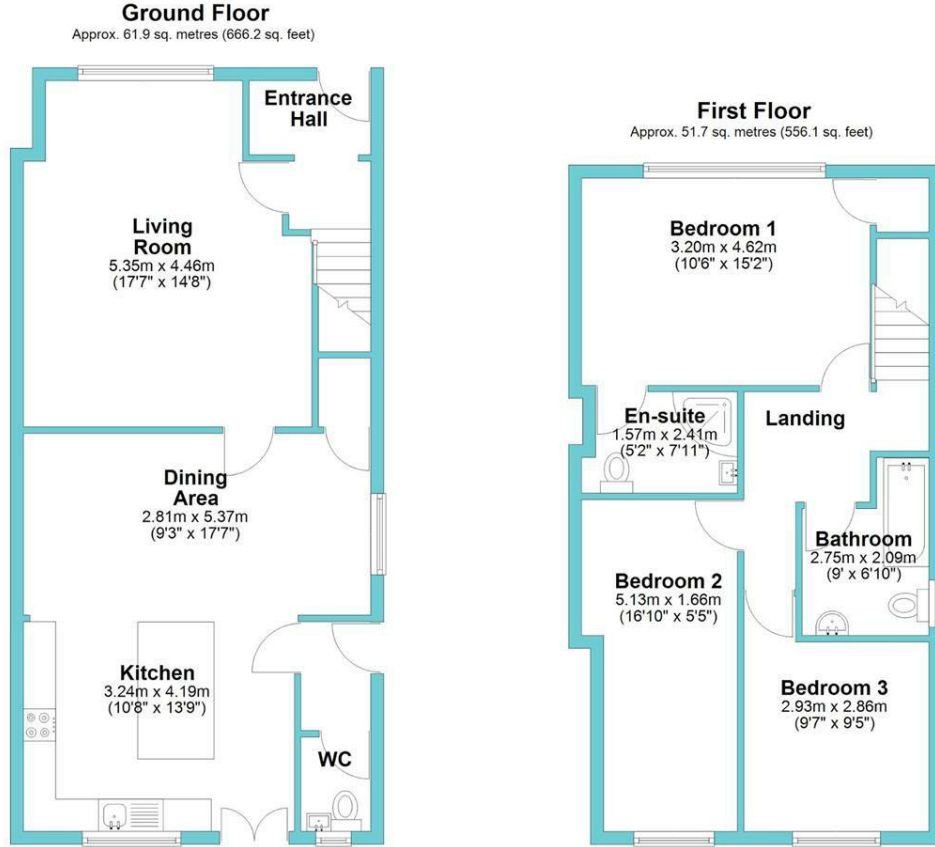

Total area: approx. 113.5 sq. metres (1222.2 sq. feet)

Energy Efficiency Rating		Current	Potential
<i>Very energy efficient - lower running costs</i>			
(92 plus) <b>A</b>			
(81-91) <b>B</b>			
(69-80) <b>C</b>		73	87
(55-68) <b>D</b>			
(39-54) <b>E</b>			
(21-38) <b>F</b>			
(1-20) <b>G</b>			
<i>Not energy efficient - higher running costs</i>			
<b>England &amp; Wales</b>		EU Directive 2002/91/EC	

Disclaimer

These particulars are produced in good faith. They are set out as a general guide only and do not constitute, any part of an offer or a contract. None of the statements contained in these particulars as to this property are to be relied on as statements or representations of fact. Any intending purchaser should satisfy him/herself by inspection of the property or otherwise as to the correctness of each of the statements prior to making an offer. No person in the employment of, or association with, Link Agency, has any authority to make or give any representation or warranty whatsoever in relation to this property.