



Kirby Road, Coventry, CV5 6HN

Asking Price **£165,000**

FEARN MALONE



Kirby Road

Coventry, CV5 6HN

*****NO ONWARD CHAIN***** Charming 2-bed mid-terraced house in sought-after Earlsdon, Coventry. Flexible layout, new boiler. Ideal family home near top schools, parks, and amenities. Council Tax band: A

Tenure: Freehold

EPC Energy Efficiency Rating: E

EPC Environmental Impact Rating: E

- No Chain
- Terraced Family Home
- Two Bedrooms with an Optional Third on the Ground Floor
- New Baxi Boiler Fitted November 2024 with 5 Year Warranty
- On Street Parking



FEARN MALONE

02476 012058

info@fearnmalone.co.uk



Ground Floor

Approx. 36.5 sq. metres (393.4 sq. feet)



First Floor

Approx. 26.1 sq. metres (280.8 sq. feet)

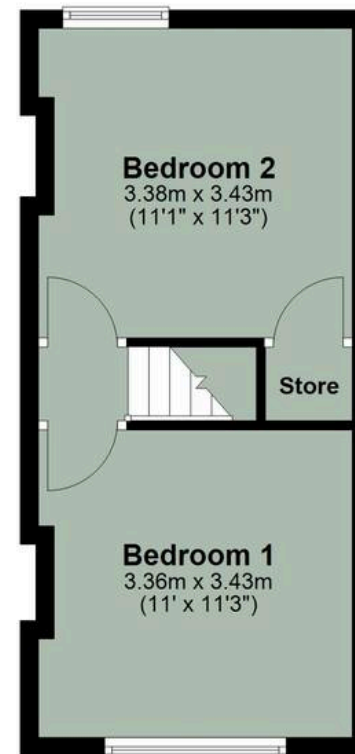

Total area: approx. 62.6 sq. metres (674.2 sq. feet)

This floorplan is for illustrative purposes only and it is not drawn to scale. Measurements, floor-areas, openings and orientations are approximate. They should not be relied upon for any purpose and do not form any part of an agreement. No liability is taken for any error or mis-statement. All parties must rely on their own inspections.
Plan produced using PlanUp.