

ANWYL
thoughtful homes



the henley

4 bed detached with garage

A *traditional* 4 bedroom detached home. Designed to capture the essence of traditional house building with lovely high ceilings, beautiful bay windows and a roofed porch. Step inside and the henley is thoughtfully designed for modern family life with open plan family space, separate living room and generously sized bedrooms on offer.

www.anwylhomes.co.uk

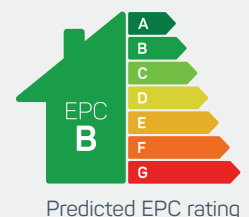



Large open plan
family space

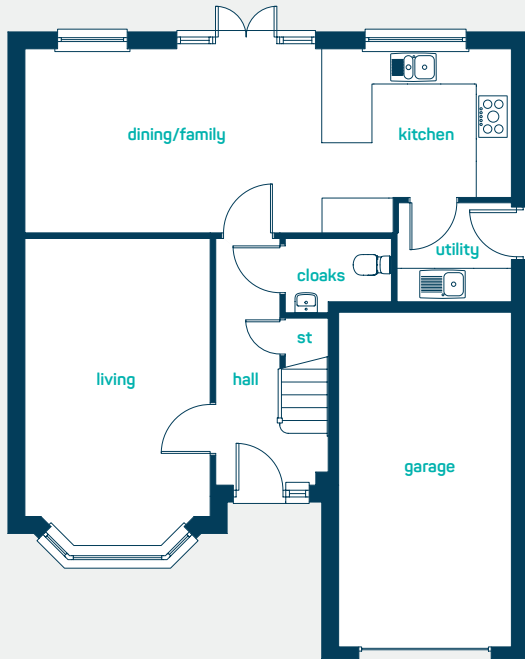

ground floor

kitchen/dining/ family	28'6" x 11"
utility	7'7" x 5'10"
living room	17'8" x 10'9"
cloaks	5'1" x 4"
kitchen/dining/ family	8.67m x 3.35m
utility	2.3m x 1.76m
living room	5.38m x 3.27m
cloaks	1.54m x 1.21m

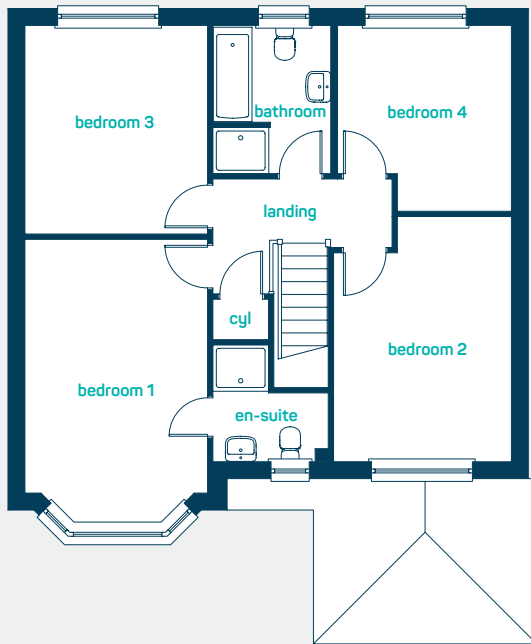

first floor

bedroom 1	16'9" x 10'8"
en-suite	6'9" x 6'9"
bedroom 2	14'9" x 10'5"
bedroom 3	12'2" x 10'8"
bedroom 4	10'6" x 10'2"
bathroom	8'6" x 6'11"
bedroom 1	5.09m x 3.25m
en-suite	2.07m x 2.07m
bedroom 2	4.49m x 3.16m
bedroom 3	3.72m x 3.25m
bedroom 4	3.19m x 3.09m
bathroom	2.60m x 2.11m

the henley
4 bed detached with garage

ANWYL
thoughtful homes

**NEW
HOMES
QUALITY
CODE**

**NEW HOMES
OMBUDSMAN
SERVICE**

www.anwylhomes.co.uk

Anwyl Homes is a Registered Developer with the NHQB. This is a computer-generated image of the henley, elevation treatment may vary. Room sizes are approximate, dimensions are taken from the longest room point (please consult homes advisor for measurement points). Plots may be handed and any garages may be single or double. Kitchen and bathroom layouts are indicative. These plans are correct at the time of going to press, but may be subject to change during construction. Please ensure that you check for specific plot details. 01/11/22 (grand version).

everything considered.