

ANWYL
thoughtful homes



the kinnerton

3 bed semi-detached

A perfect 3 bedroom semi-detached starter home for first time buyers. Key features include *open plan* kitchen/diner, *spacious lounge* and master bedroom with en-suite.

www.anwylhomes.co.uk

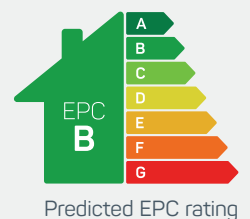

Predicted EPC rating

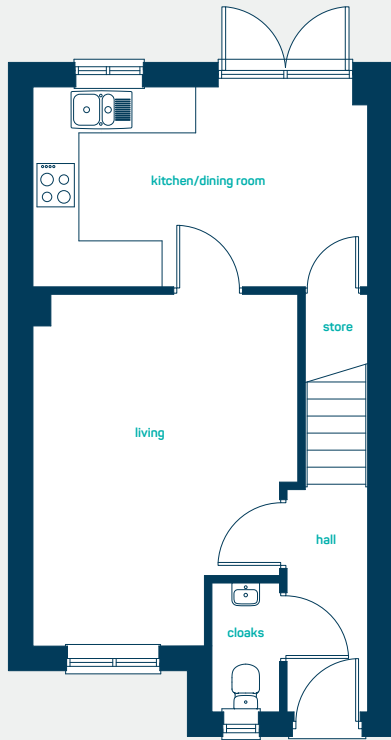

perfect for
first time buyers

ground floor

kitchen/diner: 14'8" x 8'9"
living room: 15'6" x 11'5"
cloaks: 5'8" x 2'11"

kitchen/diner: 4.48m x 2.67m
living room: 4.72m x 3.48m
cloaks: 1.73m x 0.9m

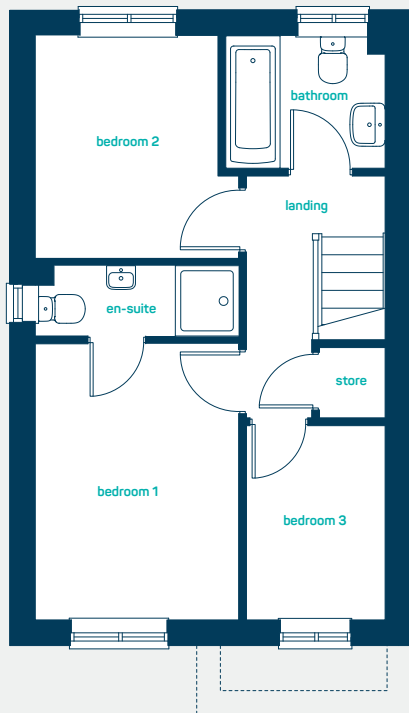

first floor

bedroom 1: 11'3" x 8'3"
en-suite: 8'3" x 3'3"
bedroom 2: 9'5" x 7'8"
bedroom 3: 7'9" x 6'2"
bathroom: 6'9" x 5'7"

bedroom 1: 3.44m x 2.51m
en-suite: 2.51m x 1m
bedroom 2: 2.86m x 2.33m
bedroom 3: 2.36m x 1.88m
bathroom: 2.05m x 1.71m

the kinnerton
3 bed semi-detached

ANWYL
thoughtful homes

**NEW
HOMES
QUALITY
CODE**

**NEW HOMES
OMBUDSMAN
SERVICE**

www.anwylhomes.co.uk

Anwyl Homes is a Registered Developer with the NHQB. This is a computer-generated image of the kinnerton, elevation treatment may vary. Room sizes are approximate, dimensions are taken from the longest room point (please consult homes advisor for measurement points). Plots may be handed and any garages may be single or double. Kitchen and bathroom layouts are indicative. These plans are correct at the time of going to press, but may be subject to change during construction. Please ensure that you check for specific plot details. 01/11/22.

everything considered.