

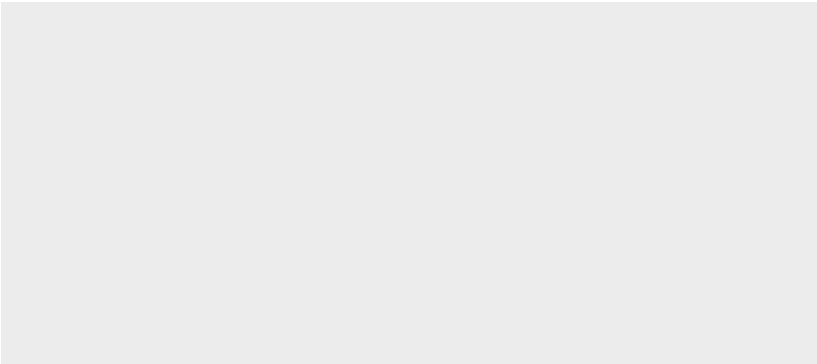

Apartment 5, 1, Tilia Court Berther Road, Hornchurch, RM11 3HU

£1,700 Per Month

Brown & Brand



THE PROPERTY

Nestled on the desirable Berther Road in Hornchurch, this charming two-bedroom apartment offers a perfect blend of comfort and convenience. Spanning 638 square feet, the home is designed to cater to modern living while providing ample space for relaxation and entertaining.

One of the standout features of this property is the secure gated parking, ensuring peace of mind for residents with vehicles. Well maintained communal gardens are another noteworthy benefit of this property.

The location is particularly advantageous, with Emerson Park Train Station just a short distance away. This provides excellent transport links for commuters, making it easy to access central London and beyond. High street amenities are also available within a 12 minute walking distance.

This property presents a wonderful opportunity to enjoy a comfortable lifestyle in a vibrant community. With its appealing features and prime location, this home is sure to attract interest.

EPC: C rating

SITUATION

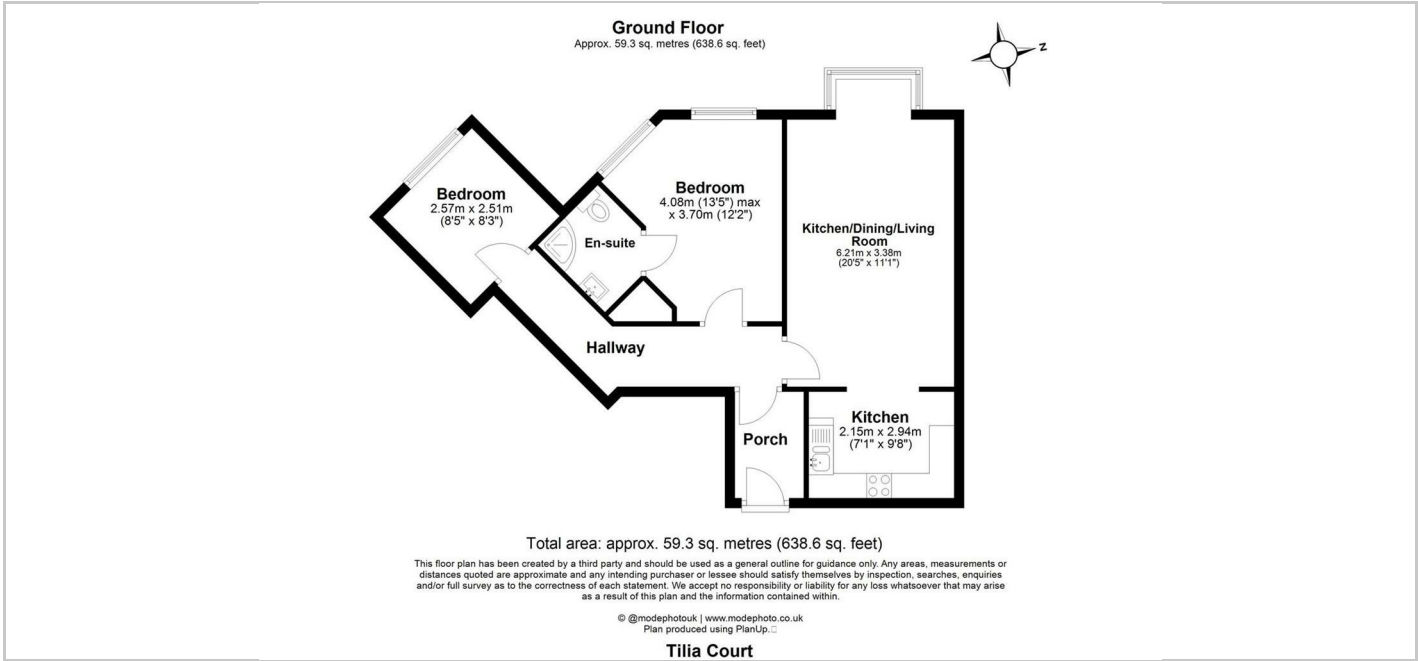

Directions

221 London road, Hadleigh, SS7 2RD
Tel: Email: