

Pump House Crescent, TW8

£647 Per week

This stunning two bedroom apartment has been finished to a high standard throughout and offers a large reception room, two modern bathrooms and a wrap around balcony to enjoy the cinematic views over Brentford and the River Thames.

The Kew Bridge West development is located next to the River Thames and within half a mile from Kew Bridge station which offers regular services to Waterloo.

Features

- Two Bedrooms
- Two Bathrooms
- Wrap Around Balcony
- Residents Gym
- Concierge
- Allocated Parking

Pump House Crescent, Brentford, TW8

Turner House, Pump House Crescent, Brentford, TW8

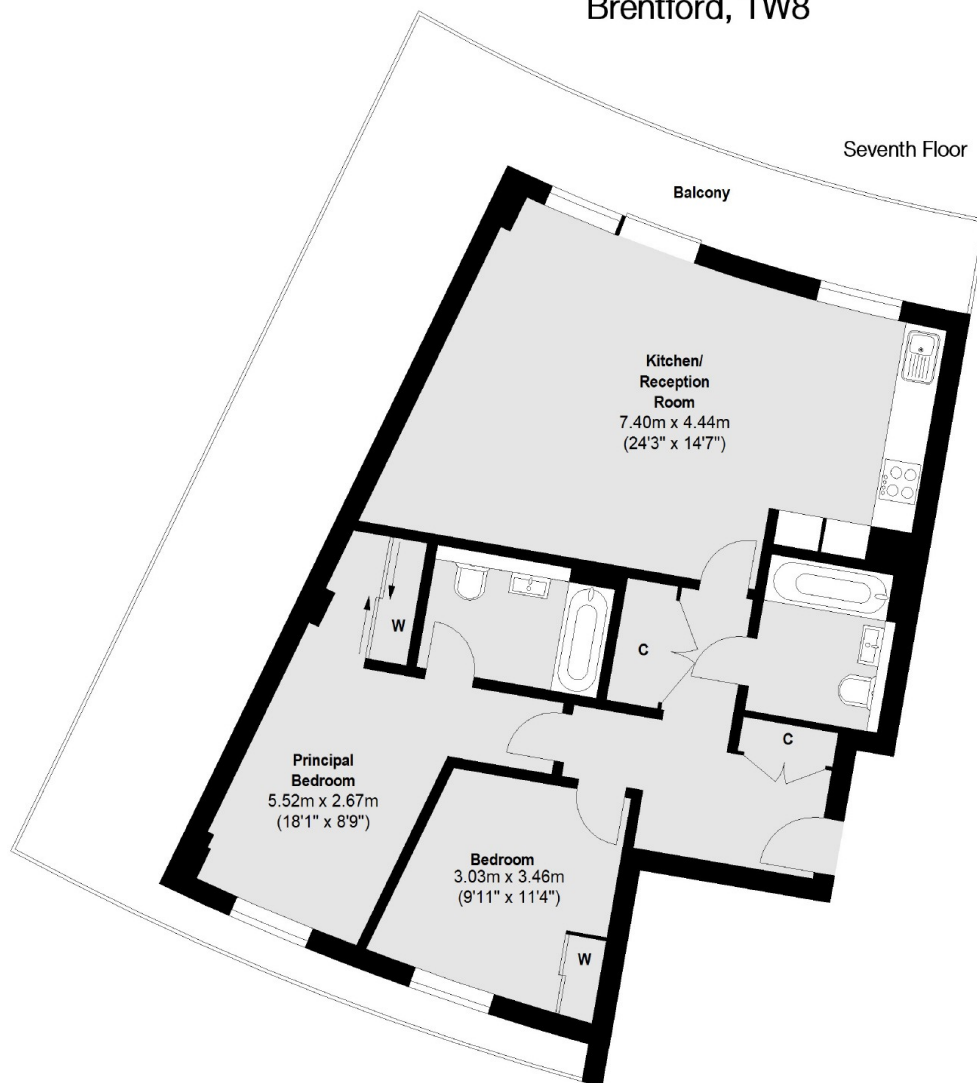

Total area (approx.): 78.6 sq. m (846.5 sq. ft)
Balcony area (approx.): 42.45 sq. m (456.9 sq. ft)

Not to scale, for guidance only and must not be relied upon as a statement of fact.
All measurements and areas are approximate only

Dexters

Brentford
194 High Street
Brentford
TW8 8LB
Lettings
020 8939 6077

Energy Rating: C. We aim to make our particulars both accurate and reliable. However they are not guaranteed; nor do they form part of an offer or contract. If you require clarification on any points then please contact us, especially if you're traveling some distance to view. Please note that appliances and heating systems have not been tested and therefore no warranties can be given as to their good working order.

 **RICS** | Regulated
Estate Agent
and Letting Agent

[dexters.co.uk](https://www.dexters.co.uk)