



Goat Wharf, TW8

£461 Per week

This two bedroom apartment offers a spacious reception room/kitchen area, underground parking, a lift and a concierge office and amazing river views of the Thames from the balcony.

Goat Wharf is a sought after riverside development close to Brentford High Street. It is within half a mile from Brentford overground station and has easy access to the M4/A4.

Features

- Two Bedrooms
- Large Reception
- Lift Access
- Allocated Secure Parking
- Close To Amenities
- Riverside Development

Goat Wharf, Brentford, TW8

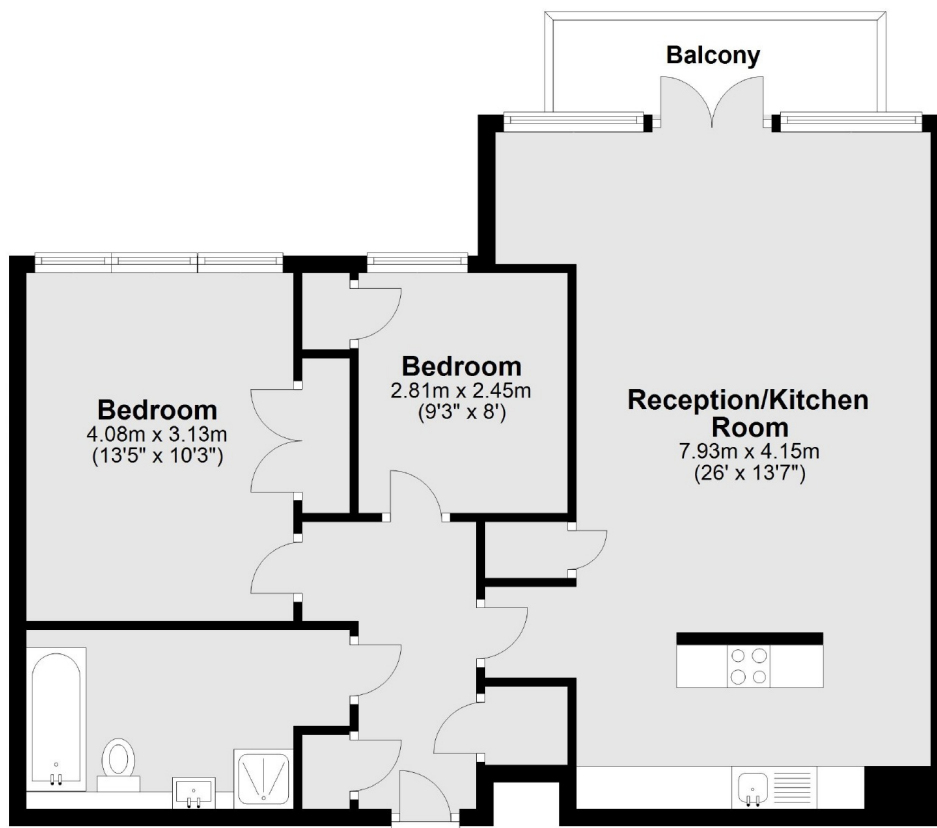

Main area: Approx. 74.3 sq. metres (800.0 sq. feet)
Plus balconies, approx. 4.6 sq. metres (49.5 sq. feet)

Dexters

Brentford
194 High Street
Brentford
TW8 8LB
Lettings
020 8939 6077

Energy Rating: B. We aim to make our particulars both accurate and reliable. However they are not guaranteed; nor do they form part of an offer or contract. If you require clarification on any points then please contact us, especially if you're traveling some distance to view. Please note that appliances and heating systems have not been tested and therefore no warranties can be given as to their good working order.

 **RICS** | Regulated
Estate Agent
and Letting Agent

[dexters.co.uk](https://www.dexters.co.uk)