



Great West Road, TW8

£346 Per week

A one-bedroom studio apartment featuring an open-plan kitchen, offering plenty of storage space and wooden flooring throughout. The reception room provides access to a private balcony, overlooking the communal gardens for residents. The property also benefits from on-site concierge service, allocated parking and a residents' gym.

The area benefits from excellent transport links, with Brentford Railway Station just a short walk away, offering direct services to Central London. Boston Manor Underground Station, a short bus or car ride away, provides access to the Piccadilly Line, and nearby Kew Bridge Station offers Overground and District Line services. Several bus routes connect to local destinations and transport hubs. For drivers, easy access to the motorway network ensures fast travel in and out of London, as well as to Heathrow Airport.

Features

- Studio
- Wood Flooring
- Private Terrace
- Allocated Parking
- Concierge Service
- On-Site Gymnasium

Great West Road, Brentford, TW8

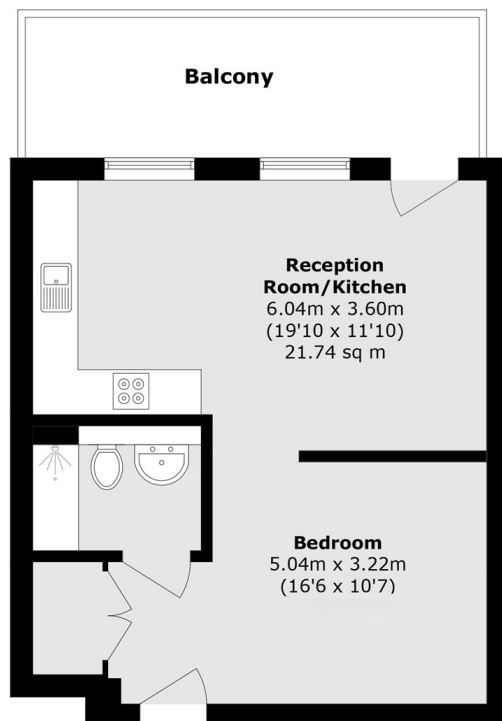

Total area (approx.): 41.7 sq. m (448.8 sq. ft)

Balcony area (approx.): 11.2 sq. m (120.5 sq. ft)