



21 Hempstead Lane

Berkhamsted, HP4 2RZ

£2,750,000

Newly Refurbished Five-Bedroom Luxury Home in the sought after area of Potten End
4,050 sq ft of contemporary elegance with a bespoke kitchen-diner, games room, study, and master suite. Generous garden, garage, and parking for 5+. Countryside charm with Berkhamsted and London within easy reach. Completion Dec 2025.

- 4,050 sq ft Of Luxury Living, Finished To The Highest Standard Throughout
- Stunning Kitchen-Diner With Central Island, The Perfect Hub For Family Life And Entertaining
- Separate Home Office And Sitting Room, Offering Space For Both Work And Relaxation
- Utility Room For Everyday Convenience And Organisation
- Amazing Games Room and Bedroom Two - Could Double As An Annex
- Four Spacious Double Bedrooms, Including A Luxurious Master Suite With En Suite
- Generous Landscaped Garden
- Garage Plus Private Driveway With Parking For 5+ Cars
- Located In The Prestigious Village Of Potten End, Surrounded By Countryside Yet Close To Berkhamsted
- A Rare Opportunity To Secure A Home Of This Calibre In One Of Hertfordshire's Most Desirable Settings

Viewing

Please contact our Bovingdon Office on 01923262666 if you wish to arrange a viewing appointment for this property or require further information.



5



4



4



F

Floor Plan

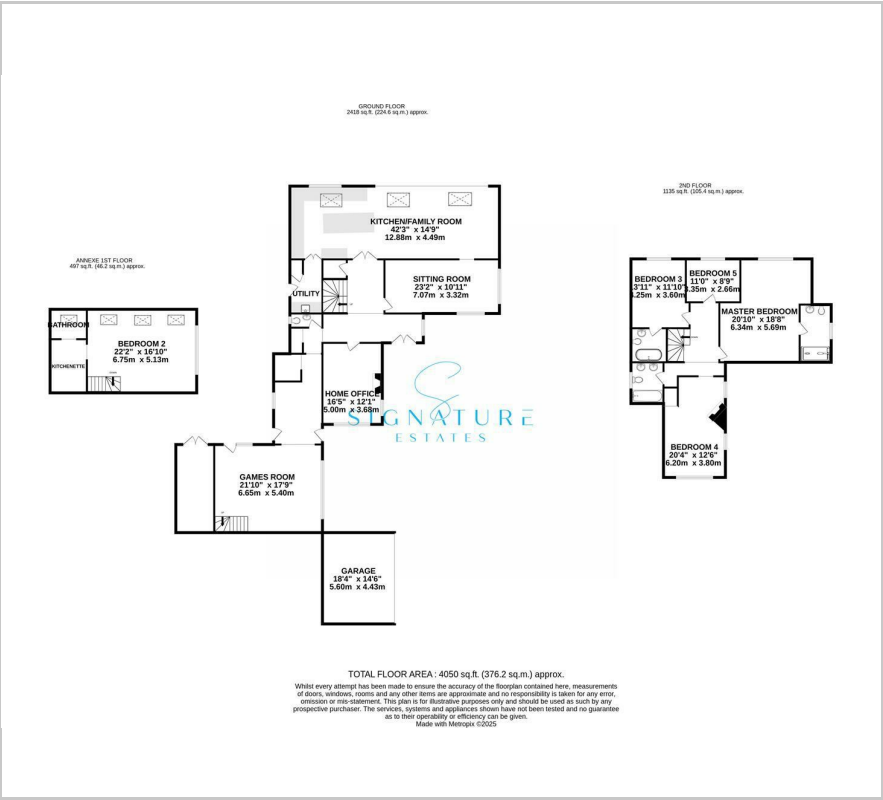

Area Map



Energy Efficiency Graph

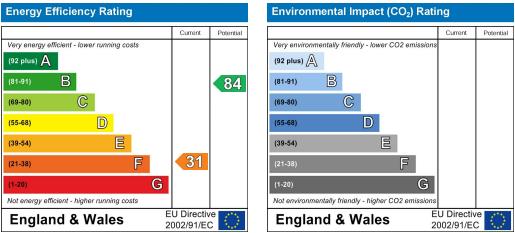

These particulars, whilst believed to be accurate are set out as a general outline only for guidance and do not constitute any part of an offer or contract. Intending purchasers should not rely on them as statements of representation of fact, but must satisfy themselves by inspection or otherwise as to their accuracy. No person in this firm's employment has the authority to make or give any representation or warranty in respect of the property.