



www.chrystals.co.im

Woodburn Cottage, Peel Road, St Johns, IM4 3LR
Asking Price £359,000

Woodburn Cottage, Peel Road, St Johns, IM4 3LR

Asking Price £359,000

This beautiful detached cottage is situated in the sought after village of St Johns within an easy walk of the arboretum, church and schools. The accommodation offers a sitting room with open fire, Kitchen/diner leading into a separate utility/pantry. The first floor includes 3 double bedrooms, study, shower room and separate WC. At the rear there is off road parking for 2 cars, a right of access is granted over the driveway to the right of the property. A large shed/workshop and an additional garden shed provides sufficient garden storage and work space. Both sheds have electric connected. The rear garden has been nicely maintained with a number of mature shrubs trees but predominately lawned. The garden slopes up towards a sun terrace which enjoys pretty views towards Slieau Whallian. An application has been permitted to alter and extend the dwelling with additional living accommodation. Application number 22/01555/B.



LOCATION

From Douglas travel west along the A1 towards Ballacraigne traffic lights in St Johns. Continue straight ahead and the property can be found a short distance on the right hand side.

ENTRANCE

Attractive part glazed door. Tiled floor. Stairs leading to upper floor.

LIVING ROOM *12' 10" x 12' 2" (3.9m x 3.7m)*

Carpet floor. Wooden beams. Radiator. Open grate fire with stone hearth and surround. Alcove either side of chimney breast. Satellite and television points. Fibre broadband connected. uPVC double glazed window to front aspect.

KITCHEN/DINER *14' 1" x 13' 9" (4.3m x 4.2m)*

Fitted with a good range of shaker style units to base and eye level units with laminate worktops over. 1 1/2 bowl stainless steel sink unit with mixer tap and drainer. Electric oven/grill and 4 ring induction hob with extractor above. Space for fridge freezer. Undercounter lights. Wooden beams. Tiled floor. Multiple plug sockets. uPVC double glazed window to rear aspect.

UTILITY ROOM *12' 2" x 6' 3" (3.7m x 1.9m)*

Vinyl flooring. Velux roof light. Plumbed for washing machine and dryer. Space for fridge freezer. Shelving and storage to one wall.

STORE ROOM *9' 2" x 7' 3" (2.8m x 2.2m)*

Housing Worcester oil fired central heating boiler. uPVC double glazed window. Door to rear garden.

FIRST FLOOR: LANDING

Carpeted floor.

STUDY *6' 7" x 6' 3" (2.0m x 1.9m)*

Carpeted floor. Radiator. Shelving. uPVC double glazed window to front aspect.

BEDROOM 2 *14' 5" x 11' 6" (4.4m x 3.5m)*

Currently being used as a Lounge. Carpeted floor. Multiple plug sockets. Radiator. uPVC double glazed to front aspect.

BEDROOM 1 *14' 5" x 11' 6" (4.4m x 3.5m)*

Carpeted floor. Radiator. uPVC double glazed window to front aspect. Cupboard with shelving and hanging space.

SHOWER ROOM

Modern two piece suite comprising large enclosed shower cubicle. Pedestal wash hand basin. Fully tiled walls and floor. Chrome heated towel rail. Radiator. uPVC double glazed to rear aspect.

CLOAKROOM

WC. Laminate floor. Opaque double glazed window to rear aspect. LED downlights.

BEDROOM 3 *9' 10" x 9' 6" (3.0m x 2.9m)*

Carpeted floor. Window to side aspect. Radiator. Part glazed door to rear garden.

PLANING PERMISSION

An application has been permitted to alter and extend the dwelling with additional living accommodation. Application number 22/01555/B.

OUTSIDE

At the rear there is off road parking for 2 cars, a right of access is granted over the driveway to the right of the property. A large shed/workshop and an additional garden shed provides sufficient garden storage and work space. Both sheds have electric connected. The rear garden has been nicely maintained with a number of mature shrubs trees but predominately lawned. The garden slopes up towards a sun terrace which enjoys pretty views towards Slieau Whallian.

SERVICES

Mains water, electricity and drainage. Oil central heating.

VIEWING

Viewing is strictly by appointment through CHRYSTALS Please inform us if you are unable to keep appointments.

POSSESSION

Vacant possession on completion of purchase. The company do not hold themselves responsible for any expenses which may be incurred in visiting the same should it prove unsuitable or have been let, sold or withdrawn. DISCLAIMER - Notice is hereby given that these particulars, although believed to be correct do not form part of an offer or a contract. Neither the Vendor nor Chrystals, nor any person in their employment, makes or has the authority to make any representation or warranty in relation to the property. The Agents whilst endeavouring to ensure complete accuracy, cannot accept liability for any error or errors in the particulars stated, and a prospective purchaser should rely upon his or her own enquiries and inspection. All Statements contained in these particulars as to this property are made without responsibility on the part of Chrystals or the vendors or lessors.







GROUND FLOOR

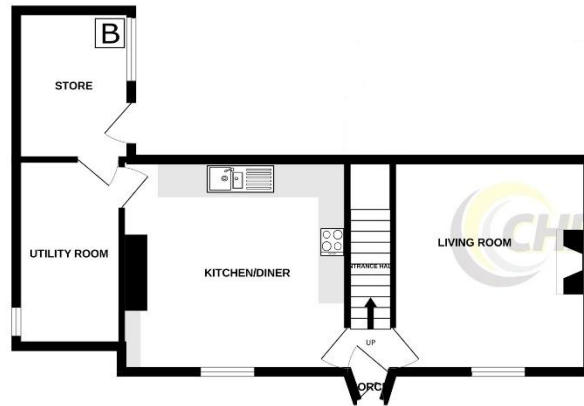

1ST FLOOR



Measurements are approximate. Not to scale. Illustrative purposes only
Made with Metropix ©2023

Since 1854



DOUGLAS
31 Victoria Street
Douglas IM1 2SE
T. 01624 623778
E. douglas@chrystals.co.im

PORT ERIN
23 Station Road
Port Erin IM9 6RA
T. 01624 833903
E. porterin@chrystals.co.im

COMMERCIAL
Douglas Office: 01624 625100, commercial@chrystals.co.im

RENTALS
Douglas Office: 01624 625300, douglasrentals@chrystals.co.im

Directors: Shane Magee M.R.I.C.S.; Neil Taggart BSc (Hons), M.R.I.C.S.; Joney Kerruish BSc (Hons), M.R.I.C.S.; Dafydd Lewis BSc (Hons), M.R.I.C.S., MA (Cantab), Dip Surv Prac.; Consultants: Keith Kerruish
Registered in the Isle of Man No. 34808, Chrystal Bros, Stott & Kerruish Ltd. Trading as Chrystals. Registered Office, 31 Victoria Street, Douglas, Isle of Man IM1 2SE.