

Rose-An-Grouse, Canonstown, Hayle, TR27 6LS

Guide Price £219,995

 2  1  1



This semi-detached two bedroom bungalow is move in-ready with new carpets, a modern bathroom suite and even a modern cooker included in the purchase price! All rooms are bright, and accessed off a large entrance hallway, while at the rear is a sunny, spacious garden area that offers scope to create something quite special that maximises the wonderful views out across open fields.



ANDREW
EXELBY
ESTATE AGENTS

Key Features

- TWO BEDROOM SEMI-DETACHED BUNGALOW
- MOVE IN-READY / BEAUTIFULLY PRESENTED
- REAR GARDEN WITH STORAGE SHED
- NEW CARPETS THROUGHOUT
- EPC - F
- OFF STREET PARKING / DRIVEWAY
- FULLY DOUBLE GLAZED
- SMART MODERN BATHROOM SUITE
- NO ONWARD CHAIN / CHAIN-FREE
- COUNCIL TAX BAND - C

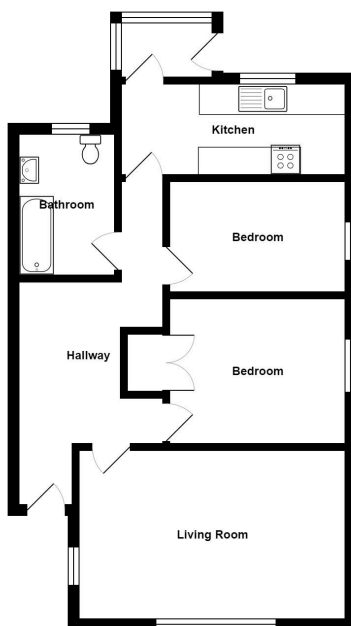

Total Area: 68.8 m² ... 741 ft²

All measurements are approximate and for display purposes only