



St Levan, TR19

£300,000

2 1 2



Detached and hidden away in a secluded and private setting is this delightful timber-built chalet-style bungalow with some modern touches and a very good size garden.

Hidden away on a very good size plot is this desirable and charming detached timber-built property with parking and pretty gardens.

All on one floor, the property boasts two double bedrooms, a family bathroom, utility space, a delightful kitchen/diner and a very appealing living room. The property is blessed with some glorious garden space that has been thoughtfully crafted.



Key Features

- DETACHED TWO BEDROOM SINGLE STOREY PROPERTY
- BEAUTIFUL GARDENS THAT EXTEND TO OFFER A GOOD PLOT
- HIDDEN AWAY LOCATION NEAR PORTHCURNO
- FANTASTIC OPPORTUNITY TO OWN AN IDYLLIC HOME
- EPC - F
- NON-STANDARD CONSTRUCTION / TIMBER-BUILT
- FREESTANDING CONTEMPORARY WOODBURNER IN LIVING ROOM
- OFF STREET PARKING FOR TWO VEHICLES
- PARTIAL DOUBLE GLAZING
- COUNCIL TAX BAND - A

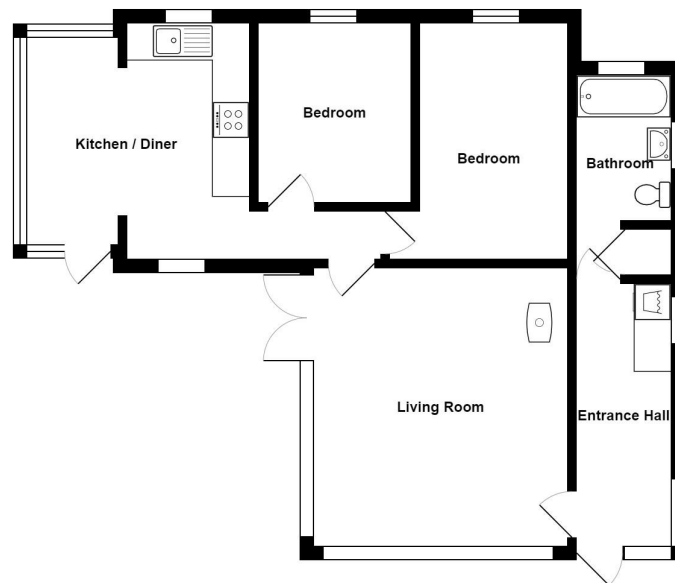

Total Area: 67.6 m² ... 727 ft²

All measurements are approximate and for display purposes only