



Sancreed, Penzance TR20

£1,250,000

🛏 5 🚿 2 🛋 3



- STUNNING 5 BED 1930S HOME IN SANCREED
- GROUND SOURCE HEAT PUMP & SOLAR PANELS
- EXTENSIVE GARDENS PLUS WOODLAND AREA
- FEED-IN TARIFF & HEAT INCENTIVES ONGOING

An exquisite example of property built in the 1930s as part of the Modern Movement, this expansive residence sits in approximately an acre of lush grounds inc wildflower meadows and a wooded area.



Key Features

- Stunning 5 Bed 1930's Home in Sancreed
- Extensive Gardens inc Wooded Area
- Many Original 30's Features & Fittings
- Blissful & Private Countryside Location
- EPC - B
- Ground-Source Heat Pumps & Solar Panels
- Feed-In Tariff & Heat Incentives Ongoing
- Designed by Geoffrey Bazeley, 1935/36
- Stunning Far-Reaching Views to the Coast
- Council Tax Band - F

Tregannick, Penzance, TR20

Approximate Area = 2871 sq ft / 266.7 sq m (excludes pod & garage)
Outbuilding = 183 sq ft / 17 sq m
Total = 3054 sq ft / 283.7 sq m

For identification only - Not to scale

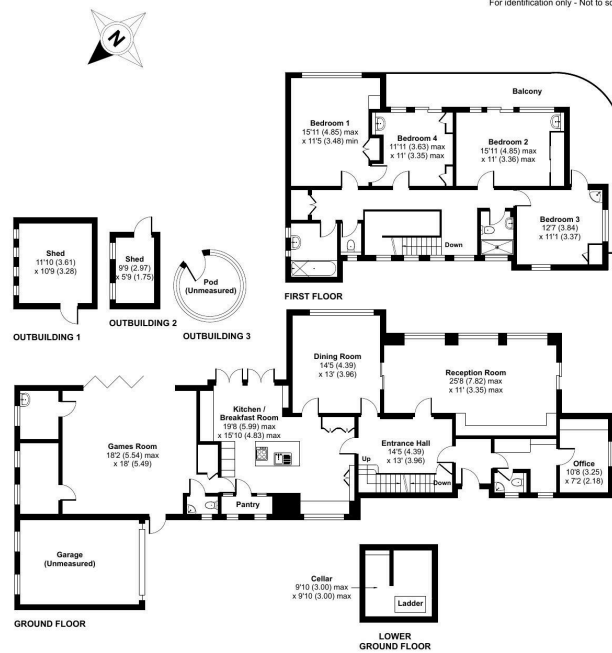

Floor plan produced in accordance with RICS Property Measurement Standards incorporating International Property Measurement Standards (IPMS Residential). © rickcom 2024. Produced for Andrew Exelby Estate Agents. REF: 1076363