

ANWYL
thoughtful homes



the coxley

2 bed semi-detached

A *stunning* 2 bedroom home perfect for first-time buyers. Key features include a spacious living room with french doors leading out to the rear garden, two double bedrooms and separate downstairs cloaks.

www.anwylhomes.co.uk

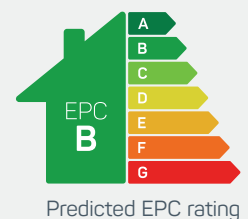

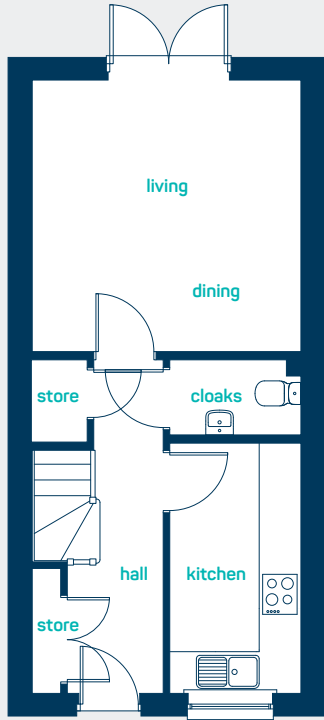

perfect for
first-time buyers

ground floor

living room/dining 13'0" x 12'10"
kitchen 12'0" x 6'3"
cloaks 6'3" x 3'7"

living room/dining 3.95m x 3.9m
kitchen 3.65m x 1.9m
cloaks 1.9m x 1.09m

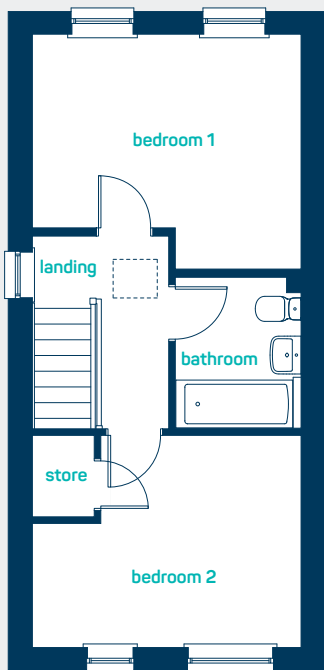

first floor

bedroom 1 12'10" x 11'3"
bedroom 2 12'10" x 10'1"
bathroom 7'2" x 6'3"

bedroom 1 3.9m x 3.43m
bedroom 2 3.9m x 3.08m
bathroom 2.18m x 1.91m

the coxley
2 bed semi-detached

ANWYL
thoughtful homes

**NEW
HOMES
QUALITY
CODE**

**NEW HOMES
SERVICE
OMBUDSMAN**

www.anwylhomes.co.uk

Anwyl Homes is a Registered Developer with the NHQB. This is a computer-generated image of the coxley, elevation treatment may vary. Room sizes are approximate, dimensions are taken from the longest room point (please consult homes advisor for measurement points). Plots may be handed and any garages may be single or double. Kitchen and bathroom layouts are indicative. These plans are correct at the time of going to press, but may be subject to change during construction. Please ensure that you check for specific plot details. 12/12/22.

everything considered.