

**BACTON
TWO / THREE
BEDROOM
HOME**

BLOOR HOMES



A two / three bedroom semi-detached home with a perfectly proportioned lounge and a stunning open plan kitchen / dining room with French doors opening onto the rear garden. The ground floor is complete with a utility area and cloakroom. Upstairs the spacious master suite offers fitted storage and an en suite shower room. This home also benefits from a second double bedroom and a study that could be transformed into a third bedroom, dressing room or even a nursery.

BACTON

A STYLISH TWO / THREE
BEDROOM SEMI-DETACHED HOME

**BACTON
TWO / THREE
BEDROOM
HOME**

FIRST FLOOR:

BEDROOM 1
2.86m x 3.44m
9'5" x 11'3"

EN SUITE

BEDROOM 2
2.61m x 3.60m
8'7" x 11'10"

BEDROOM 3 / STUDY
2.15m x 2.07m
7'1" x 6'9"

BATHROOM

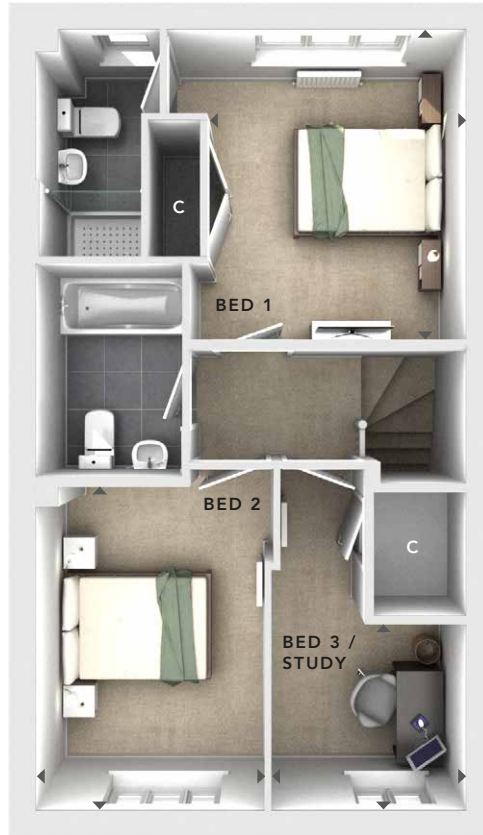

**FIRST
FLOOR**

GROUND FLOOR:

LOUNGE
3.76m x 4.88m
12'4" x 16'0"

KITCHEN / DINING
3.71m x 3.69m
12'2" x 12'1"

UTILITY
1.05m x 1.97m
3'5" x 6'5"

CLOAKS



**GROUND
FLOOR**

C	- Storage
△	- External Access
◀▶	- Measurement Points
© Bloor Homes • VE NSS 372B 4.5	



These particulars are intended as a preliminary guide for prospective purchasers and should not be relied upon. The elevational treatment for individual house types shows a typical arrangement. Details of materials and design treatments may vary. Any artist impressions shown are not intended to represent any particular plot. Purchasers are advised to inspect the layout plan to establish the arrangement of the house and surrounding property. Internal layouts show a general arrangement which may vary from plot to plot. Room sizes given are approx. overall finished room sizes and subject to normal building tolerances (ie ± 75mm). In all instances purchasers are advised to inspect plot specific information available from our sales team. Nothing in these particulars or verbal assurance shall form or constitute part of any contract, and are given without any responsibility on behalf of Bloor Homes.