



**BLUEPRINTS & CO.**  
P R O P E R T I E S

Sales - Lettings - Management - Mortgages



## Lancaster Road

, London, N18 1HP

**Offers over £380,000**



Chain free! Blueprints & Co. Properties are pleased to present this Three Bedroom Terraced House situated close to Silver Street with its train station, bus links, hospital and schools all within easy reach. This well presented family home features an open plan through lounge, a kitchen, a ground floor bathroom, and three bedrooms on the first floor.

Due to the central location, we feel that this makes an ideal investment or family home with the potential to make it your own. The promising Angel Edmonton area has undergone extensive regeneration and has benefited from major improvements in recent years ranging from redesigned public areas, upgraded transport links and added shopping facilities.



## Area Map



## Floor Plans

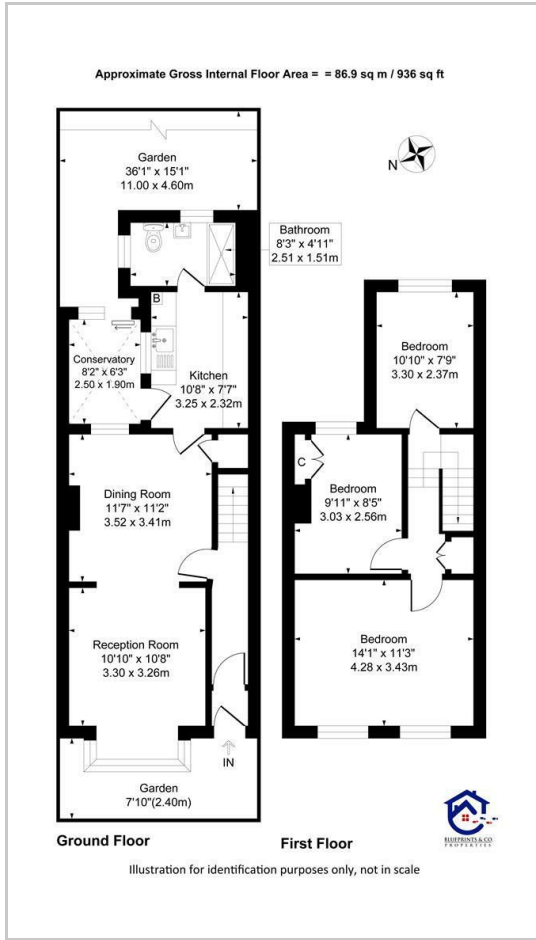

## Energy Efficiency Graph

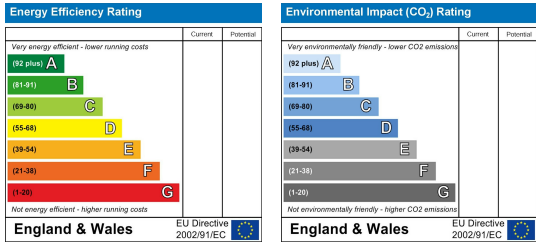

These particulars, whilst believed to be accurate are set out as a general outline only for guidance and do not constitute any part of an offer or contract. Intending purchasers should not rely on them as statements of representation of fact, but must satisfy themselves by inspection or otherwise as to their accuracy. No person in this firm's employment has the authority to make or give any representation or warranty in respect of the property.