



## The Avenue

, London, N17 6TB

**£550,000**



Blueprints & Co Properties is thrilled to present this large three/four bedroom Semi-detached family home located in Bruce Grove area of Tottenham.

The property offers a spacious open plan living room with access to the private rear garden, second reception room which could be used as an additional bedroom on the ground floor, fitted kitchen and downstairs second bathroom.

The first floor offers three large double bedrooms, storage cupboards, up stairs family bathroom and loft space.

The property is freehold and also chain free and would be ideal for a family looking to move into this area which is known for young families and excellent local schools.

The property is close to Bruce Grove over ground, easy access to Seven Sisters, excellent bus links, local community parks and shopping amenities.



## Area Map



## Floor Plans

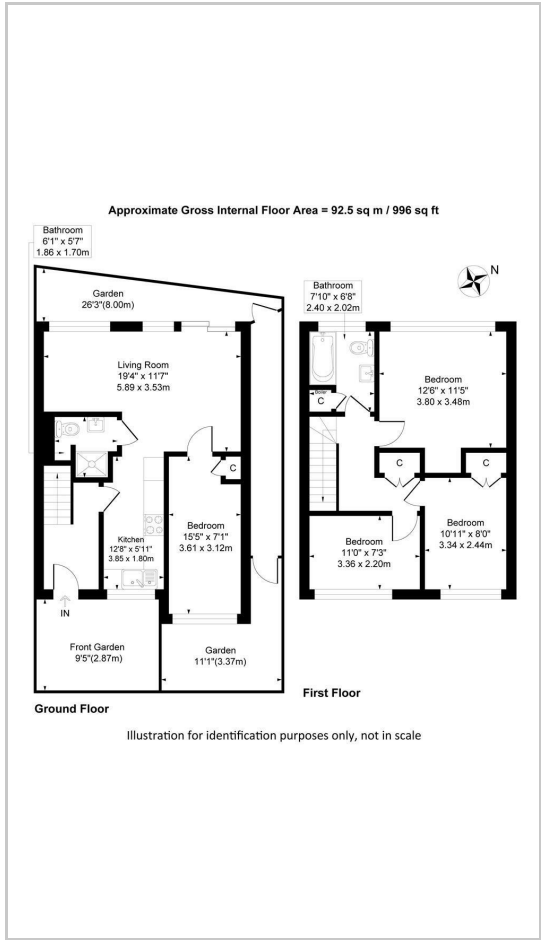

## Energy Efficiency Graph



These particulars, whilst believed to be accurate are set out as a general outline only for guidance and do not constitute any part of an offer or contract. Intending purchasers should not rely on them as statements of representation of fact, but must satisfy themselves by inspection or otherwise as to their accuracy. No person in this firm's employment has the authority to make or give any representation or warranty in respect of the property.