



India Way
Roehampton, London, SW15 5FE
£4,500 Per Month

 4  4  2  C

MADISON BROOK
INTERNATIONAL

India Way, Roehampton, London, SW15 5FE

This stunning property is located on India Way in the heart of London, SW15. This modern terraced house boasts a spacious 1,777 sq ft of living space, perfect for a growing family or those who love to entertain.

As you step inside, you are greeted by not one, but two elegant reception rooms, offering plenty of space for relaxation and social gatherings. The property features four bright and airy bedrooms, providing ample room for a large family or guests staying over.

With four bathrooms, there will be no more waiting in line during the morning rush, ensuring everyone can start their day smoothly. The modern design of the property adds a touch of sophistication to each bathroom, creating a luxurious feel.

One of the standout features of this property is the parking space available for two vehicles, a rare find in London. Say goodbye to circling the streets in search of a parking spot - you'll have your own convenient space right at



These particulars, whilst believed to be accurate are set out as a general outline only for guidance and do not constitute any part of an offer or contract. Intending purchasers should not rely on them as statements of representation of fact, but must satisfy themselves by inspection or otherwise as to their accuracy. No person in this firm's employment has the authority to make or give any representation or warranty in respect of the property.

181 Chiswick High Road, London, W4 2DR
 Tel: 020 3946 6600 Email: chiswick@madisonbrook.com <https://madisonbrook.com/>

Floor Plan

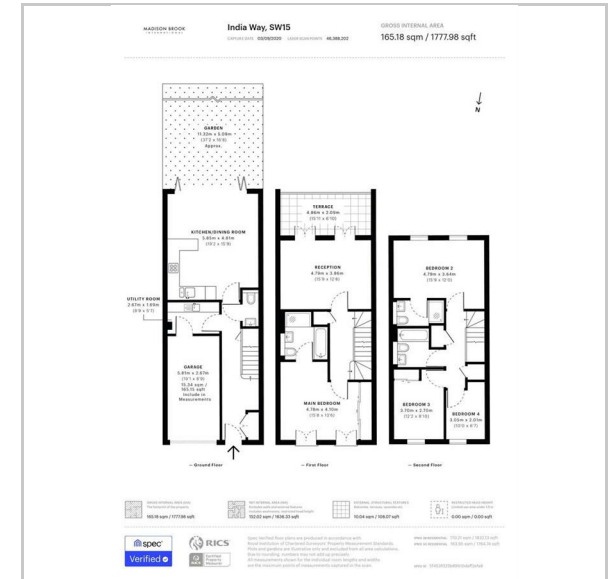

Area Map

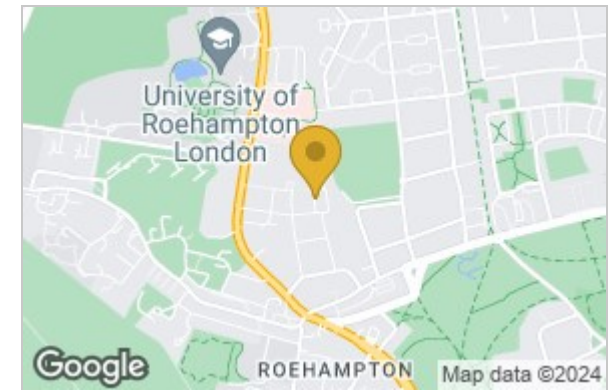

Energy Efficiency Graph

