



Darwin Road

London, London, W5 4BD

Asking Price £625,000



3



2



2



C

MADISON BROOK
INTERNATIONAL

Darwin Road, London, London, W5 4BD

A spacious, newly converted three-bedroom split-level apartment on a quiet residential road in South Ealing, finished to a high standard. The property comprises three large double bedrooms, two contemporary bathrooms, an open-plan kitchen-dining room with a built-in breakfast bar, and a separate living room. The property also benefits from a private south-facing garden, high ceilings, fully fitted appliances, and is being sold with a share of the freehold.

The property is ideally located for transport and amenities, with South Ealing and Northfields underground stations (Piccadilly line) just a short walk away. There is a range of local shops, restaurants, and cafes en route via Northfield Avenue and South Ealing Road.



These particulars, whilst believed to be accurate are set out as a general outline only for guidance and do not constitute any part of an offer or contract. Intending purchasers should not rely on them as statements of representation of fact, but must satisfy themselves by inspection or otherwise as to their accuracy. No person in this firm's employment has the authority to make or give any representation or warranty in respect of the property.

181 Chiswick High Road, London, W4 2DR

Tel: 020 3946 6600 Email: chiswick@madisonbrook.com <https://madisonbrook.com/>

Floor Plan

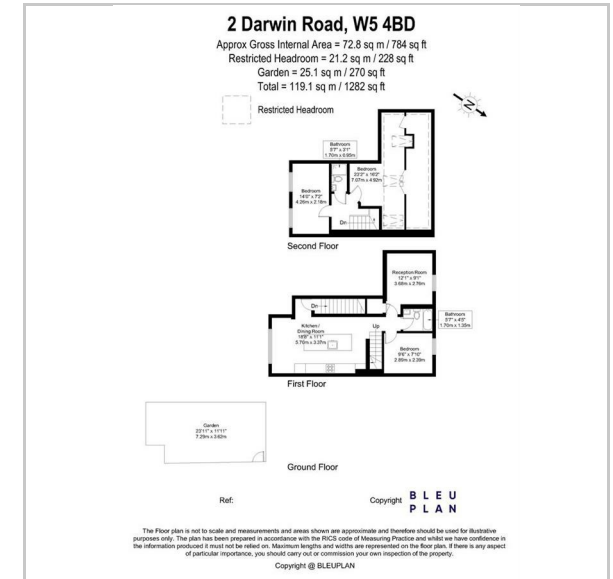

Area Map

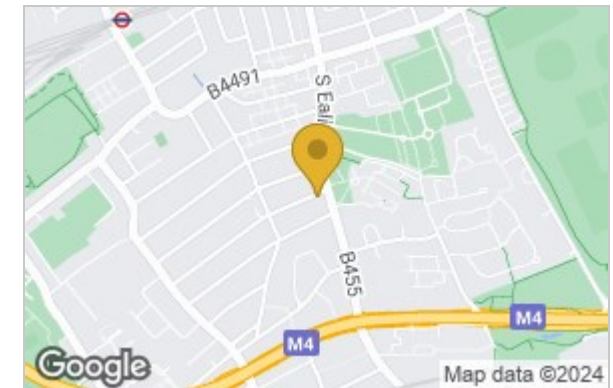

Energy Efficiency Graph

