



Maygrove Road

Maygrove Road, Camden, NW6 2EB

Asking Price £650,000



MADISON BROOK
INTERNATIONAL

Maygrove Road, Maygrove Road, Camden, NW6 2EB

A spacious three double bedroom apartment, located on the first and second floors of this period house.

Boasting 1,145 Sq. Ft of internal living space, this property offers a bright, airy and spacious living room with high ceilings throughout, a separate kitchen, three double bedrooms, two WC's and a family bathroom. Additionally, the property benefits from a south facing terrace to the rear of the property.

Maygrove Road is a residential road conveniently located to the shops, bars and restaurants of both West Hampstead and Kilburn High Road. There are multiple transport links nearby including the Jubilee line, Brondesbury Overground and Thameslink. Kilburn station is a only two minutes walk away.



Floor Plan

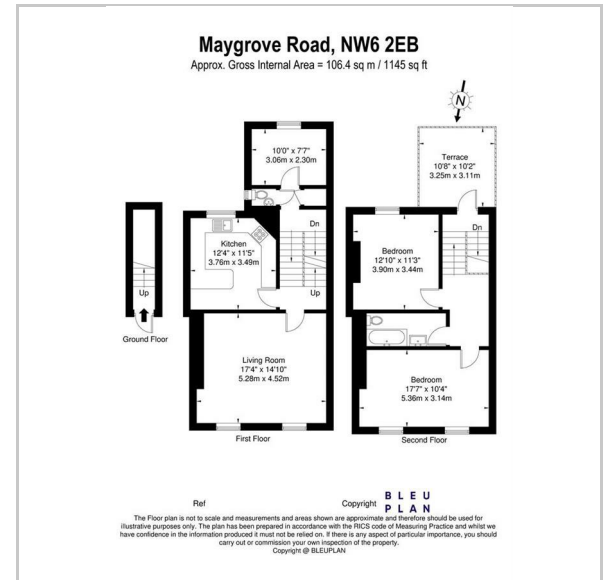

Area Map

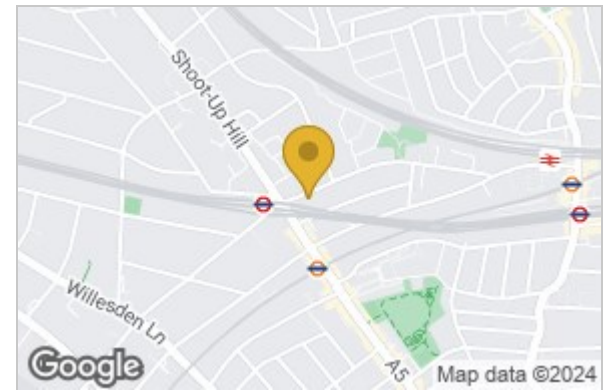

Energy Efficiency Graph

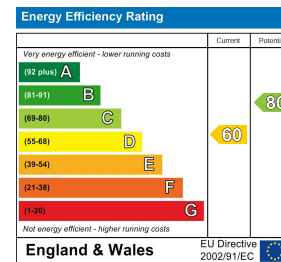

These particulars, whilst believed to be accurate are set out as a general outline only for guidance and do not constitute any part of an offer or contract. Intending purchasers should not rely on them as statements of representation of fact, but must satisfy themselves by inspection or otherwise as to their accuracy. No person in this firm's employment has the authority to make or give any representation or warranty in respect of the property.

181 Chiswick High Road, London, W4 2DR

Tel: 020 3946 6600 Email: chiswick@madisonbrook.com <https://madisonbrook.com/>