



India Way

Roehampton, London, SW15 5FE

Offers In The Region Of £1,150,000



MADISON BROOK
INTERNATIONAL

India Way, Roehampton, London, SW15 5FE

A spacious Four Bedroom Townhouse situated in a beautifully maintained development, presented in excellent condition.

The house provides a modern, quality finish along with generous proportions making it a superb choice for those looking for a larger space in a popular development. Comprising an entrance hall with nearby storage, interior access to substantial garage, utility room, open-plan kitchen with a range of modern wall and floor units and high-spec work-surfaces, leading to impressive concertina access to rear garden.

The first floor landing leads to the reception room with two sets of French doors leading to large decked terrace, well-sized master bedroom with ample storage, two Juliet balconies and en-suite bathroom. The second floor encompasses second bedroom with en-suite shower room, third and fourth bedrooms and family bathroom.

The property is located close to Roehampton Playing Fields, Queen Marys Hospital and is a short distance to Roehampton Gate for access.



These particulars, whilst believed to be accurate are set out as a general outline only for guidance and do not constitute any part of an offer or contract. Intending purchasers should not rely on them as statements of representation of fact, but must satisfy themselves by inspection or otherwise as to their accuracy. No person in this firm's employment has the authority to make or give any representation or warranty in respect of the property.

181 Chiswick High Road, London, W4 2DR
 Tel: 020 3946 6600 Email: chiswick@madisonbrook.com <https://madisonbrook.com/>

Floor Plan

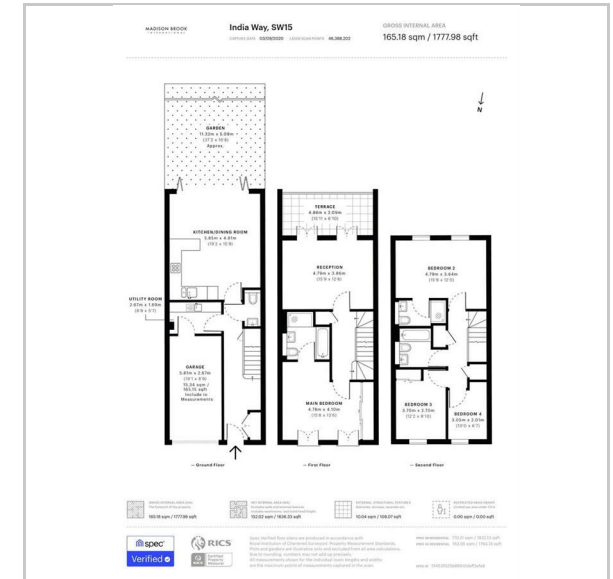

Area Map

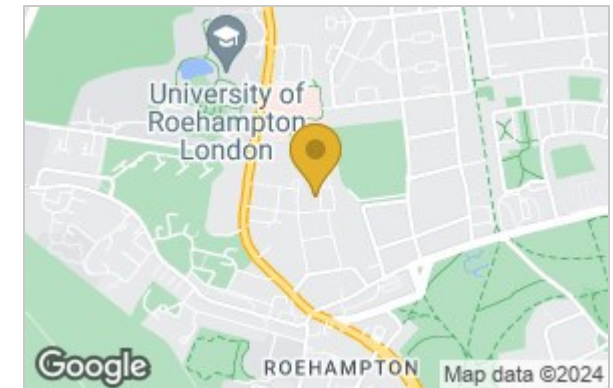

Energy Efficiency Graph

