



Napier House
Bromyard Avenue, London, W3 7FJ
Offers In Excess Of £400,000



MADISON BROOK
INTERNATIONAL

Napier House, Bromyard Avenue, London, W3 7FJ

A beautifully presented, modern, ground floor apartment in a prestigious gated development.

This apartment consists of two double bedrooms; principle with en suite, a modern family bathroom, open plan kitchen/living area and a large private balcony. The property also benefits from lift access, double glazing, ample storage space, and 24 hour concierge service.

Situated within a lovely gated development on a tree lined street and directly opposite the Virgin Active and Park Club health and leisure spas, moments from East Acton station and walking distance to Uxbridge road for bus links into Shepherds Bush and the Westfield shopping centre.



These particulars, whilst believed to be accurate are set out as a general outline only for guidance and do not constitute any part of an offer or contract. Intending purchasers should not rely on them as statements of representation of fact, but must satisfy themselves by inspection or otherwise as to their accuracy. No person in this firm's employment has the authority to make or give any representation or warranty in respect of the property.

181 Chiswick High Road, London, W4 2DR

Tel: 020 3946 6600 Email: chiswick@madisonbrook.com <https://madisonbrook.com/>

Floor Plan

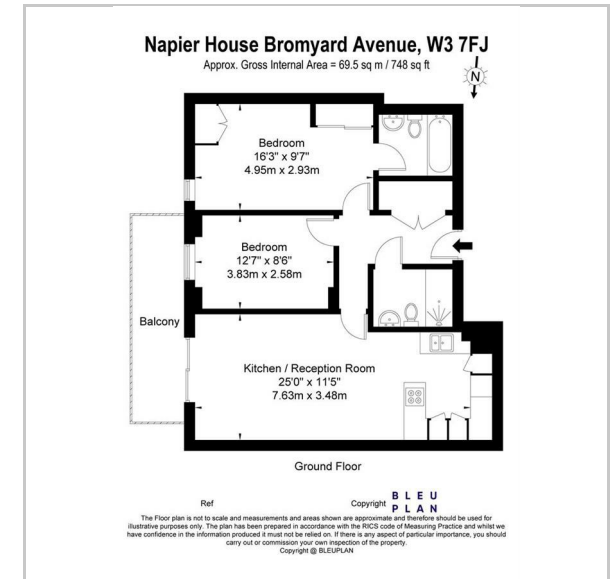

Area Map

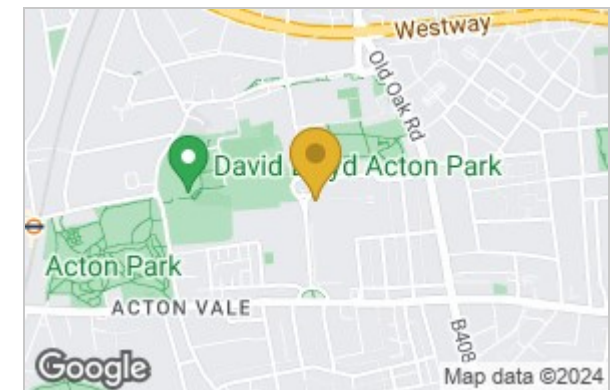

Energy Efficiency Graph

