

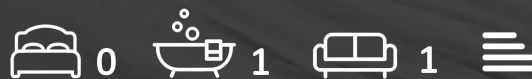

56 Askew Crescent
London, W12 9DW

Offers In The Region Of £169,000



MADISON BROOK
INTERNATIONAL

56 Askew Crescent, London, W12 9DW

This beautifully presented modern studio flat is located in a quiet residential street and would be perfect for a first time buyer or investor.

This property comprises of a newly refurbished studio room with an open-plan kitchen, a modern private bathroom as well as a large communal garden. The property has just had brand new double glazing windows installed throughout, as well as having a new roof installed. The property shall also be having the communal areas refurbished this year.

Located in an excellent location, this property offers many shops, restaurants and local amenities. Shepherds Bush Underground Stations (Hammersmith and City and Central lines) are nearby and the motorist will find easy access to the A40 (M) for routes in and out of London. The property is also within walking distance to the famous Shepherd's Bush Westfields.

If desired all furnishings can be included



These particulars, whilst believed to be accurate are set out as a general outline only for guidance and do not constitute any part of an offer or contract. Intending purchasers should not rely on them as statements of representation of fact, but must satisfy themselves by inspection or otherwise as to their accuracy. No person in this firms employment has the authority to make or give any representation or warranty in respect of the property.

181 Chiswick High Road, London, W4 2DR

Tel: 020 3946 6600 Email: chiswick@madisonbrook.com <https://madisonbrook.com/>

Floor Plan

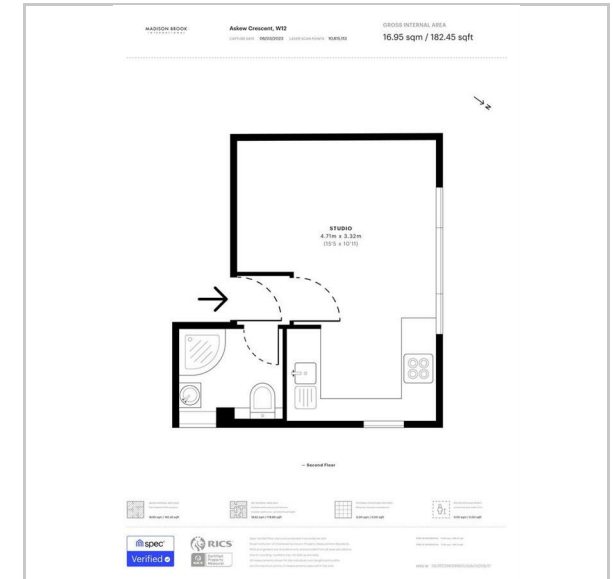

Area Map

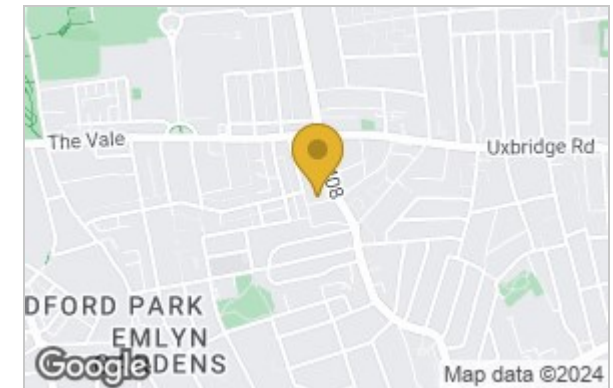

Energy Efficiency Graph

