



St. Thomas's Close, Nuneaton, CV10 8RQ

**SHELDON
BOSLEY
KNIGHT**

LAND AND
PROPERTY
PROFESSIONALS

Property Description

*** LOVELY SPOT, GOOD SIZED AND NO CHAIN *** Here is a modern detached residence occupying a lovely cul de sac location on the popular Churchdale Park, Stockingford area with allotments to the side and rear which was built by local and respected builders Cartwright Homes circa 1999.

The property is presented in good order throughout and offers spacious, extended family accommodation with gas fired central heating, upvc double glazing, security alarm, solar panels and is well placed as a family home with schools, shops, clubs, pubs, supermarkets all nearby.

Briefly comprising: through hallway, guests cloakroom, lounge with feature fireplace, dining area, upvc double glazed conservatory, refitted breakfast kitchen with range style cooker, extended utility / lobby, landing, four good sized bedrooms, ensuite shower room and family bathroom. Driveway for several vehicles, integral garage and westerly facing rear garden. EPC RATING TBC.





Key Features

- Modern detached residence
- Lovely tucked away cul de sac location
- Cartwright Homes built 1999
- Improved, extended & well presented
- Lounge, diner, kitchen & conservatory
- Four bedrooms, ensuite & bathroom
- Large driveway, garage & gardens
- EPC RATING TBC

£335,000

EPC Rating - B

Tenure - Freehold

Council Tax Band - D

Local Authority -
NBBC

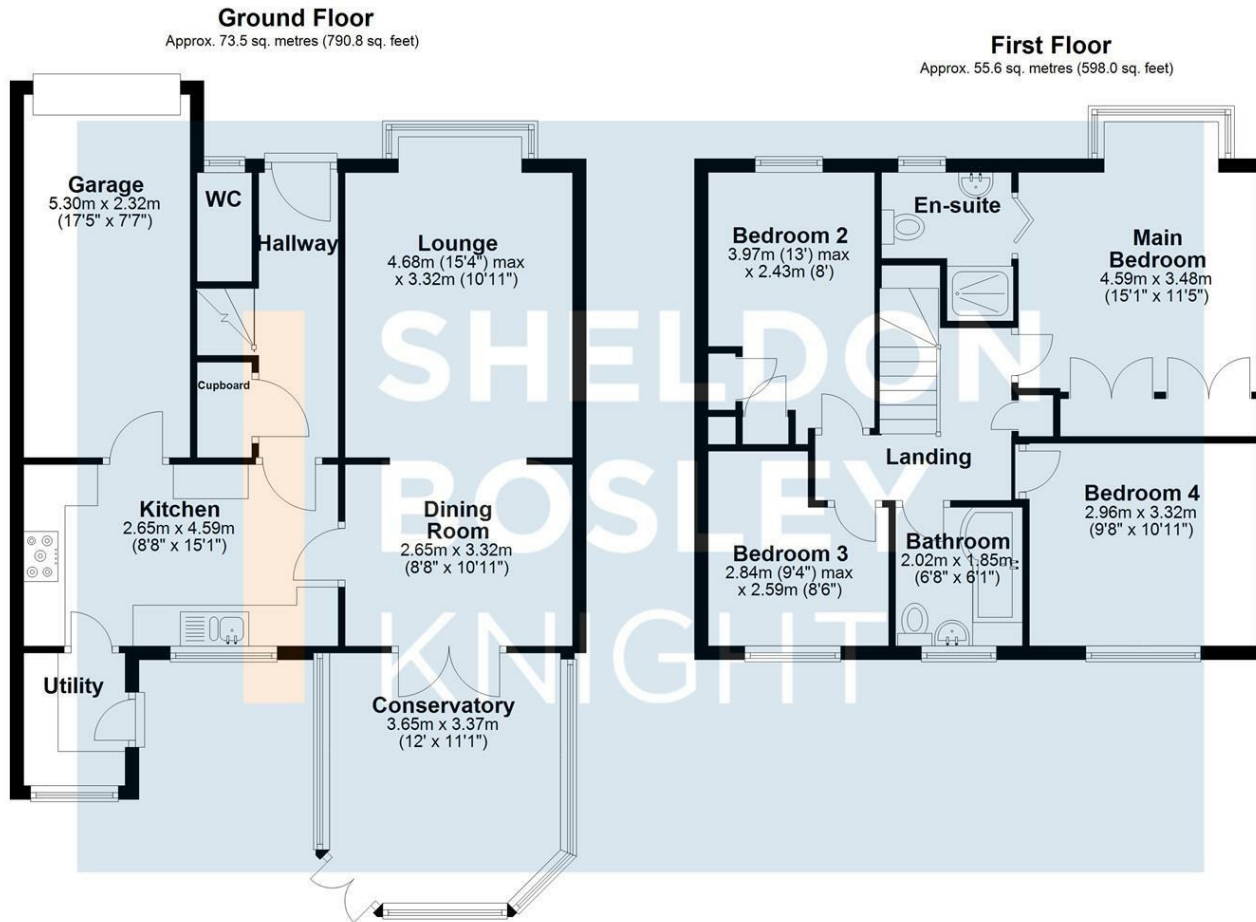

Total area: approx. 129.0 sq. metres (1388.8 sq. feet)

All efforts have been made to ensure that the measurements on this floorplan are accurate however these are for guidance purposes only.
Plan produced using PlanUp.

We routinely refer clients to both our recommended Legal Firm and a panel of Financial Services Providers. It is your decision whether you choose to deal with these companies. In making that decision, you should know that we receive a referral fee