



**Beechwood Road, Bedworth, CV12 9AQ**

**SHELDON  
BOSLEY  
KNIGHT**

LAND AND  
PROPERTY  
PROFESSIONALS



# Property Description

\*\*\*NO ONWARD CHAIN\*\*\*

We are delighted to present this three bedroom, end terrace home for sale. Situated on Beechwood Road, Bedworth which is close by to local schools, transport links and Bedworth Town. With potential to extend (STPP) this property also offers no onward chain making it ideal for first time buyers, investors or anyone needing to end their current chain.

Briefly comprising; Entrance hall, lounge, kitchen/dining room, three well proportioned bedrooms and shower room. The exterior has a lawn to the front, side access and rear garden with outside W/C, storage and workshop space.

The gas fired central heating and double glazed windows, this home must be seen to be appreciated. On street parking, viewing is advised. Call us now for more information. COUNCIL TAX BAND B & EPC RATING C.







## Key Features

- No Onward Chain
- Three Bedrooms
- End Terraced Home
- Potential To Extend (STPP)
- Front & Rear Gardens
- Close By To Bedworth Town
- Close by To Schools
- COUNCIL TAX BAND B & EPC RATING D

**£220,000**







### Ground Floor

Approx. 48.9 sq. metres (526.6 sq. feet)

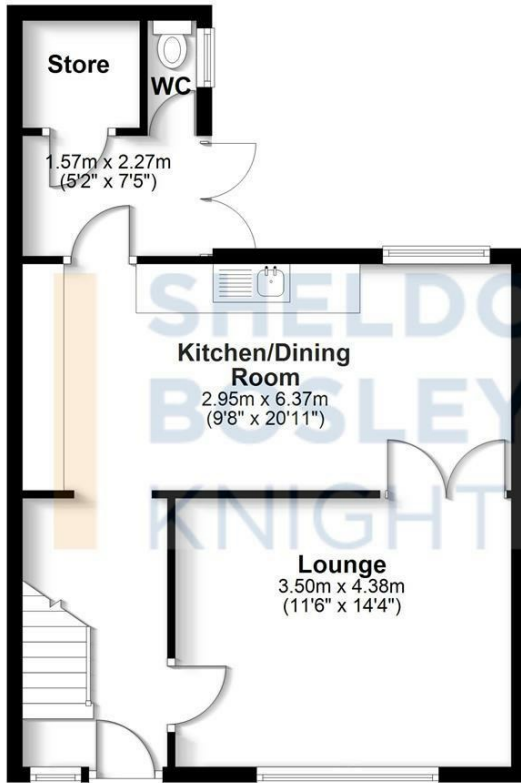

### First Floor

Approx. 41.1 sq. metres (442.5 sq. feet)

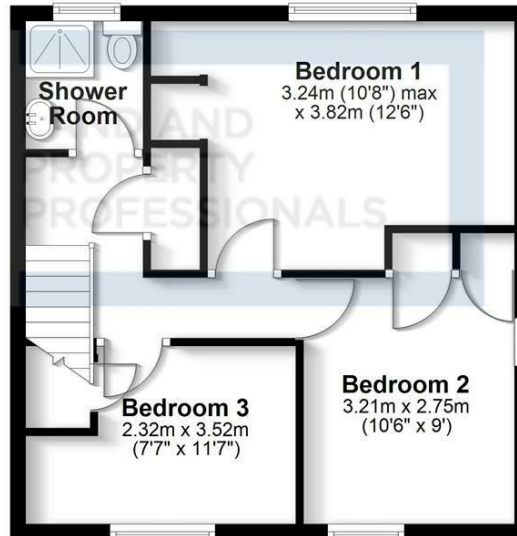

Total area: approx. 90.0 sq. metres (969.0 sq. feet)

All efforts have been made to ensure the measurements are accurate on this floor plan, however these are for guidance purposes only.

Plan produced using PlanUp.



EPC Rating - C

Tenure - Freehold

Council Tax Band - B

Local Authority  
NBBC





We routinely refer clients to both our recommended legal firm and a panel of financial services providers. It is your decision whether you choose to deal with these companies. In making that decision, you should know that we receive a referral fee.

**SHELDON  
BOSLEY  
KNIGHT**

LAND AND  
PROPERTY  
PROFESSIONALS