



The Waterfront, Coventry, CV7 9JH

**SHELDON
BOSLEY
KNIGHT**

LAND AND
PROPERTY
PROFESSIONALS

Property Description

50% SHARED OWNERSHIP

Sheldon Bosley Knight are delighted to welcome to market this well positioned two bedroom apartment situated at The Waterfront, Exhall, Coventry, overlooking the Black Bank Pool. This property is well presented throughout, offering excellent transport links and close to local shops and schools. In brief via the communal entrance the home comprises of an entrance hall, lounge/diner, kitchen, two bedrooms and a bathroom. To the rear of the apartment is an allocated parking space for a single vehicle. This property would make an excellent first time buy or buy to let investment, viewings are essential, via the agent. COUNCIL TAX BAND A - EPC TBC

Available 50% shared ownership or 100% - monthly charges will vary accordingly.





Key Features

**50% Shared
Ownership
£65,000**



Ground Floor

Approx. 50.2 sq. metres (540.8 sq. feet)

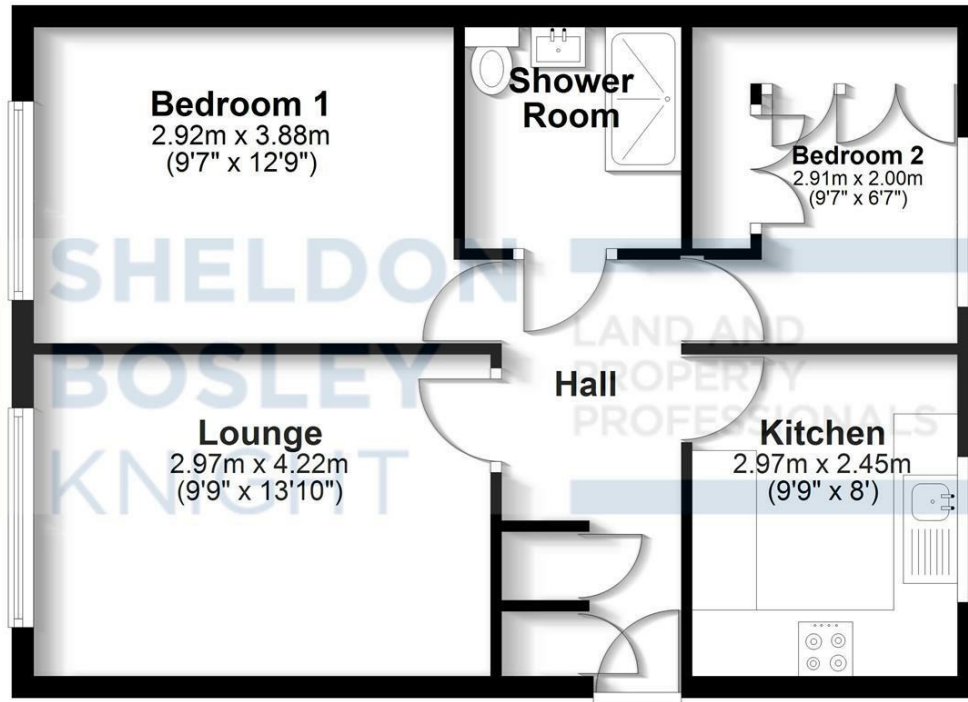

Total area: approx. 50.2 sq. metres (540.8 sq. feet)

All efforts have been made to ensure the measurements are accurate on this floor plan, however these are for guidance purposes only.
Plan produced using PlanUp.



EPC Rating -

Tenure - Leasehold

Council Tax Band - A

Local Authority
Nuneaton & Bedworth Borough Council



We routinely refer clients to both our recommended legal firm and a panel of financial services providers. It is your decision whether you choose to deal with these companies. In making that decision, you should know that we receive a referral fee.

**SHELDON
BOSLEY
KNIGHT**

LAND AND
PROPERTY
PROFESSIONALS