



Weavers Close, Bulkington, CV12 9NS

**SHELDON
BOSLEY
KNIGHT**

LAND AND
PROPERTY
PROFESSIONALS

Property Description

* NO UPWARD CHAIN * Sheldon Bosley Knight are pleased to offer for sale this two bedroom first floor apartment on Weavers Close, in the ever popular village of Bulkington, situated within walking distance to the village and also Bedworth town centre. In brief the property comprises of an entrance hall with store, lounge, kitchen, two bedrooms and a bathroom, benefitting from gas central heating and double glazing throughout and offered with no upward chain and allocated parking to rear. Viewings are strictly via the agent. COUNCIL TAX BAND A - EPC C





Key Features

- TWO BEDROOM FIRST FLOOR APARTMENT
- ALLOCATED PARKING TO REAR
- LOUNGE - KITCHEN
- BATHROOM
- NO UPWARD CHAIN
- VILLAGE LOCATION
- LEASEHOLD - COUNCIL TAX BAND A - EPC C

£135,000



Ground Floor

Approx. 58.8 sq. metres (633.3 sq. feet)

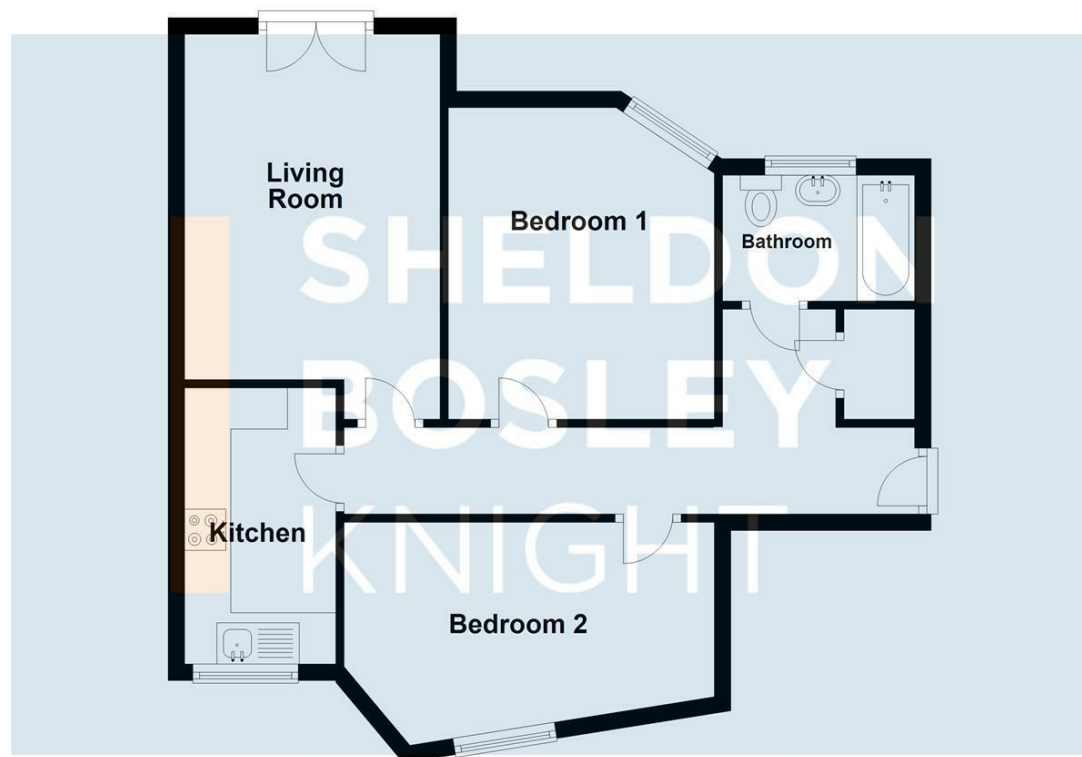

Total area: approx. 58.8 sq. metres (633.3 sq. feet)

All efforts have been made to ensure that the measurements on this floorplan are accurate however these are for guidance purposes only.
Plan produced using PlanUp.



EPC Rating - C

Tenure - Leasehold

Council Tax Band - A

Local Authority
Nuneaton & Bedworth



We routinely refer clients to both our recommended legal firm and a panel of financial services providers. It is your decision whether you choose to deal with these companies. In making that decision, you should know that we receive a referral fee.

**SHELDON
BOSLEY
KNIGHT**

LAND AND
PROPERTY
PROFESSIONALS