



The Waterways, Coventry, CV6 6NA

**SHELDON
BOSLEY
KNIGHT**

LAND AND
PROPERTY
PROFESSIONALS

Property Description

Welcome To The Waterways

Looking for your first home? Are you looking for something you just need to drop your furniture in? The Waterways could be the home for you! With it's NHBC guarantee still valid, this modern property offers a great choice for first time buyers or anybody looking for a stylish two bed.

Briefly comprising; Lounge, cloakroom, kitchen, two bedrooms, family bathroom, off road parking and front lawn, and rear garden space.

With gas fired central heating, double glazed windows, and in a sought after location close by to local schools, amenities and transport links - you don't want to miss out on this one! Call us now for more information or to book a viewing. EPC RATING B





Key Features

- Well Presented Semi-Detached Home
- Two Double Bedrooms
- Off Road Parking
- Front & Rear Gardens
- NHBC Guarantee
- Sought After Location
- Ideal First Time Purchase
- EPC RATING B

£220,000



Ground Floor

Approx. 32.8 sq. metres (353.3 sq. feet)

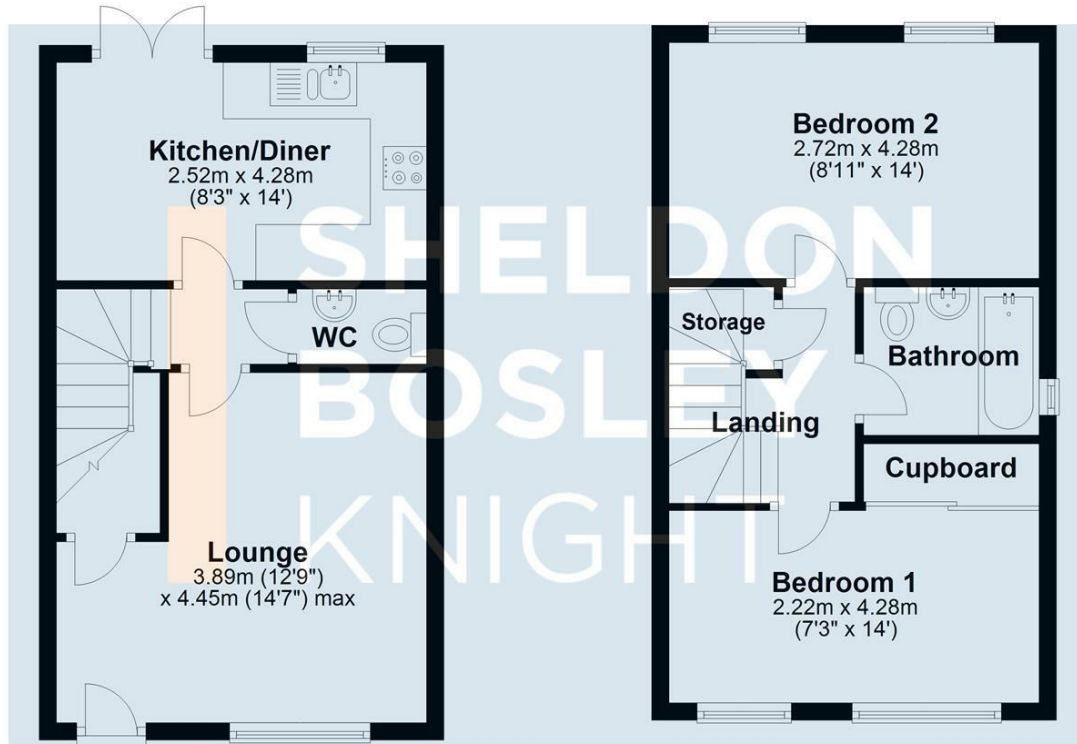

First Floor

Approx. 32.6 sq. metres (351.0 sq. feet)

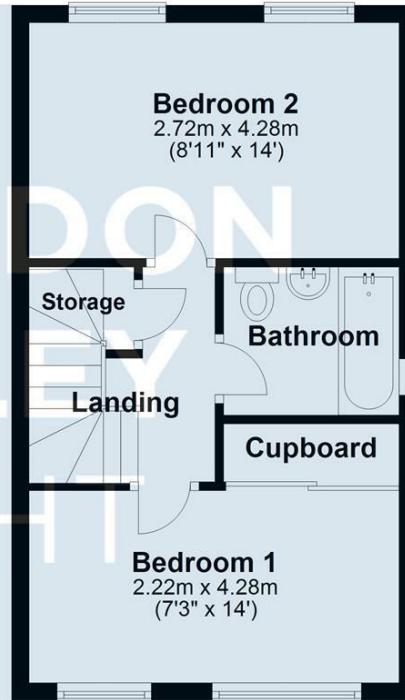

Total area: approx. 65.4 sq. metres (704.2 sq. feet)

All efforts have been made to ensure that the measurements on this floorplan are accurate however these are for guidance purposes only.
Plan produced using PlanUp.



EPC Rating - B

Tenure - Freehold

Council Tax Band - B

Local Authority
CCC



We routinely refer clients to both our recommended legal firm and a panel of financial services providers. It is your decision whether you choose to deal with these companies. In making that decision, you should know that we receive a referral fee.

**SHELDON
BOSLEY
KNIGHT**

LAND AND
PROPERTY
PROFESSIONALS