



New Street, Bedworth, CV12 9DL

**SHELDON
BOSLEY
KNIGHT**

LAND AND
PROPERTY
PROFESSIONALS

Property Description

***Buy to Let Investors and First Time Buyers - No Upward Chain ***

Sheldon Bosley Knight are pleased to offer for sale this spacious two bedroom second floor apartment at New Street, Bedworth. Accommodation in brief; communal ground floor entrance, hallway, two bedrooms, bathroom, fitted kitchen, and spacious lounge/diner. Also benefiting from UPVC double glazing, electric heating, and allocated parking. EPC Rating B. Council Tax Banding A.





Key Features

- 2nd Floor Flat - No Upward Chain
- Two Bedrooms
- Allocated Parking
- Close By To Local Amenities
- Close By To Local Schools
- No Upward Chain
- Ideal First Time Purchase Or Investment
- EPC RATING C

£119,950



Ground Floor

Approx. 52.1 sq. metres (560.3 sq. feet)

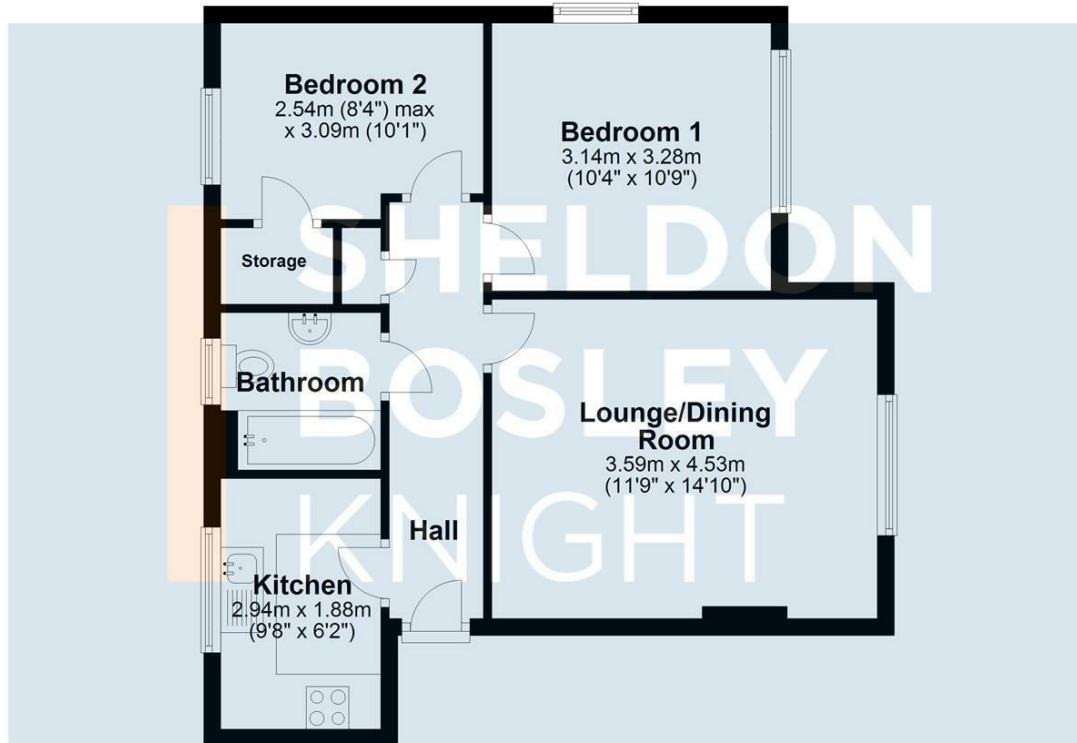

Total area: approx. 52.1 sq. metres (560.3 sq. feet)

All efforts have been made to ensure that the measurements on this floorplan are accurate however these are for guidance purposes only.
Plan produced using PlanUp.



EPC Rating - C

Tenure - Leasehold

Council Tax Band - A

Local Authority
NBBC



We routinely refer clients to both our recommended legal firm and a panel of financial services providers. It is your decision whether you choose to deal with these companies. In making that decision, you should know that we receive a referral fee.

**SHELDON
BOSLEY
KNIGHT**

LAND AND
PROPERTY
PROFESSIONALS