



Nuneaton Road, Bedworth, CV12 9QW

**SHELDON  
BOSLEY  
KNIGHT**

LAND AND  
PROPERTY  
PROFESSIONALS

# Property Description

**\*\*RARE OPPORTUNITY IN A PRIME LOCATION\*\*** In brief - Detached dormer bungalow, three bedrooms, lounge, double family room, dining room, kitchen, bathroom, hall with W.C off, outside garage and mature gardens, gas fired heating. Tax Band F, EPC commissioned





## Key Features

- DETACHED DORMER BUNGALOW
- PRIME LOCATION
- THREE BEDROOMS
- LOUNGE
- DINING ROOM
- FAMILY ROOM X 2
- KITCHEN
- HALL WITH W.C OFF
- MATURE GARDENS /GARAGE
- EPC COMMISSIONED TAX BAND F

**£475,000**



**Ground Floor**  
Approx. 152.2 sq. metres (1637.9 sq. feet)

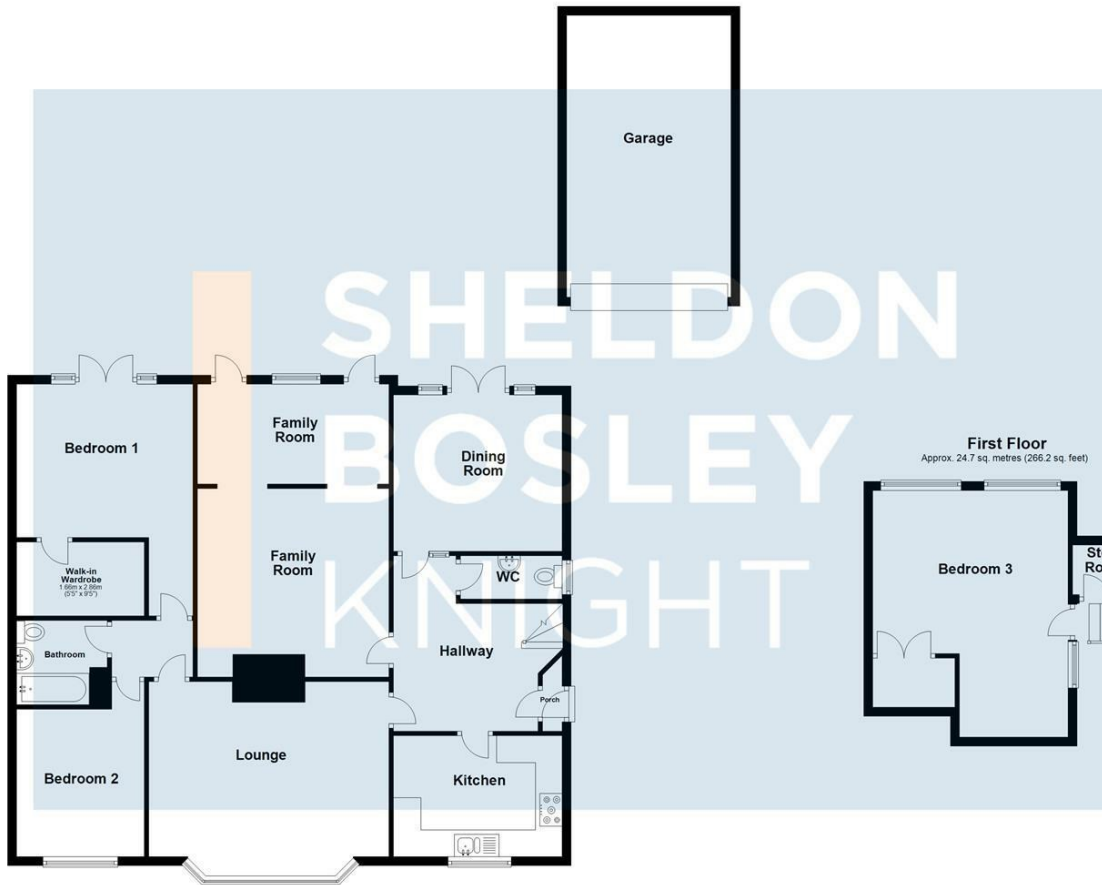

**Total area: approx. 176.9 sq. metres (1904.1 sq. feet)**

All efforts have been made to ensure that the measurements on this floorplan are accurate however these are for guidance purposes only.  
Plan produced using PlanUp.



EPC Rating -

Tenure - Freehold

Council Tax Band - F

Local Authority  
Nuneaton and Bedworth



We routinely refer clients to both our recommended legal firm and a panel of financial services providers. It is your decision whether you choose to deal with these companies. In making that decision, you should know that we receive a referral fee.

**SHELDON  
BOSLEY  
KNIGHT**

LAND AND  
PROPERTY  
PROFESSIONALS