



Woodford Close, Coventry, CV7 9HQ

Property Description

TWO BEDROOM SEMI DETACHED BUNGALOWOFFERED WITH NO UPWARD CHAIN***

Sheldon Bosley Knight welcome for sale this two bedroom semi detached bungalow on Woodford Close, Ash Green, Coventry, situated on a quiet cul de sac, close to local shops and offering excellent transport links, this property comprises of a entrance hall, two bedrooms, shower room, kitchen/breakfast room, living room, and conservatory. Also benefiting from UPVC double glazing, gas central heating, shared block paved driveway, single garage, and low maintenance rear garden which is not overlooked. The property also benefits from Solar Panels. EPC Rating C. Council Tax Banding B.





Key Features

- NO UPWARD CHAIN - CUL DE SAC LOCATION
- TWO BEDROOM SEMI DETACHED BUNGALOW
- GARAGE & DRIVEWAY
- LOUNGE - KITCHEN - CONSERVATORY
- WET ROOM
- SOLAR PANELS - DOUBLE GLAZING - GAS CENTRAL HEATING
- FREEHOLD - COUNCIL TAX BAND B - EPC C

**Offers In The Region
Of
£220,000**



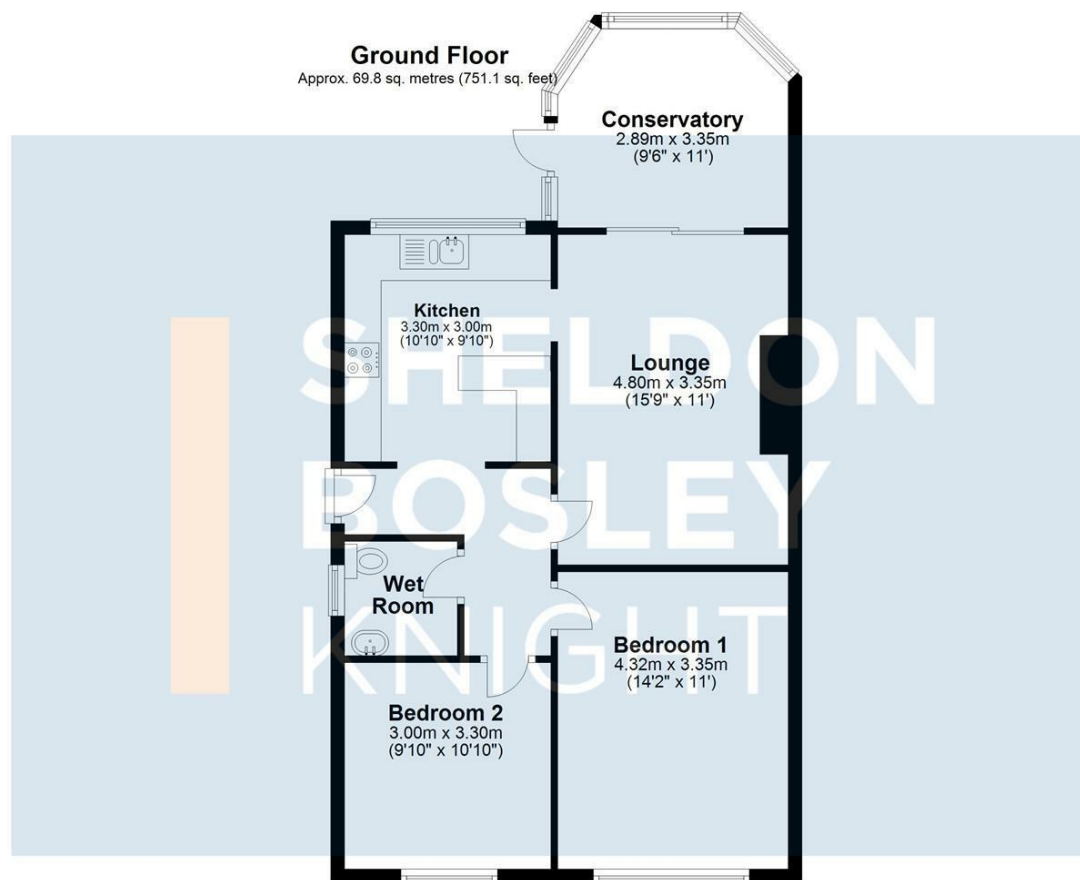

Total area: approx. 69.8 sq. metres (751.1 sq. feet)

All efforts have been made to ensure that the measurements on this floorplan are accurate however these are for guidance purposes only.
Plan produced using PlanUp.



EPC Rating - C

Tenure - Freehold

Council Tax Band - B

Local Authority
Nuneaton & Bedworth Borough Council



We routinely refer clients to both our recommended legal firm and a panel of financial services providers. It is your decision whether you choose to deal with these companies. In making that decision, you should know that we receive a referral fee.

**SHELDON
BOSLEY
KNIGHT**

LAND AND
PROPERTY
PROFESSIONALS