



Woodford Close, Coventry, CV7 9HQ

**SHELDON  
BOSLEY  
KNIGHT** LAND AND  
PROPERTY  
PROFESSIONALS



# Property Description

\*\*\*TWO BEDROOM SEMI DETACHED BUNGALOW\*\*\* OFFERED WITH NO UPWARD CHAIN\*\*\*

Sheldon Bosley Knight welcome for sale this two bedroom semi detached bungalow on Woodford Close, Ash Green, Coventry, situated on a quiet cul de sac, close to local shops and offering excellent transport links, this property comprises of a entrance hall, two bedrooms, shower room, kitchen/breakfast room, living room, and conservatory. Also benefiting from UPVC double glazing, gas central heating, shared block paved driveway, single garage, and low maintenance rear garden which is not overlooked. The property also benefits from Solar Panels. EPC Rating D. Council Tax Banding B.







## Key Features

- Semi Detached Bungalow
- Offered With No Upward Chain
- Two Bedrooms & Shower Room
- Kitchen/Breakfast Room
- Living Room & Conservatory
- Block Paved Shared Driveway & Garage
- Solar Panels
- Freehold - EPC Rating D - Council Tax Banding B

**£220,000**







## GROUND FLOOR

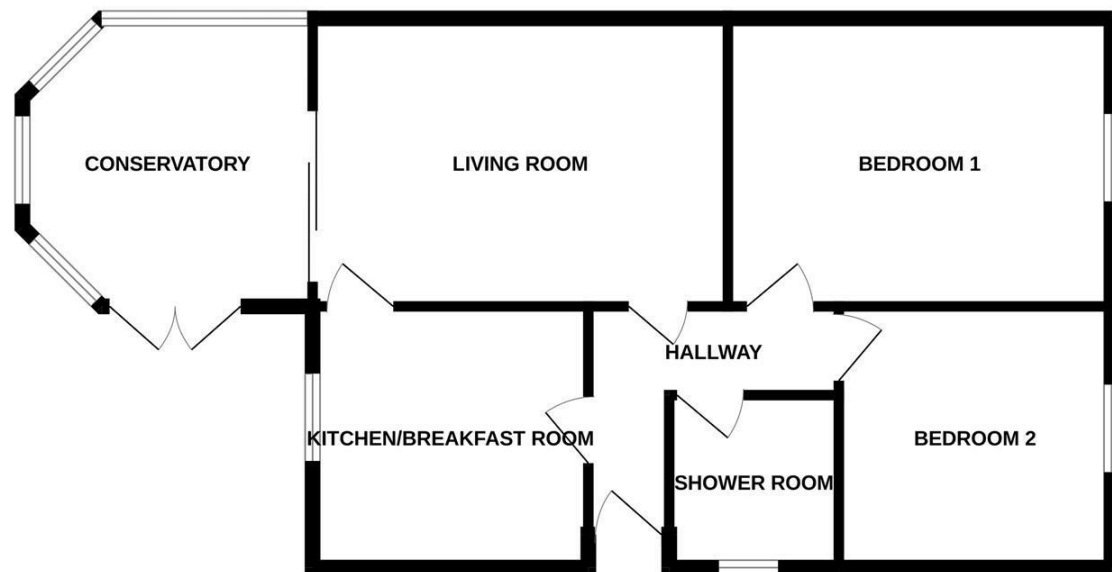

This floor plan is not to scale and is for guidance purposes only  
Made with Metropix ©2024



EPC Rating - D

Tenure - Freehold

Council Tax Band - B

Local Authority  
Nuneaton & Bedworth Borough Council



We routinely refer clients to both our recommended legal firm and a panel of financial services providers. It is your decision whether you choose to deal with these companies. In making that decision, you should know that we receive a referral fee.

**SHELDON  
BOSLEY  
KNIGHT**

LAND AND  
PROPERTY  
PROFESSIONALS