



SARA MORTON

BESPOKE REAL ESTATE AGENT



35 Cromwell Road

, Feltham, TW13 5AS

£500,000

A three bedroom detached period property located in a sought after road in Feltham just moments from the high street and station.

The accommodation consists of entrance hall, two reception rooms and kitchen on the ground floor. The first floor offers three double bedrooms and family bathroom. There is a good size private rear garden with new paving, lawn and two storage sheds.

The property benefits from a new boiler and central heating system, however it is in need of some modernising internally. Externally the current owners have made some recent improvements including new roof, triple glazed windows and doors, paving and front wall. There is potential to extend to the rear and into the loft giving the opportunity to make this a large family home.

Further benefits include close proximity to popular schools and recreation areas such as Hanworth Park and Hounslow Heath. The A316, M3, M4 and M25 are all well placed as is Heathrow airport.

Viewings by appointment only

Council tax band D Hounslow council

- Detached period property
- Three double bedrooms
- Two reception rooms
- Potential to extend
- New triple glazed windows and doors
- Close to Feltham station
- New boiler and central heating system
- In need of modernisation

Viewing

Please contact our Sales Office on 0208 181 9660 if you wish to arrange a viewing appointment for this property or require further information.



3



1

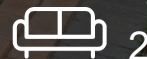

2



D

Floor Plan

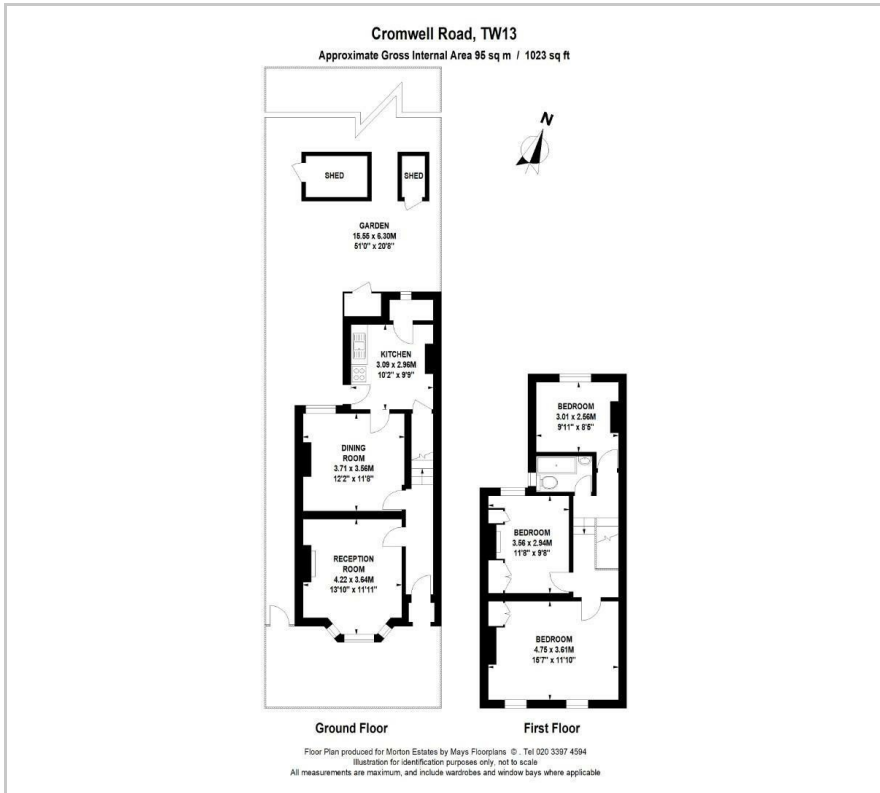

Area Map



Energy Efficiency Graph

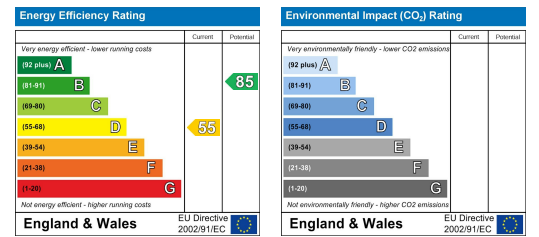

These particulars, whilst believed to be accurate are set out as a general outline only for guidance and do not constitute any part of an offer or contract. Intending purchasers should not rely on them as statements of representation of fact, but must satisfy themselves by inspection or otherwise as to their accuracy. No person in this firm's employment has the authority to make or give any representation or warranty in respect of the property.

27 Old Gloucester Street, London, WC1N 3AX

Tel: 0208 181 9660 Email: sara@mortonestates.com <https://www.saramortonrealestate.co.uk>