

27 Barden Court

St. Lukes Avenue, Maidstone, Kent, ME14 5AP



PRICE: £147,000

Lease: 125 years from 1995

Property Description:

ONE BEDROOM SECOND FLOOR RETIREMENT APARTMENT

Barden Court was constructed by McCarthy & Stone (Developments) Ltd and comprises 37 properties arranged over 3 floors each served by lift. The Development Manager can be contacted from various points within each property in the case of an emergency. For periods when the Development Manager is off duty there is a 24 hour Appello call system.

Each property comprises an entrance hall, lounge, kitchen, one or two bedrooms and bathroom. It is a condition of purchase that residents be over the age of 60 years. Please speak to our Property Consultant if you require information regarding "Event Fees" that may apply to this property.

- Residents' lounge and Guest Suite
- Communal Laundry
- 24 hour Appello emergency call system
- Communal Satellite Dish (additional fees apply)
- Lift to all floors and CCTV door entry
- Communal gardens and residents car park
- Minimum Age 60
- Lease: 125 years from 1995



**For more details or to make an appointment to view, please contact
Mandy Bolwell**

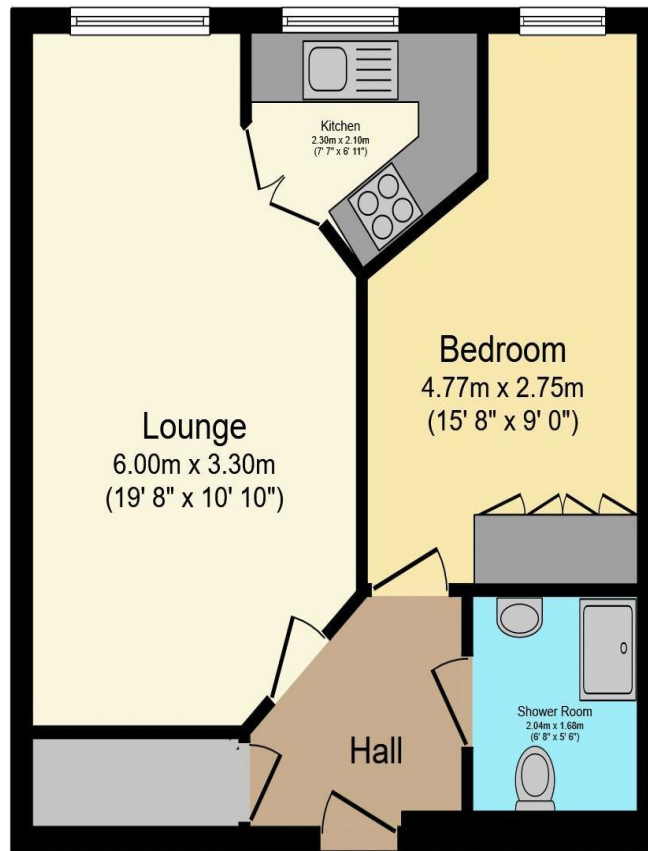

Total floor area 42.2 m² (455 sq.ft.) approx

This floor plan is for illustrative purposes only. It is not drawn to scale. Any measurements, floor areas (including any total floor area), openings and orientation are approximate. No details are guaranteed, they cannot be relied upon for any purpose and they do not form part of any agreement. No liability is taken for any error, omission or misstatement. A party must rely upon its own inspection(s).
Powered by www.focalagent.com

Score	Energy rating	Current	Potential
92+	A		
81-91	B		82 B
69-80	C	80 C	
55-68	D		
39-54	E		
21-38	F		
1-20	G		

For Financial Year Ending:

31/08/2025

Annual Ground Rent:

£514.14

Ground Rent Period Review:

2039

Annual Service Charge:

£3,405.10

Council Tax Band:

D

Event Fees:

**1% Transfer
1% Contingency**

Retirement Homesearch, Queensway House, 11 Queensway, New Milton, Hampshire, BH25 5NR
T: 0333 321 4060 F: 0333 321 4065 E: enquiries@retirementhomesearch.co.uk

Retirement Homesearch Limited, Registered Office:
Queensway House, 11 Queensway, New Milton, Hampshire, BH25 5NR
Registered in England No. 3829469



These sales particulars have been prepared as a guide only and any intended purchasers must satisfy themselves by inspection or otherwise as to the correctness of the statements contained therein. The management company have not tested any apparatus, equipment, fittings or services and so cannot verify that they are in working order.