

19 Montague Lodge

95 Rectory Road, Beckenham, Kent, BR3 1XF



PRICE: £120,000

Lease: 99 years from 1987

Property Description:

A RECARPETED ONE BEDROOM RETIREMENT APARTMENT SITUATED AT THE BACK OF THE DEVELOPMENT ON THE FIRST FLOOR. This Development has 33 flats over 3 floors. The main features of the development are as follows. Residents lounge. Laundry, Lift, development manager, Guest suite. And for peace of mind each flat is connected to Appello which can be used 24 hours a day. There are communal gardens for the residents to enjoy. There are shops and amenities at hand. It is a condition of purchase that residents be of at least state pensionable age. Please speak to our Property Consultant if you require information regarding "Event Fees" that may apply to this property.

Communal gardens
Guest suite
Laundry
Shops & amenities at hand
Connected to the Appello call system

Development manager
Residents lounge
Lease : 99 years from 1987
Service Charge £4,326.81 Ground Rent
£225.00



**For more details or to make an appointment to view, please contact
Mandy Bolwell**

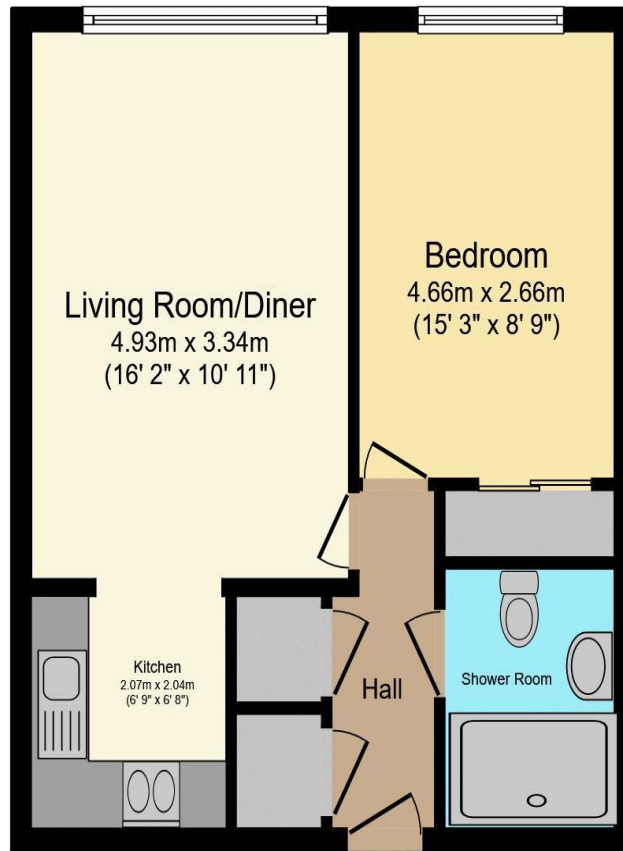

Total floor area 43.3 sq.m. (466 sq.ft.) approx

This floor plan is for illustrative purposes only. It is not drawn to scale. Any measurements, floor areas (including any total floor area), openings and orientation are approximate. No details are guaranteed, they cannot be relied upon for any purpose and they do not form part of any agreement. No liability is taken for any error, omission or misstatement. A party must rely upon its own inspection(s).
Powered by www.focalagent.com

Score	Energy rating	Current	Potential
92+	A		
81-91	B		
69-80	C	77 C	80 C
55-68	D		
39-54	E		
21-38	F		
1-20	G		

For Financial Year Ending:

31/3/25

Annual Ground Rent:

£225.00

Ground Rent Period Review:

2037

Annual Service Charge:

£4,326.81

Council Tax Band:

C

Event Fees:

0% Transfer

0% Contingency

Retirement Homesearch, Queensway House, 11 Queensway, New Milton, Hampshire, BH25 5NR
T: 0333 321 4060 F: 0333 321 4065 E: enquiries@retirementhomesearch.co.uk

Retirement Homesearch Limited, Registered Office:
Queensway House, 11 Queensway, New Milton, Hampshire, BH25 5NR
Registered in England No. 3829469



These sales particulars have been prepared as a guide only and any intended purchasers must satisfy themselves by inspection or otherwise as to the correctness of the statements contained therein. The management company have not tested any apparatus, equipment, fittings or services and so cannot verify that they are in working order.