

**27 Friars Mews**

**Eltham, Eltham, London, SE9 1HR**



**PRICE: £375,000**

**Lease: 189 years from 1986**

**Property Description:**

**A WELL-PRESENTED GROUND FLOOR TWO BEDROOM APARTMENT OVERLOOKING GARDENS AND BENEFITTING FROM A LEASE EXTENSION**

Friars Mews is managed by Anchor and comprises of Bungalows and apartments. There is a 24-hour Anchor call system in Each Flat and in the communal areas. The development is well laid out to achieve optimum privacy.

It is a condition of purchase that residents be over the age of 60 years. Please speak to our property Consultant if you require information regarding 'Fees' that may apply to this property.

Estate Manager  
Communal Laundry  
Communal gardens  
24 Anchor Call System  
Communal Car Park

Minimum Age 60  
Lease: 189 years from 1986  
Service Charge £2821.08 Ground Rent NA



**For more details or to make an appointment to view, please contact  
Mandy Bolwell**

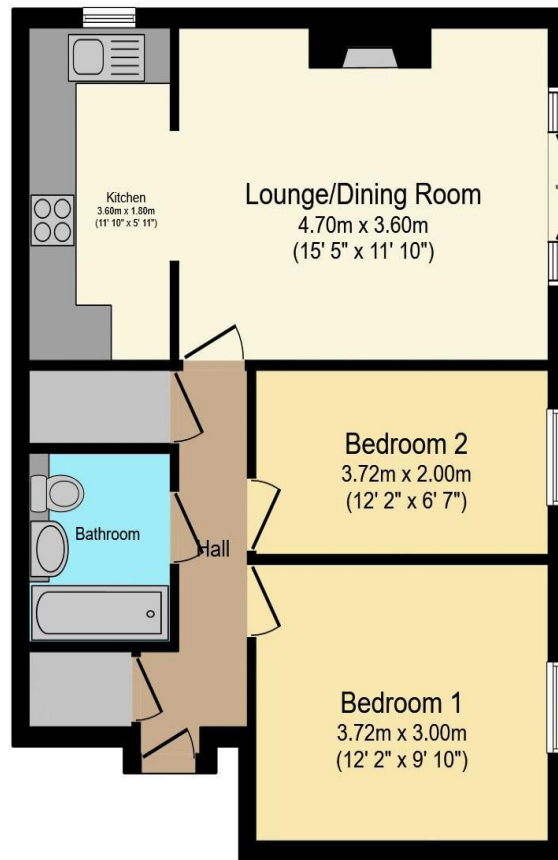

Total floor area 54.7 m<sup>2</sup> (589 sq.ft.) approx

This floor plan is for illustrative purposes only. It is not drawn to scale. Any measurements, floor areas (including any total floor area), openings and orientation are approximate. No details are guaranteed, they cannot be relied upon for any purpose and they do not form part of any agreement. No liability is taken for any error, omission or misstatement. A party must rely upon its own inspection(s).  
Powered by www.focalagent.com

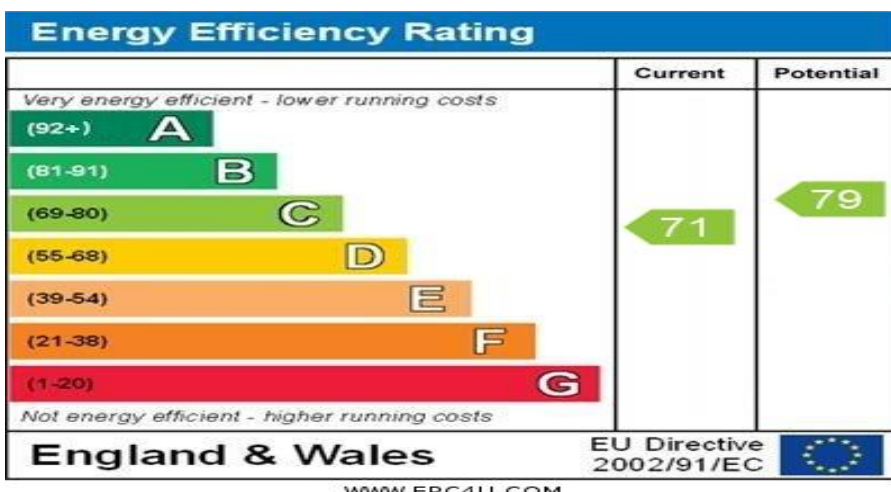

For Financial Year Ending:

31/03/25

Annual Ground Rent:

£NA

Ground Rent Period Review:

NA

Annual Service Charge:

£2821.08

Council Tax Band:

C

Event Fees:

0.00 Transfer

0.00 Contingency

Retirement Homesearch, Queensway House, 11 Queensway, New Milton, Hampshire, BH25 5NR  
T: 0333 321 4060 F: 0333 321 4065 E: enquiries@retirementhomesearch.co.uk

Retirement Homesearch Limited, Registered Office:  
Queensway House, 11 Queensway, New Milton, Hampshire, BH25 5NR  
Registered in England No. 3829469



These sales particulars have been prepared as a guide only and any intended purchasers must satisfy themselves by inspection or otherwise as to the correctness of the statements contained therein. The management company have not tested any apparatus, equipment, fittings or services and so cannot verify that they are in working order.