

31 Westwood Court (Enfield)

96-98 Village Road, Enfield, Middlesex, EN1 2HQ



**PRICE: Offers in the region of
£160,000**

Lease: 125 years from 1989

Property Description:

A ONE BEDROOM RETIREMENT APARTMENT LOCATED ON THE SECOND FLOOR WITH BALCONY AND GARDEN VIEWS

Westwood Court was constructed by McCarthy & Stone (Developments) Ltd and comprises 31 properties arranged over 3 floors each served by lift. The Development Manager can be contacted from various points within each property in the case of an emergency. For periods when the Development Manager is off duty there is a 24-hour emergency Appello call system. Each property comprises an entrance hall, lounge, kitchen, one or two bedrooms and bathroom. It is a condition of purchase that single residents be over the age of 60 years, or in the event of a couple, one must be over the age of 60 years and the other over 55 years. Please speak to our Property Consultant if you require information regarding Event Fees that may apply to this property.

- Residents' lounge
- Communal Laundry
- 24 hour emergency Appello call system
- Minimum Age 60
- Development Manager
- Guest Suite
- Lift to all floors
- Lease: 125 years from 1989



**For more details or to make an appointment to view, please contact
Mandy Bolwell**

Flat

Approx. 41.5 sq. metres (447.2 sq. feet)

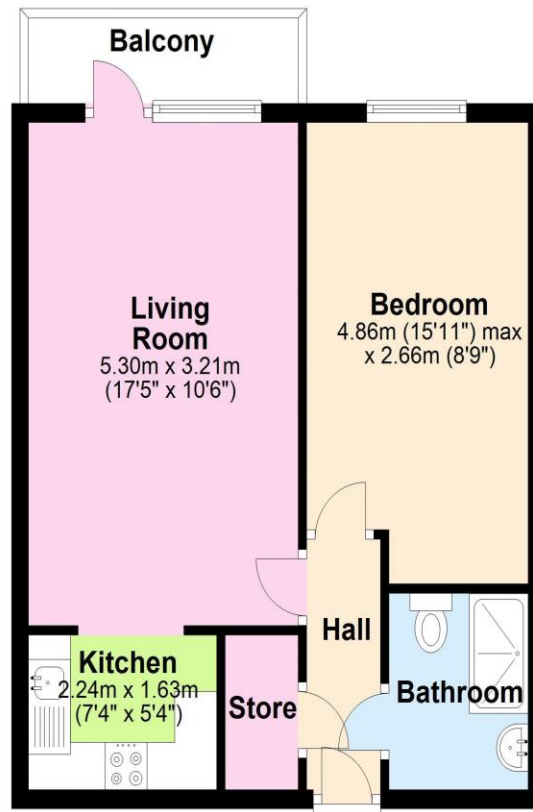

Total area: approx. 41.5 sq. metres (447.2 sq. feet)

This floor plan is for illustrative purposes only and is not to scale. Where measurements are shown, these are approximate and should not be relied upon. Total square area includes the entirety of the property and any outbuildings/garages. Sanitary ware and kitchen fittings are representative only and approximate to actual position, shape and style. No liability is accepted in respect of any consequential loss arising from the use of this plan. Reproduced under licence from Evolve Partnership Limited. All rights reserved.
Plan produced using PlanUp.

| Energy Efficiency Rating | | Current | Potential |
|---|--|-------------------------|-----------|
| Very energy efficient - lower running costs | | | |
| (92-100) A | | | |
| (81-91) B | | | |
| (69-80) C | | 78 | 80 |
| (55-68) D | | | |
| (39-54) E | | | |
| (21-38) F | | | |
| (1-20) G | | | |
| Not energy efficient - higher running costs | | | |
| England, Scotland & Wales | | EU Directive 2002/91/EC | |

For Financial Year Ending:

31/08/2024

Annual Ground Rent:

£589.67

Ground Rent Period Review:

next uplift 2033

Annual Service Charge:

£4074.68

Council Tax Band:

C

Event Fees:

1% Transfer

0% Contingency

Retirement Homesearch, Queensway House, 11 Queensway, New Milton, Hampshire, BH25 5NR
T: 0333 321 4060 F: 0333 321 4065 E: enquiries@retirementhomesearch.co.uk

Retirement Homesearch Limited, Registered Office:
Queensway House, 11 Queensway, New Milton, Hampshire, BH25 5NR
Registered in England No. 3829469



These sales particulars have been prepared as a guide only and any intended purchasers must satisfy themselves by inspection or otherwise as to the correctness of the statements contained therein. The management company have not tested any apparatus, equipment, fittings or services and so cannot verify that they are in working order.