

16 Pheasant Court

Holtsmere Close, Watford, Hertfordshire, WD25 9AF



PRICE: £115,000

Lease: 125 years from 2007

Property Description:

A ONE BEDROOM RETIREMENT APARTMENT SITUATED ON THE FIRST FLOOR Pheasant Court was constructed by McCarthy & Stone (Developments) Ltd in 2008 and comprises 39 properties arranged over 3 floors each served by lift. Situated close to main Superstores, excellent bus links to Watford's town centre together with the M1 and M25 major road links also close by. The Development Manager can be contacted from various points within each property in the case of an emergency. For periods when the Development Manager is off duty there is a 24 hour emergency Appello call system, which is an emergency monitoring centre providing a response 24 hours a day, 365 days a year for periods when the House Manager is off duty. Each property comprises an entrance hall, lounge, kitchen, one or two bedrooms and bathroom. It is a condition of purchase that residents be over the age of 60 years, or in the event of a couple, one must be of the age of 60 years and the other 55

Residents' lounge
Communal Laundry
Lift to All Floors
Minimum Age 60
Communal Gardens

Guest Suite
Development Manager
Price to include carpets, curtains and light fittings
Lease: 125 years from 2007



**For more details or to make an appointment to view, please contact
Mandy Abbott**

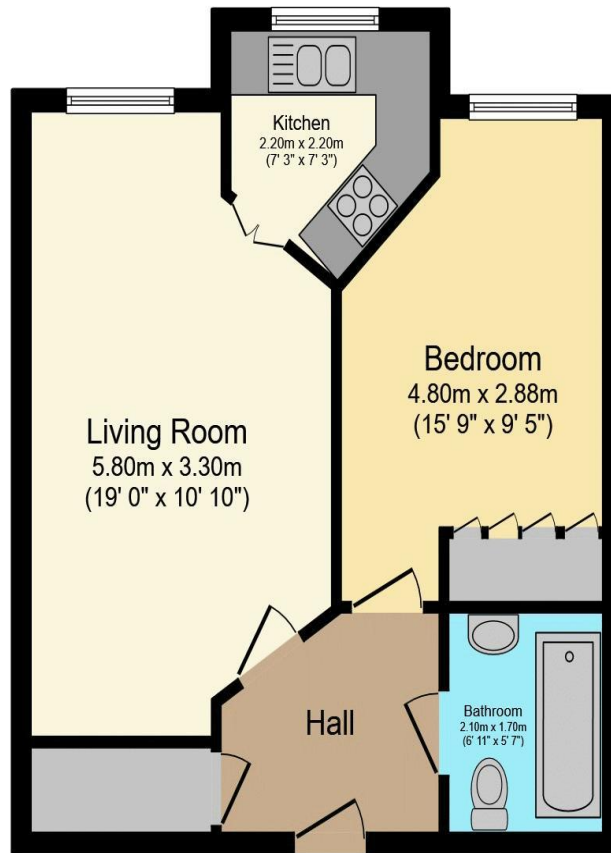

Total floor area 44.2 m² (475 sq.ft.) approx

This floor plan is for illustrative purposes only. It is not drawn to scale. Any measurements, floor areas (including any total floor area), openings and orientation are approximate. No details are guaranteed, they cannot be relied upon for any purpose and they do not form part of any agreement. No liability is taken for any error, omission or misstatement. A party must rely upon its own inspection(s).
Powered by www.focalagent.com

Energy Efficiency Rating		
	Current	Potential
Very energy efficient - lower running costs		
(92+) A		
(81-91) B		
(69-80) C		
(55-68) D		
(39-54) E		
(21-38) F		
(1-20) G		
Not energy efficient - higher running costs		
England & Wales	EU Directive 2002/91/EC	

WWW.EPC4U.COM

For Financial Year Ending:

28/02/25

Annual Ground Rent:

£495.00

Ground Rent Period Review:

Next Uplift 2030

Annual Service Charge:

£3530.52

Council Tax Band:

D

Event Fees:

1% Transfer

1% Contingency

Retirement Homesearch, Queensway House, 11 Queensway, New Milton, Hampshire, BH25 5NR
T: 0333 321 4060 F: 0333 321 4065 E: enquiries@retirementhomesearch.co.uk

Retirement Homesearch Limited, Registered Office:
Queensway House, 11 Queensway, New Milton, Hampshire, BH25 5NR
Registered in England No. 3829469



These sales particulars have been prepared as a guide only and any intended purchasers must satisfy themselves by inspection or otherwise as to the correctness of the statements contained therein. The management company have not tested any apparatus, equipment, fittings or services and so cannot verify that they are in working order.